

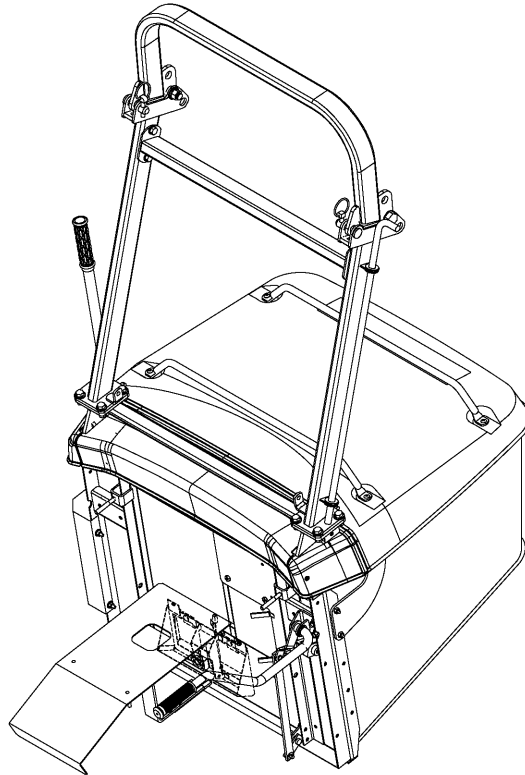

Parts Catalogue



COLLECTOR

SBC402X

SBC402X-RAE4,
RE4

8671-097-230-00

Printed in Japan June,2017

Directions for use of Parts Catalogue

1. Applicable model of machines

All component and option parts used for SBC402X Collector are listed in this parts catalogue.

NOTES: SBC402X-RAE4..... FOR SXG216
 SBC402X-RE4..... FOR SXG216

2. Details of the Structure Table of Model

***** Structure Table of Model *****

| | | | | | | | | | | | |
|-------------|--------|--------|--|--|--|--|--|--|--|--|--|
| | S F | S F | | | | | | | | | |
| M | 3FFF3 | FFF | | | | | | | | | |
| O | 1HHH7 | HHH | | | | | | | | | |
| D | 0UUU0 | UUU | | | | | | | | | |
| E | XXX | XXX | | | | | | | | | |
| L | WWW | WWW | | | | | | | | | |
| E | EEG | EEG | | | | | | | | | |
| L | 46E | 46E | | | | | | | | | |
| L | 4 | 4 | | | | | | | | | |
| FIG. | | | | | | | | | | | |
| 1 | *** | *** | | | | | | | | | |
| 2 | * | * | | | | | | | | | |
| 3 | | *** | | | | | | | | | |
| 4 | *** | | | | | | | | | | |
| 5 | | *** | | | | | | | | | |
| 6 | *** | | | | | | | | | | |
| 7 | *** | *** | | | | | | | | | |
| 8 | * | | | | | | | | | | |

①

③

②

- ① FIG. : Parts structure of the machine is classified by its functions.
 FIG. number corresponds to the number written at the top of the parts illustration.
- ② Model : Shows the name of the model.
- ③ Structure Table : Shows which functions are originally equipped or can be equipped afterwards for each machines

- `*` Standard Parts
- `T` Optional Parts
- `R` Repair Parts (parts which can only be used for repairs)

3. Explanation for head paragraph

| KEY | PART CODE | DESCRIPTION | S P C | TYPE OF MODEL | | | | | | I T C | C O L | G R P | REMARKS |
|-----|-----------------|-------------|-------------|---------------|--------|--------|--------|--------|--------|-------------|-------------|-------------|---------|
| | | | | SSM48M | SSM48F | SSM48G | SRM48M | SRM48F | SRM48G | | | | |
| 1 | 8595-211-001-20 | CASE/UPPER | * | 1 -229 | | | | | | | | | |
| 1A | 8657-201-081-00 | CASE/UPPER | * | 1 230- | | | 1 | | | | | | |
| 2 | 8595-211-002-10 | CASE/LOWER | * | 1 | | | 1 | | | | | | |
| 3 | V523-100-801-80 | PIN | * | 2 | | | 2 | | | | | | |
| 4 | V211-260-803-00 | BOLT, SEMS | * | 6 | | | 6 | | | | | | |
| | | | * | 2 -229 | | | | | | | | | |
| | | | * | 2 230- | | | 2 | | | | | | |
| | | | * | 2 | | | 2 | | | | | | |
| | | | * | 1 | | | 1 | | | | | | |

- ① KEY shows the location of parts diagramed in the illustration.
 - ② Parts numbers begin with `V` and `W` are standard parts of the market.
 - ③ `LH` and `RH` on the parts name are described against the moving direction of the machine or are described on the condition how to install parts on the machines.
 - ④ SPC : The following symbol classifies parts to be used for machines.
 - `*` means standard parts.
 - `T` shows that the parts can be installed as optional parts.
 - `R` shows that the parts can be used as applicable parts to replace originally equipped parts.
 - ⑤ Upper column : QTY shows the number of parts to be used for one unit of machine.
 - `M` is indicated for parts supplied by a meter long.
 - `l` is indicated for parts supplied by liter.
 - `AR` is indicated for parts need to be adjusted or regulated.
- Lower column : serial number
- 229 means serial number up to 229.
 - 230- means serial number 230 and after.

⑥ ITC : Interchangeability

① ...OLD ← NEW

New parts can be used in place of the old parts.

② ...OLD → NEW

Old parts can be used in place of the new parts.

③ ...OLD ↔ NEW

Old parts and new parts can not be replaced each other.

⑦ COL : Color code

Color is signified with color code number for colored parts.

Please see the color list shown in the next page.

⑧ GRP : Parts shown in this column can be replaced by SET parts.

Example : Parts marked ① can be replaced by parts marked ②, and ④ for ③, so the rest follow in the same alphabetical order.

⑨ Remarks

* Other maker's part code number is shown in this column.

* When Fig. No. is shown in the Remark column of SET parts or ASSY parts, each of their component parts are listed in said Fig. No.

4. Color :

The following colors are used color parts.

| COLOR CODE | COLOR | SPRAY TYPE PARTS CODE | PAINTS 4K DRUM PARTS CODE | PAINTS 16K DRUM PARTS CODE |
|------------|--------------|-----------------------|---------------------------|----------------------------|
| 7 F | MIRROR BLACK | 1300-954-001-20 | 1300-954-003-00 | 1300-954-004-00 |

NOTE : Color code is signified only for the parts assigned by the maker as color parts.

5. Serial Numbers :

For chassis serial number is shown on the LABEL.

Please see



6. Parts Order

- 1) When you order parts, please make sure of correct numbers.
- 2) When substitute parts is available, the part number ordered will be automatically turned to a new part number.
- 3) Please be sure to use “ISEKI GENUINE PARTS” .
Any other similar parts other than ISEKI parts when used may cause a trouble that makes us unable to repair or guarantee the warrant.

(EXCEPT A TYPE)

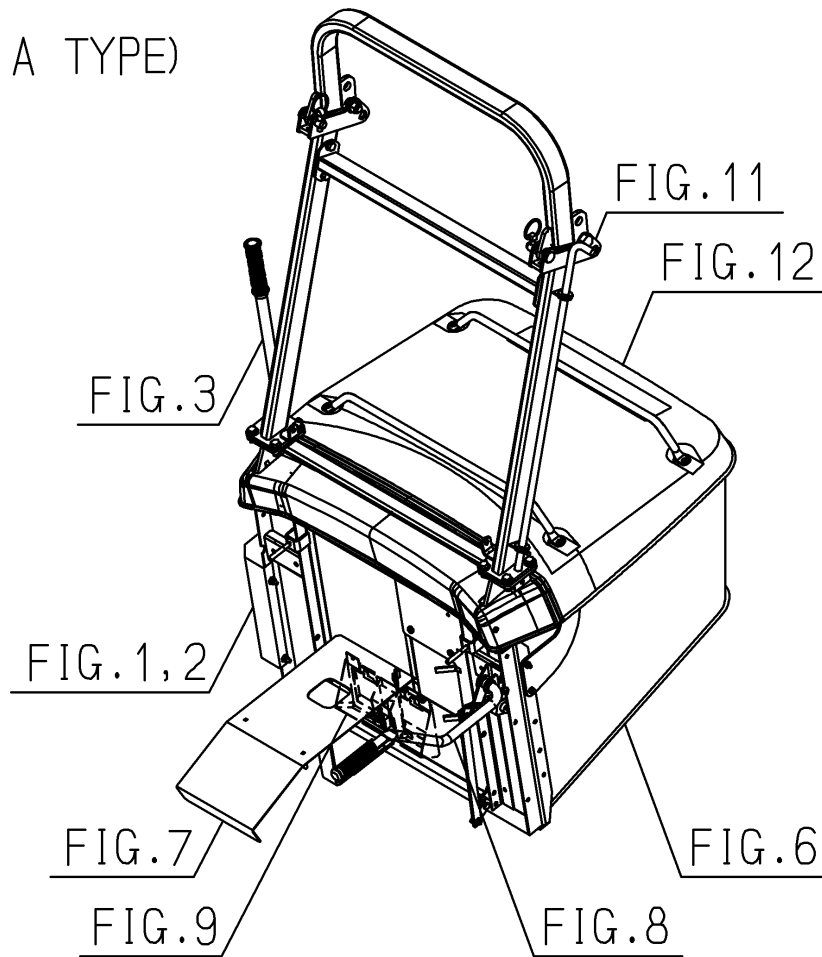

(A TYPE)

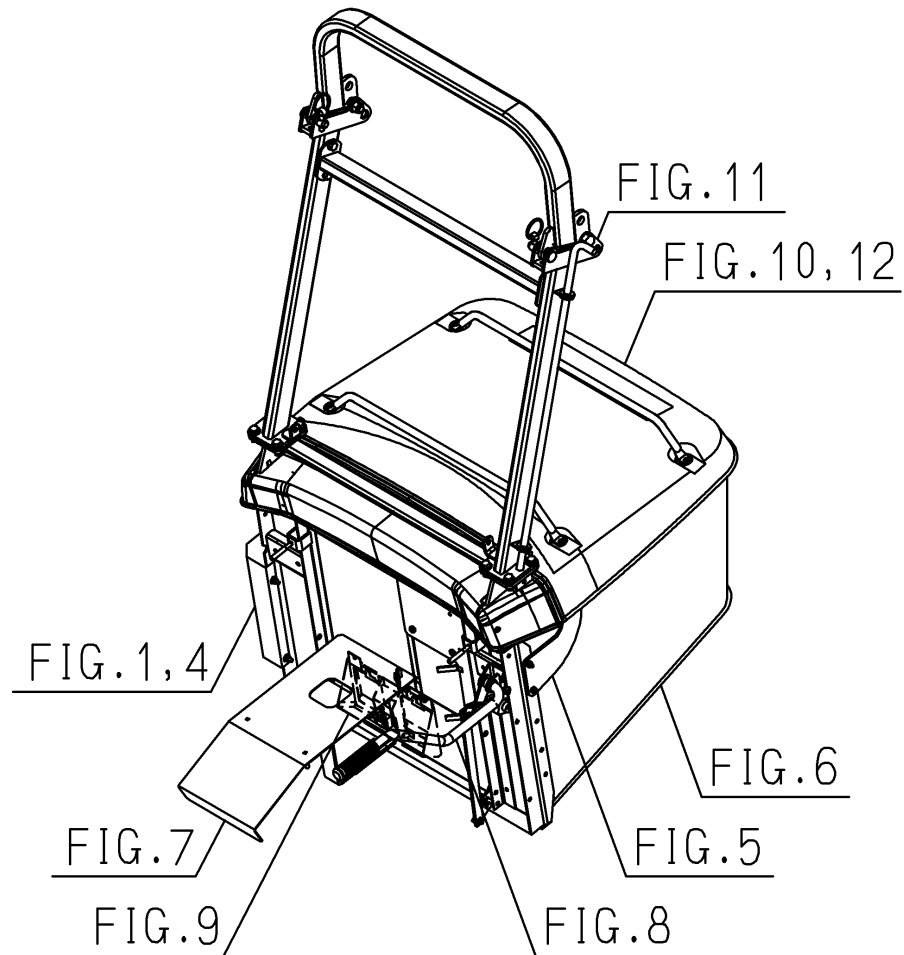

Contents

SBC402XR

| | |
|---------------------------------|---------|
| FRAME SYSTEM..... | Fig. 1 |
| LOCK SYSTEM(EXCEPT A TYPE)..... | Fig. 2 |
| LIFT SYSTEM(EXCEPT A TYPE)..... | Fig. 3 |
| LOCK SYSYTEM(A TYPE)..... | Fig. 4 |
| LIFT SYSTEM(A TYPE)..... | Fig. 5 |
| CONTAINER SYSTEM..... | Fig. 6 |
| CLEANER SYSTEM..... | Fig. 7 |
| LEVER(CLEANER)SYSTEM..... | Fig. 8 |
| SENSOR SYSTEM..... | Fig. 9 |
| HARNESSE SYSTEM(A TYPE)..... | Fig. 10 |
| ROPS SYSTEM..... | Fig. 11 |
| COVER(CONTAINER)SYSTEM..... | Fig. 12 |
| LABEL(CE)..... | Fig. 13 |
| ORNAMENT&LABEL | |
| (CAUTION)(EXCEPT A TYPE)..... | Fig. 14 |
| LABEL(ROPS)..... | Fig. 15 |
| ORNAMENT&LABEL | |
| (CAUTION)(A TYPE)..... | Fig. 16 |

OPTIONAL PARTS

| | |
|----------------------------|---------|
| DEFRECTOR SET(OPTION)..... | Fig. 17 |
|----------------------------|---------|

Numerical Index

8671-097-230-00

| Part Code | Fig. Key | Part Code | Fig. Key | Part Code | Fig. Key |
|-----------------|----------|-----------------|----------|-----------------|----------|
| 1118-606-002-10 | 6 12 | 8671-105-051-10 | 1 13 | 8671-657-700-00 | 10 1 |
| | 6 14 | 8671-105-052-10 | 1 15 | 8671-657-710-00 | 10 5 |
| 1365-121-005-00 | 2 16 | 8671-105-054-00 | 1 11 | 8671-701-001-00 | 17 2 |
| 1376-402-003-00 | 10 6 | 8671-105-440-00 | 2 8 | 8671-701-210-00 | 17 4 |
| 1379-311-002-00 | 8 2 | 8671-105-450-00 | 2 15 | 8671-701-220-00 | 17 7 |
| 1396-404-006-20 | 4 17 | 8671-105-460-00 | 2 19 | 8671-701-230-00 | 17 10 |
| 1560-666-004-00 | 10 7 | 8671-105-470-10 | 2 1 | 8671-701-300-00 | 17 1 |
| 1575-616-005-00 | 11 6 | 8671-105-480-10 | 2 4 | 8671-701-310-00 | 17 11 |
| 1593-901-015-00 | 14 3 | | 4 2 | 8671-701-320-00 | 17 12 |
| | 16 3 | 8671-105-810-00 | 1 1 | 8671-701-810-00 | 11 1 |
| 1614-129-003-00 | 9 6 | 8671-107-051-00 | 3 6 | 8671-701-820-00 | 11 7 |
| 1673-525-002-30 | 11 18 | 8671-107-081-00 | 3 8 | 8671-701-830-00 | 11 11 |
| 1674-904-005-10 | 15 1 | 8671-107-330-20 | 3 1 | 8671-701-840-00 | 11 22 |
| 1690-733-006-00 | 12 6 | 8671-107-340-10 | 3 3 | 8671-705-081-00 | 12 1 |
| 1696-901-005-00 | 17 3 | 8671-107-810-00 | 3 10 | 8671-905-004-00 | 14 7 |
| 1705-606-360-00 | 3 16 | 8671-155-280-10 | 2 3 | 8671-905-005-00 | 14 5 |
| 1716-680-222-00 | 1 8 | | 4 1 | | 16 5 |
| 1716-680-330-10 | 1 7 | 8671-155-320-00 | 4 6 | 8671-905-071-00 | 14 1 |
| 1723-630-051-00 | 3 5 | 8671-155-330-10 | 4 13 | | 16 1 |
| 1726-630-013-00 | 1 2 | 8671-157-001-10 | 5 5 | 8671-905-072-00 | 14 6 |
| | 12 3 | 8671-157-002-10 | 5 6 | 8671-955-001-10 | 16 7 |
| 2145-542-050-00 | 2 18 | 8671-157-007-00 | 5 3 | 8671-955-072-00 | 16 6 |
| 2171-213-002-00 | 3 11 | 8671-157-320-40 | 5 1 | P103-601-005-00 | 9 13 |
| 2173-827-003-10 | 3 4 | 8671-305-054-10 | 12 4 | V120-366-002-00 | 17 15 |
| 2500-901-027-00 | 13 1 | 8671-305-059-00 | 6 13 | V120-376-001-60 | 5 4 |
| 3560-201-015-00 | 3 14 | 8671-305-061-10 | 6 5 | V200-260-501-60 | 10 4 |
| 3642-496-007-10 | 9 5 | 8671-305-081-00 | 12 5 | V201-260-805-00 | 17 5 |
| 3650-380-062-00 | 5 7 | 8671-305-250-10 | 17 17 | | 17 8 |
| 3670-236-003-00 | 17 14 | 8671-305-430-10 | 6 9 | V201-261-003-50 | 11 20 |
| 3805-113-003-00 | 1 10 | 8671-305-460-00 | 6 15 | V201-361-208-50 | 6 3 |
| 4334-143-213-00 | 12 2 | 8671-305-510-00 | 6 1 | V201-461-202-50 | 1 5 |
| 8595-901-005-00 | 14 2 | 8671-305-520-00 | 6 2 | V201-461-203-00 | 11 23 |
| | 16 2 | 8671-305-580-00 | 6 7 | V201-461-203-50 | 11 2 |
| 8596-213-002-10 | 2 11 | 8671-305-590-10 | 6 10 | | 11 8 |
| | 4 9 | 8671-355-260-00 | 17 18 | V210-360-601-60 | 1 9 |
| 8664-156-031-00 | 11 12 | 8671-602-071-00 | 7 2 | | 1 12 |
| 8664-156-032-00 | 11 16 | 8671-602-310-00 | 7 1 | | 9 12 |
| 8664-605-002-10 | 9 7 | 8671-602-710-00 | 7 3 | | 17 13 |
| 8664-605-004-00 | 9 9 | 8671-602-720-00 | 7 6 | V210-660-602-00 | 6 6 |
| 8664-605-005-00 | 9 10 | 8671-603-081-00 | 8 4 | V211-260-802-00 | 6 11 |
| 8664-605-230-00 | 9 4 | 8671-603-810-00 | 8 1 | V211-261-002-50 | 1 4 |
| 8664-905-003-00 | 14 4 | 8671-605-510-00 | 9 2 | | 7 4 |
| | 16 4 | 8671-605-520-00 | 9 1 | V211-360-802-00 | 7 5 |
| 8669-605-001-00 | 9 8 | 8671-605-700-00 | 9 14 | | 7 7 |
| 8671-105-003-10 | 11 5 | 8671-657-003-00 | 10 2 | V304-260-008-00 | 2 14 |

Numerical Index

8671-097-230-00

| Part Code | Fig. Key | Part Code | Fig. Key | Part Code | Fig. Key |
|-----------------|----------|-----------|-----------------|-----------|----------|
| V304-260-008-00 | 2 | 20 | V411-260-016-00 | 11 | 15 |
| | 4 | 12 | V500-161-601-00 | 9 | 11 |
| | 4 | 14 | V500-162-502-00 | 2 | 7 |
| | 17 | 6 | | 2 | 9 |
| | 17 | 9 | | 2 | 17 |
| V304-260-010-00 | 11 | 21 | | 2 | 22 |
| V304-260-012-00 | 6 | 4 | | 3 | 13 |
| V304-260-016-00 | 11 | 13 | | 3 | 15 |
| V360-260-005-00 | 10 | 3 | | 3 | 18 |
| V360-260-006-00 | 6 | 8 | | 4 | 5 |
| | 9 | 3 | | 4 | 8 |
| V361-260-006-00 | 17 | 16 | | 4 | 19 |
| V362-260-008-00 | 1 | 14 | | 5 | 9 |
| | 1 | 16 | | 8 | 6 |
| | 2 | 2 | V580-140-603-20 | 3 | 7 |
| | 2 | 5 | V720-101-900-90 | 11 | 19 |
| | 3 | 2 | V720-112-401-80 | 11 | 17 |
| | 3 | 9 | | | |
| | 4 | 3 | | | |
| | 4 | 15 | | | |
| | 5 | 2 | | | |
| | 5 | 2 | | | |
| V363-260-010-00 | 1 | 3 | | | |
| | 8 | 3 | | | |
| V401-160-008-00 | 2 | 13 | | | |
| | 4 | 11 | | | |
| V401-160-012-00 | 1 | 6 | | | |
| | 11 | 3 | | | |
| | 11 | 9 | | | |
| | 11 | 24 | | | |
| V401-160-016-00 | 11 | 14 | | | |
| V411-260-008-00 | 2 | 12 | | | |
| | 2 | 21 | | | |
| | 3 | 17 | | | |
| | 4 | 10 | | | |
| | 4 | 16 | | | |
| | 4 | 18 | | | |
| | 8 | 5 | | | |
| | 8 | 5 | | | |
| V411-260-010-00 | 3 | 12 | | | |
| V411-260-012-00 | 2 | 6 | | | |
| | 2 | 10 | | | |
| | 4 | 4 | | | |
| | 4 | 7 | | | |
| | 11 | 4 | | | |
| | 11 | 10 | | | |
| V411-260-014-00 | 5 | 8 | | | |

Alphabetical Index

| Description | Fig. Key | Description | Fig. Key | Description | Fig. Key |
|----------------------|----------|----------------------|----------|--------------------|----------|
| ARM | 1 8 | FRAME/CONTANER/RH | 6 2 | NUT/MB | 4 12 |
| BAND | 10 7 | FRAME/LH COMP | 11 1 | | 4 14 |
| BAND, WIRE/140 | 10 6 | FRAME/RH COMP | 11 7 | | 17 6 |
| BAR | 11 5 | FRAME/UPPER COMP | 11 11 | | 17 9 |
| BOLT, S/M10X25 | 1 4 | GRIP | 17 14 | NUT/WASHER/M10 | 1 3 |
| | 7 4 | GRIP, HANDLE | 8 2 | | 8 3 |
| BOLT, S/MBX20 | 6 11 | GRIP/04X12X50 | 3 11 | NUT/WASHER/M5 | 10 3 |
| BOLT, SP/M5X16 | 1 9 | GRIP/CONTAINER/R | 12 5 | NUT/WASHER/M5 | 6 8 |
| | 1 12 | GRIP/HANDLE | 3 4 | | 9 3 |
| | 9 12 | GROMMET/17X21X3 | 11 6 | NUT/WASHER/M5 | 1 14 |
| | 17 13 | GROMMET/25X30X03 | 3 5 | | 1 16 |
| BOLT, SP/M5X20/7T | 6 6 | GROMMET/27X34X03 | 1 10 | | 2 2 |
| BOLT, SP/M5X20 | 7 5 | HARNESS/COLLECTOR | 9 14 | | 2 5 |
| | 7 7 | HARNESS/CYLINDE ASSY | 10 1 | | 3 2 |
| BOLT/KNOB/M06X20 | 9 10 | HOLDER/ROD | 9 13 | | 3 9 |
| BOLT/M10X35 | 11 20 | HUB/CLEANER COMP | 7 6 | | 4 3 |
| BOLT/M12X25/9T | 1 5 | INSULATOR/10X10X720 | 12 2 | | 4 15 |
| BOLT/M12X30/9T | 11 23 | INSULATOR/40X150 | 7 2 | | 5 2 |
| BOLT/M12X35/9T | 11 2 | LABEL | 14 7 | O- RING/1A, P9 | 11 19 |
| | 11 8 | LABEL/CAUTION | 14 4 | O- RING/1B, P18 | 11 17 |
| BOLT/M12X85/7T | 6 3 | | 16 4 | ORNAMENT/ISEKI | 17 3 |
| BOLT/M5X16 | 10 4 | LABEL/CE | 13 1 | ORNAMENT/SBC402-2 | 14 1 |
| BOLT/M5X50 | 17 5 | LABEL/CONTAINER/LAE | 16 6 | | 16 1 |
| | 17 8 | LABEL/CONTAINER/LE | 14 6 | PIN COMP | 7 3 |
| BOLT/SET/M16X64 | 11 12 | LABEL/DANGER/DISCHAR | 14 2 | PIN(JOINT) | 2 11 |
| BRACKET/LOCK/RH COMP | 2 3 | | 16 2 | | 4 9 |
| | 4 1 | LABEL/LIFT | 16 7 | PIN, SPLIT/1. 6X10 | 9 11 |
| CLOTH/COLLECTOR COMP | 6 15 | LABEL/MAINTENANCE | 14 3 | PIN, SPLIT/2. 5X20 | 2 7 |
| COLLAR/26X32X15 | 3 6 | | 16 3 | | 2 9 |
| COVER/CASE/COUNTER | 1 11 | LABEL/ROPS | 15 1 | | 2 17 |
| COVER/CYLINDER | 5 3 | LABEL/SENSOR | 14 5 | | 2 22 |
| COVER/LINK | 1 15 | | 16 5 | | 3 13 |
| COVER/REAR COMP | 6 7 | LEVER/CLEANER/R COMP | 8 1 | | 3 15 |
| COVER/SUB/A | 12 1 | LEVER/DUMP COMP | 3 3 | | 3 18 |
| COVER/UPPER | 12 4 | LINK/DUMP COMP | 3 1 | | 4 5 |
| CUP/SPRING | 9 7 | LINK/DUMP/A COMP | 5 1 | | 4 8 |
| CYLINDER/PACKAG ASSY | 5 5 | LINK/LOCK COMP | 4 6 | | 4 19 |
| DAMPER/FENDER ASSY | 3 16 | LINKPIN | 11 18 | | 5 9 |
| DEFLECTOR SET | 17 1 | NUT, WASHER/M5 | 17 16 | | 8 6 |
| DEFLECTOR/CENTER | 17 2 | NUT/ADJUST | 9 9 | PIN, SPRING/6X32 W | 3 7 |
| DEFLECTOR/LH COMP | 17 4 | NUT/M10 | 11 21 | PIN/14X83 | 5 6 |
| DEFLECTOR/RH COMP | 17 7 | NUT/M12 | 6 4 | PIN/14X97 | 5 7 |
| FRAME/CENTER COMP | 11 22 | NUT/M16 | 11 13 | PIN/20X66 | 11 16 |
| FRAME/COLLECTOR/R | 1 1 | NUT/MB | 2 14 | PIN/STOPPER/R | 3 8 |
| FRAME/CONTAINER/LH | 6 1 | | 2 20 | PLATE, SW TCH | 9 5 |

Alphabetical Index

8671-097-230-00

| Description | Fig. Key | Description | Fig. Key | Description | Fig. Key |
|-----------------------|----------|----------------|----------|-------------|----------|
| PLATE/ASSIST COMP | 2 1 | WASHER, PL/M4 | 5 8 | | |
| PLATE/CAM COMP | 2 15 | WASHER, PL/M6 | 11 15 | | |
| PLATE/CLEANER COMP | 7 1 | WASHER, PL/M8 | 2 12 | | |
| PLATE/GUIDE COMP | 17 10 | | 2 21 | | |
| PLATE/HOOK COMP | 2 4 | | 3 17 | | |
| | 4 2 | | 4 10 | | |
| PLATE/HOOK/LH COMP | 17 11 | | 4 16 | | |
| PLATE/HOOK/RH COMP | 17 12 | | 4 18 | | |
| PLATE/I/22X412 | 8 4 | | 8 5 | | |
| PLATE/IR/30X95 COMP | 2 8 | WASHER, SP/M2 | 1 6 | | |
| PLATE/LOCK COMP | 17 17 | | 11 3 | | |
| | 17 18 | | 11 9 | | |
| PLATE/SENSOR COMP | 9 2 | | 11 24 | | |
| PLATE/SENSOR/BASE | 9 1 | WASHER, SP/M6 | 11 14 | | |
| PLATE/SPRING | 1 13 | WASHER, SP/M8 | 2 13 | | |
| PLATE/STOPPER/R COMP | 3 10 | | 4 11 | | |
| RELAY/5P ASSY | 10 2 | WASHER/10X20X2 | 2 16 | | |
| RIVET | 1 2 | | | | |
| | 12 3 | | | | |
| ROD/M8X230 COMP | 4 13 | | | | |
| ROD/M8X285 COMP | 2 19 | | | | |
| SCREW, SP/M6X16 | 5 4 | | | | |
| SCREW, SP/M6X20 | 17 15 | | | | |
| SCREW/M3X20 | 9 6 | | | | |
| SCREW/TRUSS/M6X25 | 12 6 | | | | |
| SPRING/HC054 | 4 17 | | | | |
| SPRING/HC064 | 9 8 | | | | |
| SPRING/HE086 | 2 18 | | | | |
| STAY/LH COMP | 6 9 | | | | |
| STAY/RH COMP | 6 10 | | | | |
| SWITCH ASSY | 9 4 | | | | |
| SWITCH/LEVER ASSY | 1 7 | | | | |
| SWITCH/SEESAW SET | 10 5 | | | | |
| TUBE/718 | 6 5 | | | | |
| TUBE/UNDER | 6 13 | | | | |
| U-NUT | 6 12 | | | | |
| | 6 14 | | | | |
| WASHER, BINDING SHAFT | 3 14 | | | | |
| WASHER, PL/M10 | 3 12 | | | | |
| WASHER, PL/M12 | 2 6 | | | | |
| | 2 10 | | | | |
| | 4 4 | | | | |
| | 4 7 | | | | |
| | 11 4 | | | | |
| | 11 10 | | | | |