

GENERAL PURPOSE ENGINE

GXV120

PARTS CATALOGUE

6

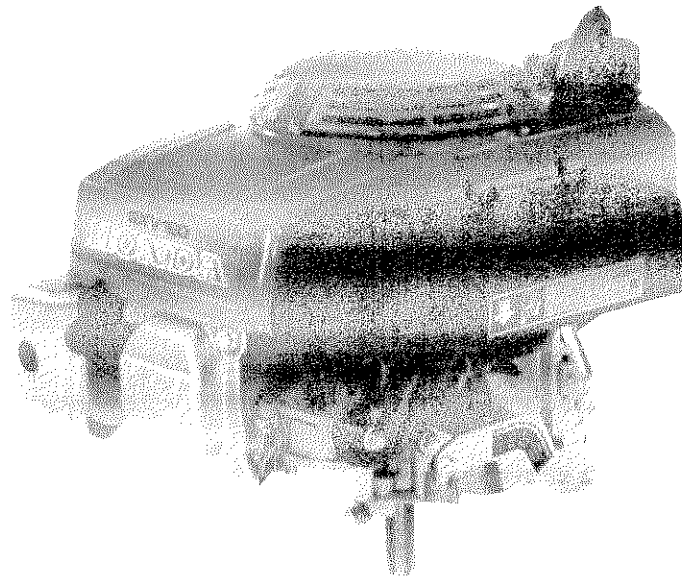

GXV120

FOREWORD INDEX

1

ENGINE GROUP

2

PART NUMBER INDEX

3

PART NAME INDEX

4

Instruction for use of parts catalogue

- This parts catalogue was prepared based on the latest information available as of December 01, 2001.
- See the parts catalogue news for any revision that is made after December 01, 2001.
- Always specify the part number when ordering a part.
- Check the model, type, serial numbers, color, maker, and the size as needed before ordering a part.
- Note that the illustrations (part drawings) can differ from the actual parts in shape. They are given just to help you to refer to the parts.
- When modifications or additions to this parts catalogue are made, a revised edition will be issued at an appropriate time, with successively progressing revision numbers on the cover. We recommend obtaining such revisions in order to keep your parts catalogue up-to-date at all times. To check whether a parts catalogue revision has been issued, please contact your Honda distributor.

Initial version issue date November 01, 1983
Honda Motor Co., Ltd.

CONTENTS

	Page	Address No.
• How to refer to the part information	2	B 2 1
• Part catalogue structure	3	B 3
• When the parts were revised	4	B 4
• Abbreviations used in the parts catalogue.....	4	B 4
• How to check the part block and serial numbers.....	5	B 5
• Models, parts catalogue codes and applicable serial numbers	6	B 6
• Features of each type.....	7	B 7
• Fuel hose, general purpose hoses and vinyl hose.....	9	B 9
• How to use the flat rate time (F.R.T.)	10	B10
• Illustrated index	12	B12
• ENGINE GROUP.....	15	C 1 2
• PART NO. INDEX.....	59	F 1 3
• PART NAME INDEX.....	62	G 1 4

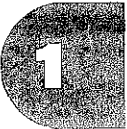

B 2

How to refer to the part information

A Reference with "Illustrated index"

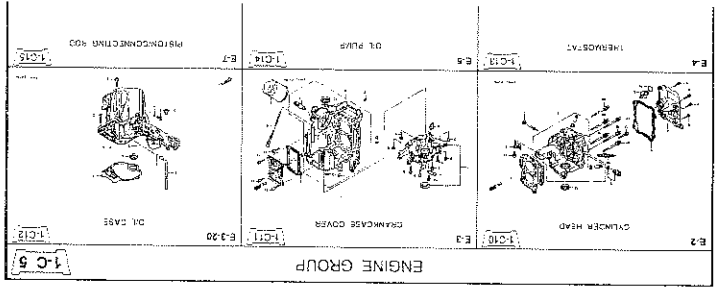

B Reference with "Part number index"

PART NO. INDEX

Part Number	Address	Page	Ref.
06316-2W9-000	1-69	88	1
15220-2W9-003	1-174	34	3C
15212-2W9-000	1-174	3C	3C
11000			
15332-2W9-A30	1-E11	56	3C
15400-FR8-C04	1-E11	27	3C
15422-2W9-000	1-C14	3C	3C
15472-981-000	1-C14	3C	3C
15474-2W9-000	1-C14	3C	3C
15611-921-000	1-C10	24	3C
15655-2W9-000	1-C11	27	3C
11342-2W9-000	1-C11	27	3C
11381-2W9-003	1-C12	29	3C
12000			
16010-2W4-005	1-D4	34	3C
12000-2W9-405A 1-C11	1-D4	27	3C
16013-2W4-000	1-C13	29	3C
16013-2W9-003	1-D4	34	3C
16013-2W9-003	1-D4	34	3C
16016-2W9-000	1-C10	26	3C
16016-2W9-003	1-D4	34	3C
16016-2W9-721	1-D4	34	3C
12209-6W4-681	1-C16	32	3C
12210-2W9-405A 1-C10	1-D4	26	3C
16023-2W9-003	1-D4	34	3C
16024-2W4-650	1-D4	34	3C
16028-2W4-650	1-D4	34	3C
12216-2E2-500	1-E11	36	3C
16028-2W4-650	1-E8	35	3C
12216-2E2-500	1-E8	35	3C

C Reference with "Part name index"

PART NAME INDEX

Part name	Address	Page	Ref.
ABSORBER, FUEL	1-E15	62	3C
ARMATURE COMP., LINK	1-D11	42	3C
ARM COMP., TILT.	1-E15	20	3C
ARM COMP., SHIFT LINK	1-E6	14	3C
ARM COMP., TILT.	1-E15	20	3C
ARM FUEL PUMP ROCKER	1-C16	32	4
ARM REVERSE LOCK	1-F15	29	18
ARM SHIFT LINK	1-D11	32	12
ARM STOPPER	1-E11	24	6
ARM VALVE ROCKER	1-C16	32	3
BAG, TOOL, 160MM	1-E5	84	10
BAND, BUSHING	1-F6	69	1
BAND, TUBE CLIP, 11MM	1-E15	63	20
BAND, TUBE CLIP, 12.5MM	1-C15	63	19
BOLT			

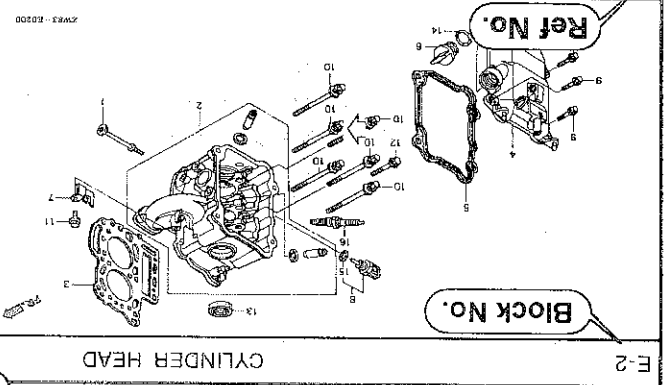

Rel. Part No.	Description	Head Qty	Serial No.	Part catalog code
1	STOPPER, ENGINE SIDE	2	2	12210-2W9-000A
2	HEAD, CYLINDER	2	2	12210-2W9-000A
3	STOPPER, PARK BRAKE	1	1	12210-2W9-000
4	GASKET, CYLINDER HEAD	1	1	12310-2W9-000
5	COVER COMP., HEAD	1	1	12310-2W9-000
6	PACKING, HEAD COVER	1	1	12310-2W9-000
7	HOLDER, CABLE (NO SAUER)	1	1	16617-2W9-010
8	SENSOR ASSY., WATER	1	1	835673-2W9-003
9	TEMPERATURE	1	1	90003-2W9-000
10	BOLT, FLANGE, 6X22	6	6	90007-2W9-003
11	BOLT, FLANGE, 6X14 (C1200)	1	1	90011-2W9-000
12	BOLT, FLANGE, 5X20	2	2	90020-2W9-000
13	OIL SEAL, 20X32X6	1	1	91302-K19-003
14	O-RINGS, 26X2, 7	1	1	91301-803-000
15	O-RING, 9.5X1.5 (CHONJA KAKAKI)	1	1	91307-K12-005
16	PLUG, SPARK (C12E8)	2	2	98059-55926

Page No.

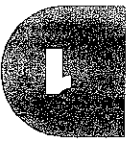

Part catalogue structure

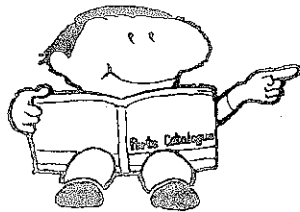

- ① Address number
 - Address No. is provided (in place of the page No.) to help you refer to the part with the part No. or part name.
- ② Block title
- ③ Block number
- ④ Service item/Flat rate time
- ⑤ Reference number
 - Title number marked with the parenthesis or parentheses indicates that it continues from the previous page.
- ⑥ Part number
- ⑦ Honda color code
- ⑧ Description
- ⑨ Assemblies
 - Sections framed with broken lines in the exploded view drawings are available as complete assemblies. (Their individual parts can also be obtained.)
- ⑩ Color description
- ⑪ Note
 - Notes are shown with the parentheses in the part name column.
- ⑫ Required quantity
 - Required QTY shown in the parenthesis or parentheses indicates the optional part.
 - Required QTY marked with "N" Indicates the optional part that should be selected as needed.
 - Required QTY indicates the number of the part used in the block.
- ⑬ Serial number
- ⑭ Type
 - When the type column is blank, it indicates that the part is applicable to all types.
 - As the type of the actual unit may differ from the "parts catalogue, type" please refer to "Models, types and applicable serial numbers" for confirmation.

②

CYLINDER HEAD

④ ①

1-C10

Ref No.	Part No.	Description	Reqd. QTY						Serial No.	Parts catalogue code
			BF	BFP	BF	BFP	BF	BFP		
1	12166-ZW9-000	STOPPER, ENGINE SIDE								
2	12210-ZW9-000ZA	HEAD COMP., CYLINDER	2	2	2	2	2	2		
3	12251-ZW9-003	GASKET, CYLINDER HEAD	1	1	1	1	1	1		
4	12310-ZW9-000	COVER COMP., HEAD	1	1	1	1	1	1		
5	12312-ZW9-000	PACKING, HEAD COVER	1	1	1	1	1	1		
6	15611-921-000	CAP, OIL (NO GAUGE)	1	1	1	1	1	1		
7	16617-ZW9-000	HOLDER, CABLE	1	1	1	1	1	1		
	16617-ZW9-010		1	1	1	1	1	1	SC 96 1001800 LHC, LHD	

Ref No.	Part No.	Description	Reqd. QTY						Serial No.	Parts catalogue code
			BF	BFP	BF	BFP	BF	BFP		
1	12166-ZW9-000	STOPPER, ENGINE SIDE								
2	12210-ZW9-000ZA	HEAD COMP., CYLINDER	2	2	2	2	2	2		
3	12251-ZW9-003	GASKET, CYLINDER HEAD	1	1	1	1	1	1		
4	12310-ZW9-000	COVER COMP., HEAD	1	1	1	1	1	1		
5	12312-ZW9-000	PACKING, HEAD COVER	1	1	1	1	1	1		
6	15611-921-000	CAP, OIL (NO GAUGE)	1	1	1	1	1	1		
7	16617-ZW9-000	HOLDER, CABLE	1	1	1	1	1	1		
	16617-ZW9-010		1	1	1	1	1	1	SC 96 1001800 LHC, LHD	

• The following abbreviations are used in the parts name column.

Abbreviations used in the parts catalogue

A Ampere
 A.C. Alternating current
 ASSY. Assembly
 AT Automatic
 L Left
 L (100L) Link (100 Links)
 IN Inlet
 FR Front
 AMP Ampere
 A Front
 C.D.I. Capacitive discharge
 ignition
 P.T.O. Power take off
 RR Rear
 EX Exhaust
 G.F.C.I. Ground fault circuit
 interruptor
 HEX Hexagonal
 H.S.T. Hydrostatic
 transmission
 W Wait
 V Volt
 T (22T) ... Tooth (22 Teeth)
 STD. Standard
 MT Manual Transmission
 MM Millimeter

COMP. Complete
 D.C. Direct current
 D.C. Complete
 R Right
 RR Rear
 EX Exhaust
 G.F.C.I. Ground fault circuit
 interruptor
 HEX Hexagonal
 H.S.T. Hydrostatic
 transmission
 W Wait
 V Volt
 T (22T) ... Tooth (22 Teeth)
 STD. Standard
 MT Manual Transmission
 MM Millimeter

When the parts were revised

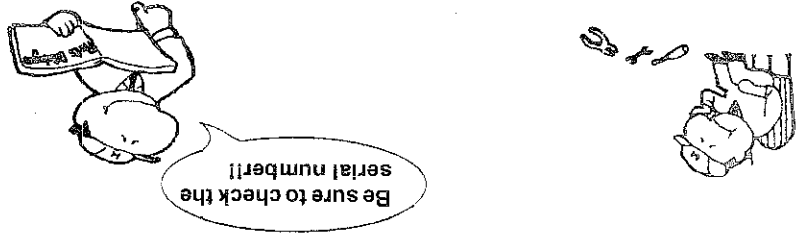

Ref. No.	Part No.	Description	Rqd. QTY	Serial No.
1	12166-ZW9-000	STOPPER, ENGINE SIDE	2	BF BFP BF BFP BF BFP
2	12210-ZW9-000ZA	HEAD COMP., CYLINDER *NH8* DARK GRAY	2	901 901 1001 1001 1001 1001
3	12251-ZW9-003	GASKET, CYLINDER HEAD	1	BF BFP BF BFP BF BFP
4	12310-ZW9-000	COVER COMP., HEAD	1	BF BFP BF BFP BF BFP
5	12312-ZW9-000	PACKING, HEAD COVER	1	BF BFP BF BFP BF BFP
6	15611-921-000	CAP, OIL	1	BF BFP BF BFP BF BFP
7	16617-ZW9-000	HOLDER, CABLE (NO GAUGE)	1	BF BFP BF BFP BF BFP

The number has been used from the initial model without revision.

When shown at the left side, it is applicable to the models of No.1001801 and the subsequent numbers.

When shown at the right side, it is applicable to the models of No.1001801 and the subsequent numbers.

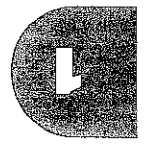
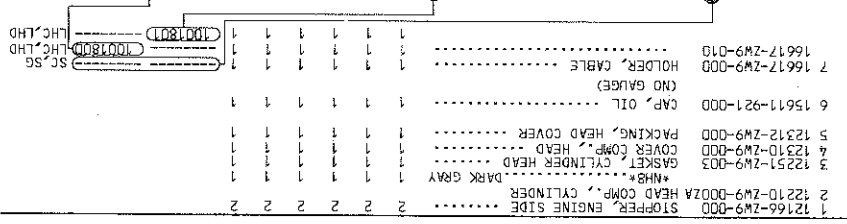

How to check the part block and serial numbers

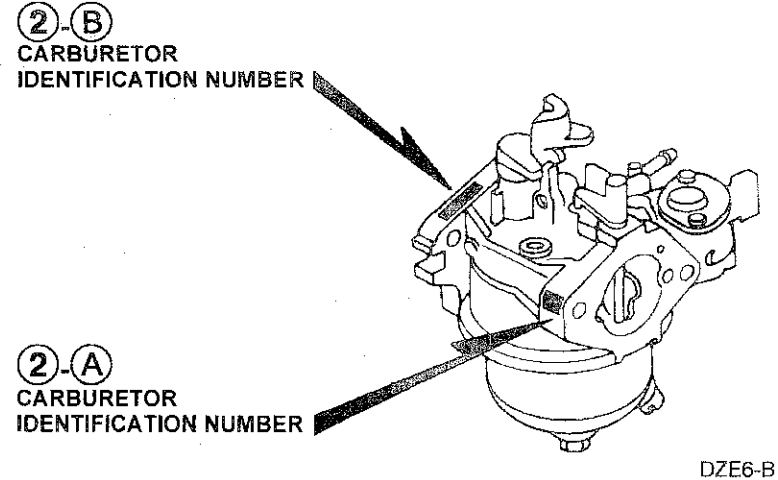
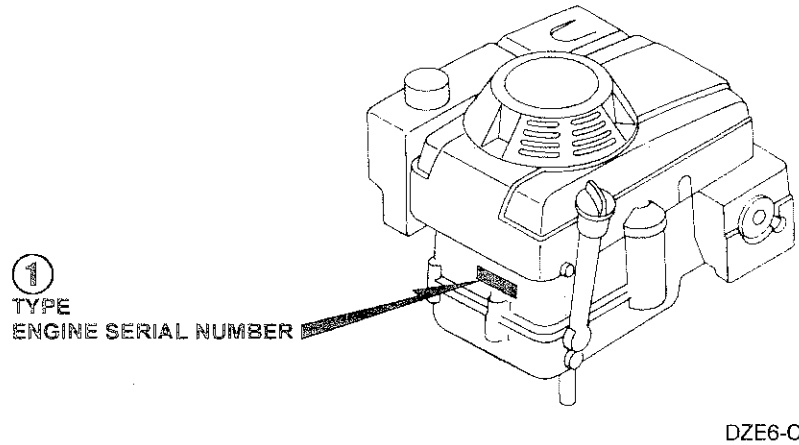
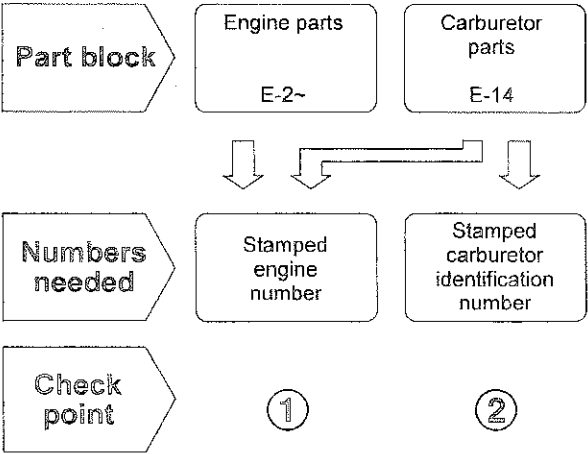

Models, parts catalogue codes and applicable serial numbers

* Models, parts catalogue codes and applicable serial Nos. given in this parts catalogue can be identified as follows.

Model	Type	Parts catalogue type	Applicable engine serial No.	Applicable carburetor identification No.
GXV120 (JAPAN)	A1	A1	1000001~2537192	BE03A A/B/C/G BE03A H/J BE56A B
	A1L	A1L	1000001~	BE03A G/H/J BE56A B
	A1LA	A1LA	1000001~	BE56A B
	A1L2	A1L2	1000001~2537192	BE56A A/B
	A12	A12		
	A14	A14		BE03A H/J BE56A B
	D1	D1		BE03A A/B/C/G BE03A H/J, BE56A B
	D12	D12		BE56A A/B
	NZTA	NZTA		BE03A H/J
	N1	N1		BE03A A/B/C/D/F/G BE56A B
	N1B	N1B		BE03A H/J, BE56A B
	N12	N12		BE56A A/B
	N14	N14		BE03A H/J 1000001~2864559
	N2	N2		BE03A A/B/C/D/F/G 1000001~
	N2CA	N2CA		BE03A G/H/J
N2C1	N2C1		BE03A G/H/J 1000001~	
N2F	N2F		BE56A B GXV120-1000001~	
N2SS	N2SS		BE55A B 1000001~	
N2T	N2T		BE03A G/H/J 1000001~2537192	

Model	Type	Parts catalogue type	Applicable engine serial No.	Applicable carburetor identification No.
GXV120 (JAPAN)	N22	N22		BE56A A/B
	N24	N24	1000001~	BE03A H/J BE56A B
	P	P		
	PF	PF		BE03A H/J
	PFC A	PFC A	1000001~2537192	BE03A G/H/J
	PTH	PTH		BE03A H/J BE56A B
	S	S		
	SF	SF		BE03A H/J
	SFK	SFK		BE55A B
	SFKR	SFKR		BE03A H/J BE55A B, BE55B A
	SFL	SFL		BE03A G/H/J
	SFLY	SFLY		BE03A H/J
	SFL1	SFL1		BE56A B BE03A H/J
	SFS	SFS		BE03A H/J
	SFSK	SFSK		BE03A G/H/J
SFTH	SFTH		BE03A H/J 1000001~	
A1#	A1#		GXV120-1000001~	
D1#	D1#		6000001~6069720	
GXV120 (U.S.A.)				BE03A G

* Of carburetor identification numbers, only the portions underlined in the example below are used for registration.

BE 03A A KC 7

Features of each type

• See the following table for the features of each type.

Specifications		Model	GXV120 (JAPAN)														
		Type	A1	A1L	A1LA	A1L2	A12	A14	D1	D12	NZTA	N1	N1B	N12	N14	N2	N2CA
Crankshaft	137.2 mm Straight		●	●	●	●	●	●	●	●		●	●	●	●		
	118.9 mm Straight										●					●	●
	125 mm Stepped thread																
Starter motor																	
Charge coil																	
Brake			●	●	●	●	●	●									

Specifications		Model	GXV120 (JAPAN)														
		Type	N2C1	N2F	N2SS	N2T	N22	N24	P	PF	PFCA	PFTH	S	SF	SFFK	SFKR	SFL
Crankshaft	137.2 mm Straight																
	118.9 mm Straight		●	●	●	●	●	●				●					
	125 mm Stepped thread								●	●	●		●	●	●	●	●
Starter motor																	
Charge coil																	
Brake			●														

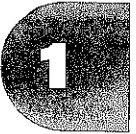

Specifications	Model		Type					
	GXV120 (U.S.A.)	GXV120 (JAPAN)	SFLY	SFL1	SFS	SFSK SFTH	A1#	D1#
Crankshaft	137.2 mm Straight						●	●
	118.9 mm Straight					●		
	125 mm Stepped thread		●	●	●	●		
Starter motor				●	●			
Charge coil				●	●			
Brake							●	

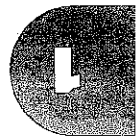
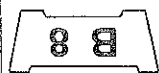

Fuel hose, general purpose hoses and vinyl hose

- The standard part fuel hose, general purpose hose and vinyl hose may be substituted by the coiled bulk part.
- When ordering the standard part fuel hose, general purpose hose and vinyl hose use the bulk part number written in the parts catalog in brackets () underneath the part name.
- When exchanging the hose, cut and use at the specified length as mentioned in the part name.
(For the method of cutting the bulk part, and method of filling out orders etc., please refer to the instructions issued with the bulk part.)

Bulk part number of fuel hose, general purpose hose and vinyl hose.

Example: 9 5 0 0 1 - 7 5 0 0 1 - 5 0 M

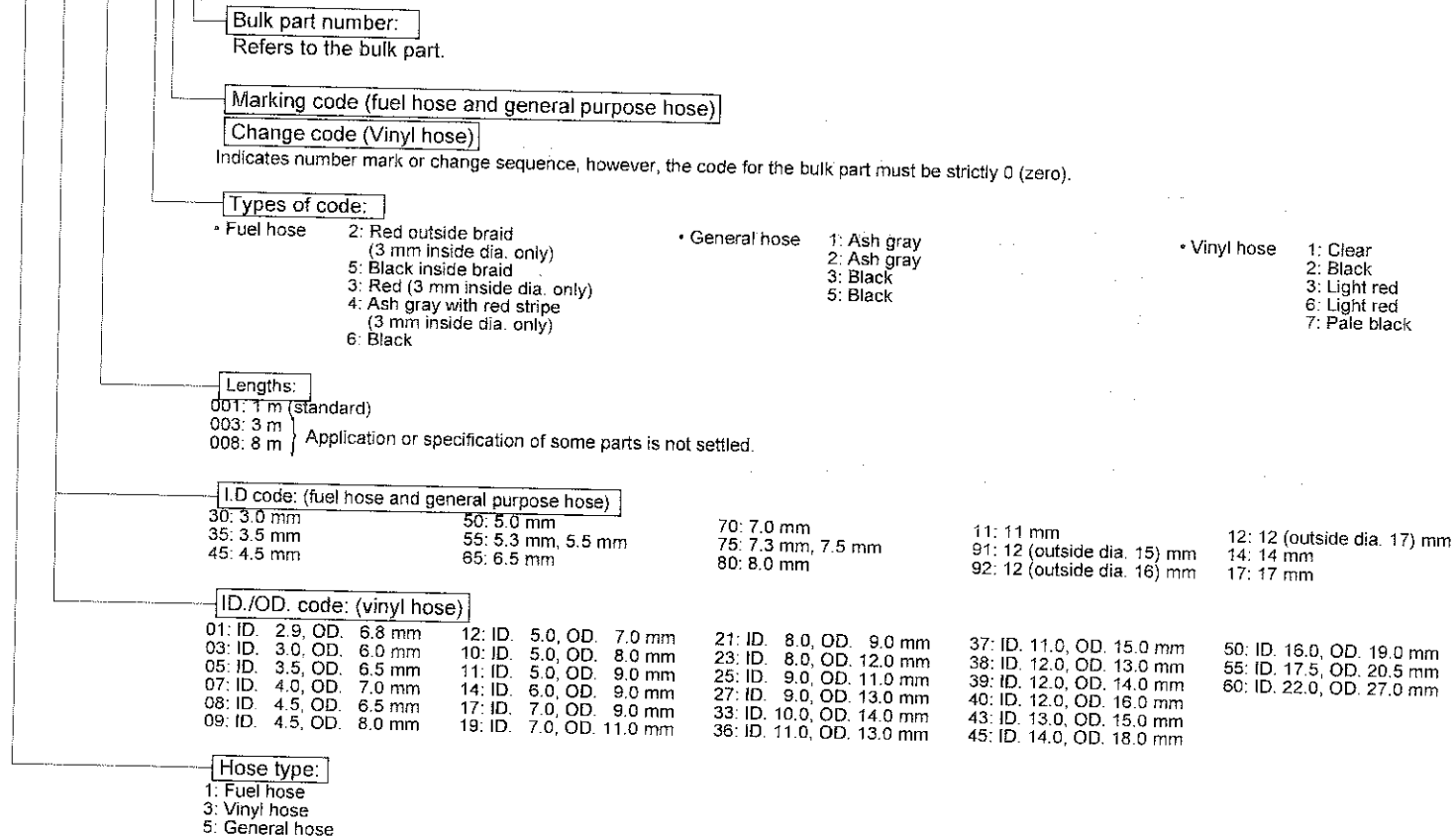

◎ CAUTION: It is DANGEROUS to confuse the fuel hose with the general purpose hose or vinyl hose.

Never use a general purpose hose or vinyl hose in place of a fuel hose or vice versa. Always use the correct bulk part in the parts catalogue, according to the service manual or the instructions issued with the bulk part.

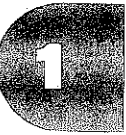

How to use the flat rate time (F.R.T.)

This F.R.T. (Flat Rate Time) is used to determine the standard labor time allowed for replacement of parts covered by the warranty during the period the warranty is in effect. The F.R.T. for those parts which are not listed herein should be determined from the operation closely related to the replacement of that part.

1. The F.R.T. is based on the following servicing conditions
 - a. A liberal allowance is added to the net servicing time.
 - b. Standard times specified are based on the condition that the necessary servicing tools listed in the service manual which describes the Honda service policy are available close at hand and the work performed by a mechanic with normal skill.
 - c. Time required for inspection and operational test following the servicing is included in the F.R.T.
 - d. The F.R.T. for "*" marked parts are same as the F.R.T. for the representative part above.
 - e. The F.R.T. shown with ("") includes engine removal and installation.

CONVERSION CHART			
Hours	Minutes	Hours	Minutes
0.1	6	0.6	36
0.2	12	0.7	42
0.3	18	0.8	48
0.4	24	0.9	54
0.5	30	1.0	60

(Example) 0.3 = 18 minutes
 5.6 = 5 hours and 36 minutes

2. Method of computing
 The job times are listed in tenth of an hour to simplify computation.

3. Computing the F.R.T.

The following are only examples and do not reflect the actual F.R.T. for this product.

When several jobs are performed at the same time, make the calculation in the following manner.

a. Jobs of non duplicated nature

The F.R.T. for the job is obtained by totalling the F.R.T. for each part replaced.

(Example) Replacement of head cover gasket and oil filter.

Service item	F.R.T.
Packing, cylinder head cover	0.5
Cartridge, oil filter	0.5

The F.R.T. for the job is: $0.5 + 0.5 = 1.0$

b. Jobs of duplicated nature

Take the F.R.T. for the last part to be replaced.

(Example) Replacement of piston and cylinder head gasket.

Service item	F.R.T.
Gasket comp., cylinder head	3.0
Piston	*5.0

The F.R.T. for the job is: 5.0

c. Jobs of partially related nature

Total up the F.R.T. for all of the parts replaced and then subtract the F.R.T. for the duplicated operation (i.e., cylinder head gasket service).

(Example) Replacement of valve and cylinder head.

Service item	F.R.T.
Valve	*3.0
Head assy., cylinder	*4.0
Gasket comp., cylinder head	*2.5

The F.R.T. for the job is: $(3.0 + 4.0) - 2.5 = 4.5$

- The F.R.T. shown with (*) includes engine removal and installation.
- The parts, having the same number of man-hour, are identified by a mark "*", and classified under the title of their representative work.

4. Adjustment, cleaning

Item	Service item	F.R.T.
Adjustment	Valve clearance	0.4
	Carburetor	0.2
	Governor	0.2
Cleaning	Carburetor	0.6
	Air cleaner element	0.1
	Arrester spark	0.2
	Spark plug	0.1

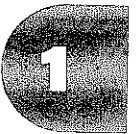

ENGINE GROUP

B12

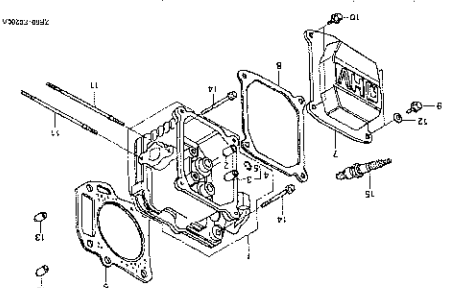
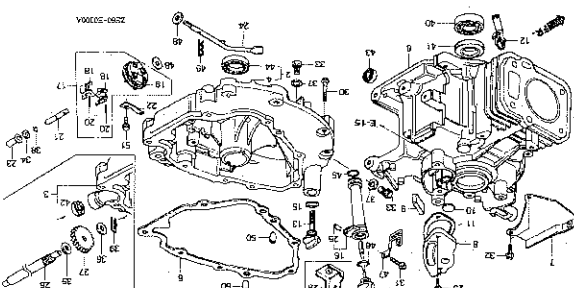
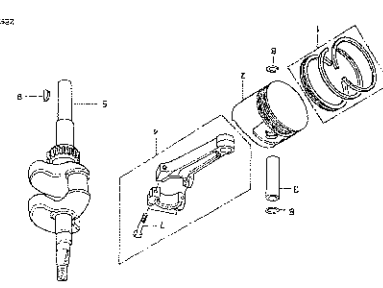
 <p>CYLINDER HEAD</p> <p>E-2</p> <p>C 1</p> <p>E-3</p>	 <p>CYLINDER BARREL/OIL PAN</p> <p>E-4</p> <p>C 4</p> <p>E-8</p>	 <p>CRANKSHAFT/PISTON</p> <p>C 8</p> <p>E-8</p>
---	--	--

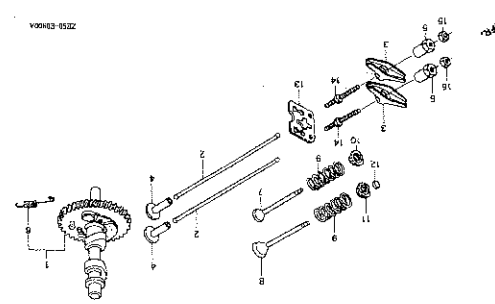
 <p>CAMSHAFT</p> <p>E-9</p> <p>C11</p> <p>E-11</p>

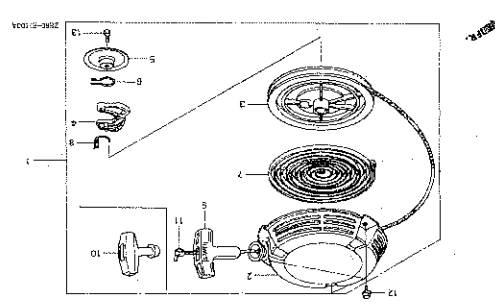
 <p>RECOIL STARTER</p> <p>C14</p> <p>E-11</p>

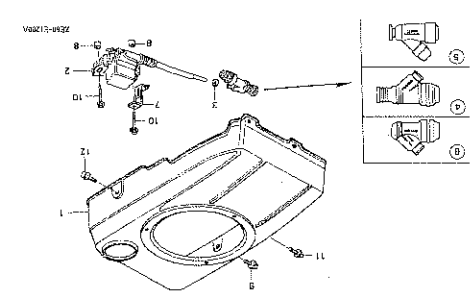
 <p>FAN COVER/IGNITION COIL</p> <p>C16</p> <p>E-12</p>

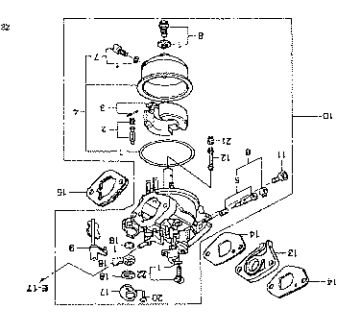
 <p>CARBURETOR</p> <p>E-14</p> <p>D 2</p> <p>E-15</p>
--

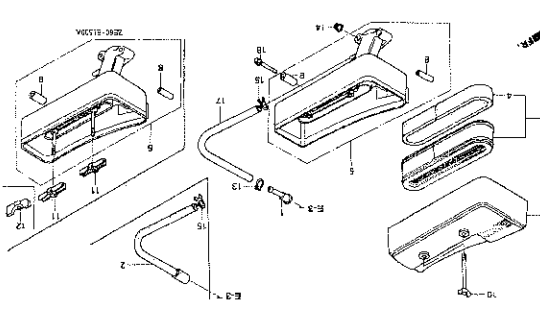
 <p>AIR CLEANER</p> <p>E-15</p> <p>D 6</p> <p>E-16</p>
--

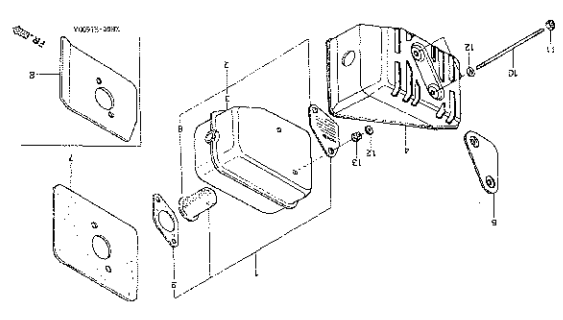
 <p>MUFFLER</p> <p>E-16</p> <p>D 8</p>



ENGINE GROUP

B13

E-17

FUEL TANK

D10

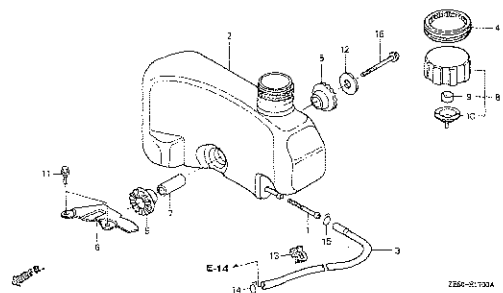

E-19

FLYWHEEL

D12

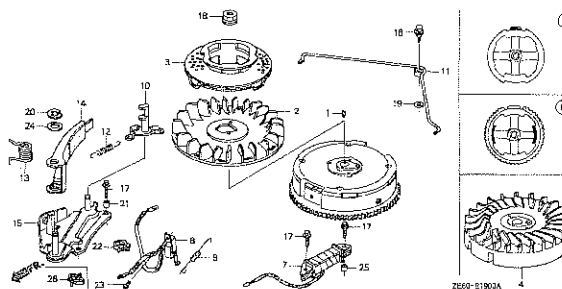

E-21

STARTER MOTOR

D14

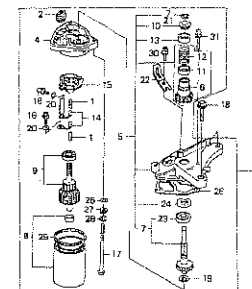

E-22

CONTROL

D16

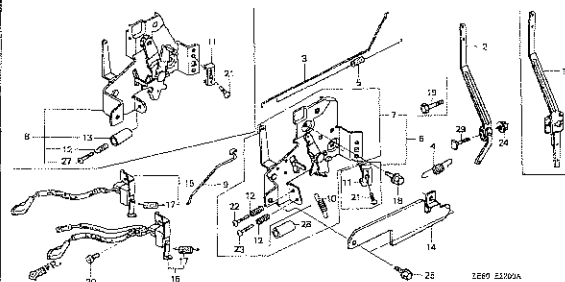

E-28

LABELS

E 3

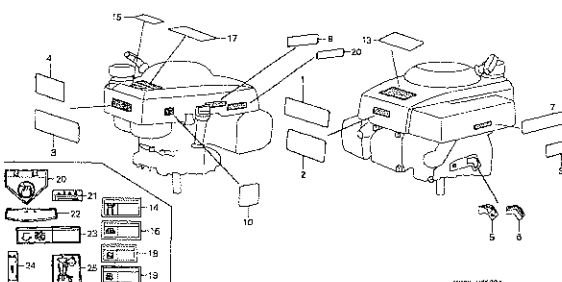

E-40

DRIVE SPROCKET

E 5

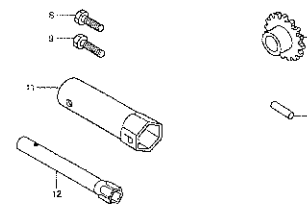

E-40-1

SWITCH

E 6

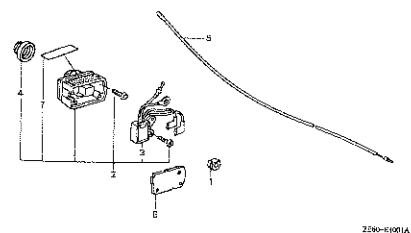

E-40-2

BRAKE

E 7

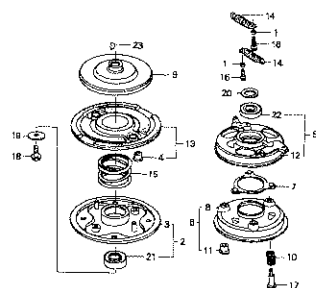

E-40-3

THROTTLE LEVER

E 8

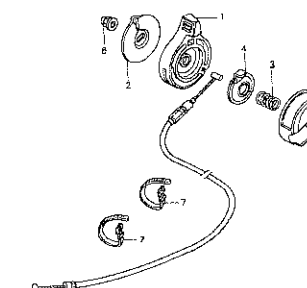

ENGINE GROUP

B14

E-40-4

TRANSMISSION CASE

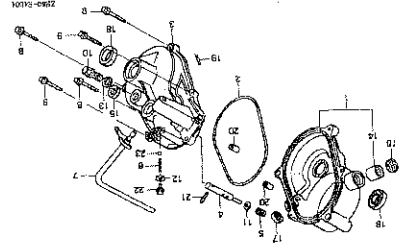

E 9

E-40-5

JOINT

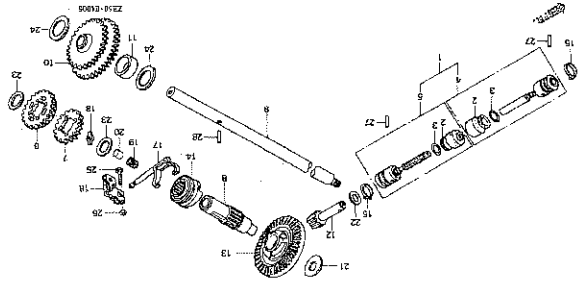

E10

EOP-1

GASKET KIT

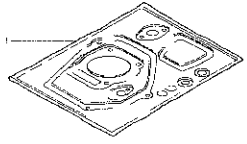

E12

HEMD-K5003



CYLINDER HEAD

C 1

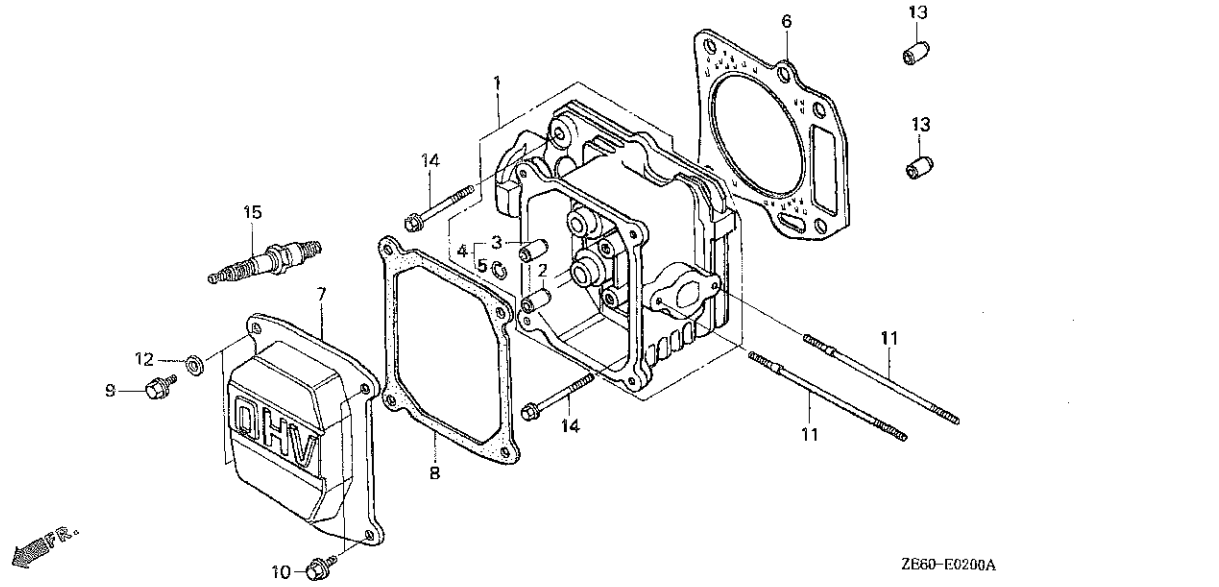

Service item	F.R.T.
COVER, HEAD	0.1
PLUG, SPARK	
BOLT, STUD, 6X109	0.2
(ADD 0.1 FOR EACH.)	
GASKET, CYLINDER HEAD	0.6
GUIDE, IN. VALVE	0.8
(ADD 0.2 FOR EACH.)	
HEAD COMP., CYLINDER	1.0

Ref. No.	Part No.	Description	Reqd. QTY		Serial No.	Parts catalogue code
			GXV 120 (JPN)	GXV 120 (USA)		
1	122A0-ZE6-000	HEAD COMP., CYLINDER	1	-	1163730 A1,D1,N1,N2	
	122A0-ZE6-010	1	-	1231802 A1,D1,N1,N2	
	122A0-ZE6-030	1	-	N1B,N2CA,N2F,N2T,SFL,SFSK	
			1	-	2551344 A1L,N2C1	
			1	-	1231803 2551344 A1,D1,N1,N2	
	12200-ZE6-040	1	-	A1L2,N12,N2T,N22,N24,P,PF,PFCA,S,SF,SFS,SFTH	
	12200-ZE6-050	1	-	2551345 2551344 A1LA,A12,A14,D12,NZTA,N14,N2SS,PFTH,SFFK,SFKR,SFL,SFLY,SFL1	
			1	-	2551345 A1,A1L,A1LA,A12,A14,D1,D12,NZTA,N1,N14,N2,N2C1,N2SS,PFTH,SFFK,SFKR,SFL,SFLY,SFL1	
	12200-ZE6-100	HEAD COMP., CYLINDER (USA) ..	-	1		
2	12204-ZE1-305	GUIDE, IN. VALVE (O.S.)	(1)	-	2416541 A1,A1L,D1,N1,N2,N2CA,N2T,SFL,SFSK	
			-	(1)		
	12204-ZE1-306	(1)	-	A1LA,A1L2,A12,A14,D12,NZTA,N1B,N12,N14,N2C1,N2F,N2SS,N22,N24,P,PF,PFCA,PFTH,S,SF,SFFK,SFKR,SFLY,SFL1,SFS,SFTH	
			(1)	-	2416542 A1,A1L,D1,N1,N2,N2CA,N2T,SFL,SFSK	
3	12205-ZE1-305	GUIDE, EX. VALVE (O.S.)	(1)	-	1231802 A1,D1,N1,N2	
4	12205-ZE1-315	GUIDE, EX. VALVE (O.S.)	(1)	-	A1L,A1LA,A1L2,A12,A14,D12,NZTA,N1B,N12,N14,N2CA,N2C1,N2F,N2SS,N2T,N22,N24,P,PF,PFCA,PFTH,S,SF,SFFK,SFKR,SFL,SFLY,SFL1,SFS,SFSK,SFTH	
			(1)	-	1231803 A1,D1,N1,N2	
			-	(1)		
5	12216-ZE5-300	CLIP, VALVE GUIDE	1	1		
6	12251-ZE6-000	GASKET, CYLINDER HEAD	1	1		
7	12310-ZE6-000	COVER, HEAD	1	-	1616955 A1,D1,N1,N2	
	12310-ZE7-000	1	-	A1L,A1LA,A1L2,A12,A14,D12,NZTA,N1B,N12,N14,N2CA,N2C1,N2F,N2SS,N2T,N22,N24,P,PF,PFCA,PFTH,S,SF,SFFK,SFKR,SFL,SFLY,SFL1,SFS,SFSK,SFTH	
			1	-	1616956 A1,D1,N1,N2	
			-	1		
8	12391-ZE6-000	PACKING, HEAD COVER	1	-	1616955 A1,D1,N1,N2	





CYLINDER HEAD

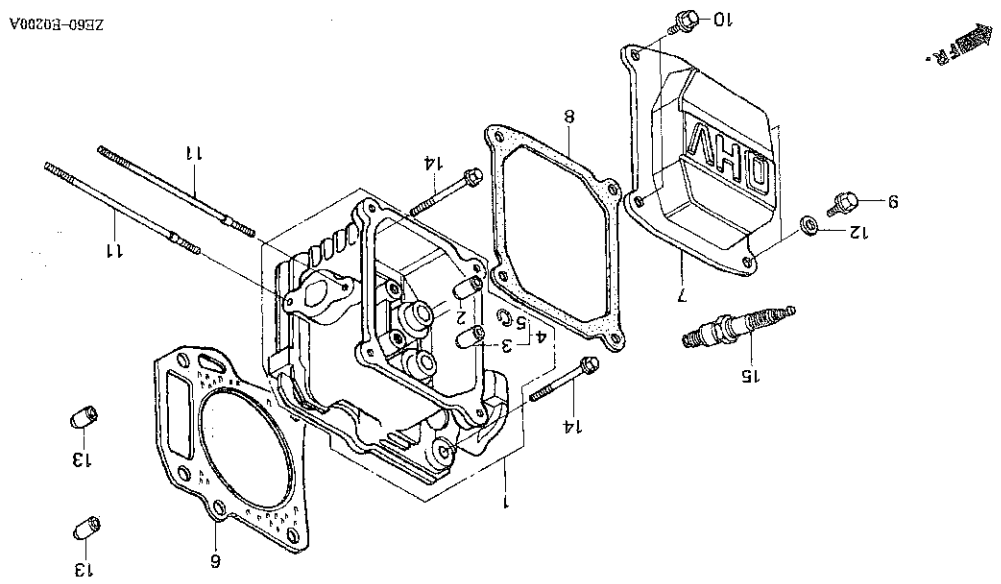

ZB60-E0200A

Ref. No.	Part No.	Description	Reqd. QTY	Serial No.	Parts catalogue code
(8)	12391-ZE7-000	PACKING, HEAD COVER	1	2453828 A1,D1,N1,N2	1616956
			1	A1L,A1L2,A12,A14,D12,N2TA,N12,N14,N2SS,N22,N24,P,PF,PFCA,PFTH,S,SF	
9	90014-952-000	BOLT, FLANGE, 6X14 (C1200)	2	A1,A1L,D1,N1,N1B,N2,N2CA,N2C1,N2F,N2T,SFL,SFSK	2453829
			2	A1,A1L,D1,N1,N1B,N2,N2CA,N2C1,N2F,N2T,SFL,SFSK	
10	90016-ZE1-T00	BOLT, FLANGE, 6X13	2	A1L,A1L2,A12,A14,D12,N2TA,N12,N14,N2SS,N22,N24,P,PF,PFCA,PFTH,S,SF	2460984
			2	A1L,A1L2,A12,A14,D12,N2TA,N12,N14,N2SS,N22,N24,P,PF,PFCA,PFTH,S,SF	
	90013-883-000	BOLT, FLANGE, 6X12 (C1200)	2	A1,A1L,D1,N1,N1B,N2,N2CA,N2C1,N2F,N2T,SFL,SFSK	2460985
			2	A1,A1L,D1,N1,N1B,N2,N2CA,N2C1,N2F,N2T,SFL,SFSK	
11	90045-ZE1-000	BOLT, STUD, 6X109	2	1163730 A1,D1,N1,N2	2487652 A1L
			2	2487652 A1L	
	90045-ZE1-020	BOLT, STUD, 6X112	2	2488068 N1B,N2CA,N2C1,N2F,N2T,PFCA,SFL,SFSK	1163731
			2	2488068 N1,N2	
	90043-ZE6-000	BOLT, STUD, 6X109	2	A1L,A14,N2TA,N14,N2SS,N24,P,PF,PFTH,S,SF,SFFK,SFKR,SFLY,SFL1,SFS	2487653
			2	A1L2,A12,D12,N12,N22	
	90043-ZE6-T00	BOLT, STUD, 6X97	2	2487653	2487653
			2	A1,A1L,D1	
	12 90474-704-000	WASHER, 6X17	2	1163730 N1,N2	A1,D1
			2	1163730 N1,N2	

CYLINDER HEAD

Ref. No.	Part No.	Description	Reqd. QTY		Serial No.	Parts catalogue code
			GXV 120 (JPN)	GXV 120 (USA)		
13	94301-10160	DOWEL PIN, 10X16	2	2		
14	95700-08045-00	BOLT, FLANGE, 8X45	4	-	-----	N1,N1B,N2
	95700-08050-00	BOLT, FLANGE, 8X50	-	4	-----	
	95701-08045-00	BOLT, FLANGE, 8X45	4	-	-----	A1,A1L,A1LA,A1L2,A12,A14,D1,D12,NZTA,N12,N14,N2CA,N2C1,N2F,N2SS,N2T,N22,N24,P,PF,PFCA,PFTH,S,SF,SFFK,SFKR,SFL,SFLY,SFL1,SFS,SFSK,SFTH
15	98079-54841	PLUG, SPARK (BP4ES) (NGK)	(1)	-	-----	P,S
	98079-54846	PLUG, SPARK (BPR4ES) (NGK)	(1)	-	-----	A1,A1L,A1LA,A1L2,A12,A14,D1,D12,NZTA,N1,N1B,N12,N14,N2,N2CA,N2C1,N2F,N2SS,N2T,N22,N24,PF,PFCA,PFTH,SF,SFFK,SFKR,SFL,SFLY,SFL1,SFS,SFSK,SFTH
			-	(1)		
	98079-54854	PLUG, SPARK (W14EP-U) (DENSO)	(1)	-	-----	P,S
	98079-54855	PLUG, SPARK (W14EPR-U) (DENSO)	(1)	-	-----	A1,A1L,A1LA,A1L2,A12,A14,D1,D12,NZTA,N1,N1B,N12,N14,N2,N2CA,N2C1,N2F,N2SS,N2T,N22,N24,PF,PFCA,PFTH,SF,SFFK,SFKR,SFL,SFLY,SFL1,SFS,SFSK,SFTH
			-	(1)		
	98079-55841	PLUG, SPARK (BP5ES) (NGK)	1	-	-----	N1,N2,N2T,P,S
	98079-55846	PLUG, SPARK (BPR5ES) (NGK)	1	-	-----	A1,A1L,A1LA,A1L2,A12,A14,D1,D12,NZTA,N1B,N12,N14,N2CA,N2C1,N2F,N2SS,N22,N24,PF,PFCA,PFTH,SF,SFFK,SFKR,SFL,SFLY,SFL1,SFS,SFSK,SFTH
			-	1		
	98079-55854	PLUG, SPARK (W16EP-U) (DENSO)	1	-	-----	N1,N1B,N2,N2T,P,S
	98079-55855	PLUG, SPARK (W16EPR-U) (DENSO)	1	-	-----	A1,A1L,A1LA,A1L2,A12,A14,D1,D12,NZTA,N1B,N12,N14,N2CA,N2C1,N2F,N2SS,N22,N24,PF,PFCA,PFTH,SF,SFFK,SFKR,SFL,SFLY,SFL1,SFS,SFSK,SFTH
			-	1		
	98079-56841	PLUG, SPARK (BP6ES) (NGK)	(1)	-	-----	P,S
	98079-56846	PLUG, SPARK (BPR6ES) (NGK)	(1)	-	-----	A1,A1L,A1LA,A1L2,A12,A14,D1,D12,NZTA,N1,N1B,N12,N14,N2,N2CA,N2C1,N2F,N2SS,N2T,N22,N24,PF,PFCA,PFTH,SF,SFFK,SFKR,SFL,SFLY,SFL1,SFS,SFSK,SFTH
			-	(1)		
	98079-56854	PLUG, SPARK (W20EP-U) (DENSO)	(1)	-	-----	P,S
	98079-56855	PLUG, SPARK (W20EPR-U) (DENSO)	(1)	-	-----	A1,A1L,A1LA,A1L2,A12,A14,D1,D12,NZTA,N1,N1B,N12,N14,N2,N2CA,N2C1,N2F,N2SS,N2T,N22,N24,PF,PFCA,PFTH,SF,SFFK,SFKR,SFL,SFLY,SFL1,SFS,SFSK,SFTH
			-	(1)		





Ref. No.	Part No.	Description	Reqd. QTY	Serial No.	Parts catalogue code
2	11300-ZE6-640	PAN ASSY, OIL	1	1806078	2195321 A1,D1,N1,N2
	11300-ZE6-010		1		P,PF,PFGA,PFTH
	11300-ZE6-641		1		A1L,A1LA,A1L2,A12,A14,D12,N2TA,N1B,N12,N14,N2CA,N2C1,N2F,N2SS,N2T,N2Z
	11300-ZE6-150	PAN ASSY, OIL (USA)	1	2195322	A1,D1,N1,N2
3	11300-ZE6-771	PAN ASSY, OIL	1	1120861	A1,D1,N1,N2
4	113A1-ZE6-640	PAN COMP, OIL	1	1120862	A1,D1,N1,N2
113A1-ZE6-641			1	1806077	A1,D1,N1,N2
5	11381-ZE6-000	PACKING, OIL PAN	1	2453088	A1,A1L,D1,N1,N1B,N2,N2CA,N2C1,N2F,N2T,SFL,SFSK
	11381-ZG9-J60		1		A1LA,A1L2,A12,A14,D12,N2TA,N12,N14,N2SS,N22,N24,P,PF,PFGA,PFTH,S,SF
	11381-ZE6-000		1	2453089	A1,A1L,D1,N1,N1B,N2,N2CA,N2C1,N2F,N2T,SFL,SFSK
6	121A0-ZE6-000	BARREL COMP, CYLINDER	1	1985315	A1,D1,N1,N2
	121A0-ZE6-030		1	1985316	A1L2,A12,N1B,N12,N2CA,N2F,N2T,N2Z,PFGA,SFSK
	12100-ZE6-030		1	2553493	A1L,D12,N2C1,SFL
	12100-ZE6-030		1	1985316	A1,D1,N1,N2
	12100-ZE6-100	BARREL COMP, CYLINDER (USA)	1	2553493	A1LA,A14,N2TA,N2SS,PFTH,SFFK,SFKR,SFLY,SFL1
	12100-ZE6-040	BARREL COMP, CYLINDER	1	2553494	A1L,A1LA,A14,D1,D12,N2TA,N1,N2,N2C1,N2SS,PFTH,SFFK,SFKR,SFL,SFLY,SFL1
7	12125-ZE6-000	PLATE, GUIDE	1	2553494	A1
	12125-ZE6-010		1	1039556	N1,N2
	12125-ZE6-010		1	1039557	S,SF,SFFK,SFKR,SFL,SFLY,SFL1,SFTH
8	12360-ZE6-000	CAP COMP, BREATHER CHAMBER	1	1039557	N1,N2

2 11300-ZE6-640 PAN ASSY, OIL (JPN) (USA)
 120
 120
 GXX
 GXX

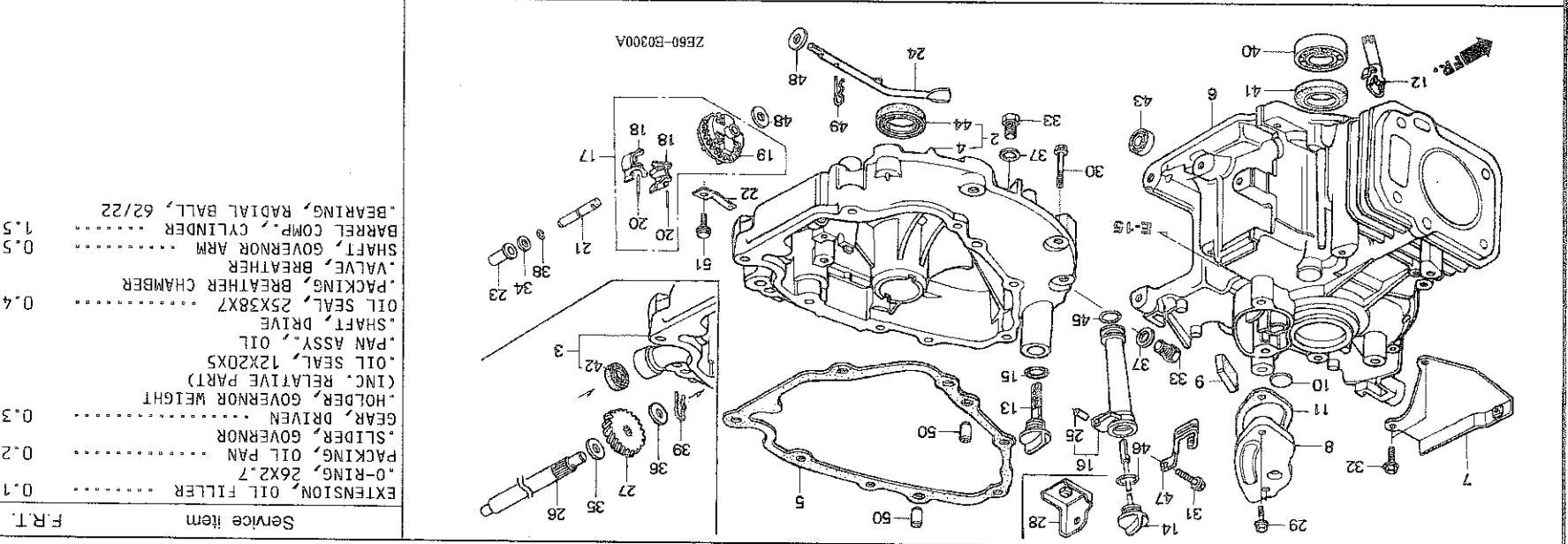

Service Item	F.R.T.
EXTENSION, OIL FILLER	0.1
O-RING, 26X2.7	0.2
PACKING, OIL PAN	0.2
SLIDER, GOVERNOR	0.2
GEAR, DRIVEN	0.3
HOLDER, GOVERNOR WEIGHT	0.3
(INC. RELATIVE PART)	
OIL SEAL, 12X20X5	
PAN ASSY, OIL	
SHAFT, DRIVE	
OIL SEAL, 25X38X7	0.4
PACKING, BREATHER CHAMBER	
VALVE, BREATHER	0.5
SHAFT, GOVERNOR ARM	0.5
BARREL COMP, CYLINDER	1.5
BEARING, RADIAL BALL, 62/22	1.5

C 4

CYLINDER BARREL/OIL PAN

CYLINDER BARREL/OIL PAN

Ref. No.	Part No.	Description	Reqd. QTY		Serial No.	Parts catalogue code
			GXV 120 (JPN)	GXV 120 (USA)		
9	12367-ZE6-000 12367-ZE6-010	FILTER, BREATHER	1	-	1985315	A1,D1,N1,N2
			1	-		A1L,A1LA,A1L2,A12,A14,D12,NZTA,N1B,N12,N14,N2CA,N2C1,N2F,N2SS,N2T,N22
			1	-	1985316	N24,P,PF,PFCA,PFTH,S,SF,SFFK,SFKR,SFL,SFLY,SFL1,SFS,SFSK,SFTH
			-	1		A1,D1,N1,N2
10	12372-879-000	VALVE, BREATHER	1	1		
11	12373-ZE6-000	PACKING, BREATHER CHAMBER ...	1	1		
12	12385-ZE6-000	PIPE, OIL DEFENSE	1	1		
13	15620-ZE6-000 15620-ZE6-010	CAP, OIL FILLER	1	-	1120861	N1,N2
14	15620-ZE6-680	GAUGE COMP., OIL LEVEL	(1)	-	1120862	1257294 N1,N2
			1	-		1257294 N1,N2
			1	-		1617086 A1,D1
	15620-ZE7-000		1	-	1257295	1617086 N1,N2
			1	-	1617087	2195321 A1,D1,N1,N2
	15620-ZE6-810		-	1		
			1	-		A1L,A1LA,A1L2,A12,A14,D12,NZTA,N1B,N12,N14,N2CA,N2C1,N2F,N2SS,N2T,N22
			1	-	2195322	N24,P,PF,PFCA,PFTH,S,SF,SFFK,SFKR,SFL,SFLY,SFL1,SFS,SFSK,SFTH
15	15625-ZE6-000	PACKING, OIL FILLER CAP	1	-		A1,D1,N1,N2
			1	-	1257294	N1,N2
16	15630-ZE6-680	EXTENSION, OIL FILLER	(1)	-	1257294	N1,N2
			1	-		2195321 A1,D1
			1	-	1257295	2195321 N1,N2
	15630-ZE6-810		-	1		
			1	-		A1L,A1LA,A1L2,A12,A14,D12,NZTA,N1B,N12,N14,N2CA,N2C1,N2F,N2SS,N2T,N22
			1	-	2195322	N24,P,PF,PFCA,PFTH,S,SF,SFFK,SFKR,SFL,SFLY,SFL1,SFS,SFSK,SFTH
			1	-		A1,D1,N1,N2
17	16510-ZE6-000	GOVERNOR ASSY.	1	1		
18	16511-ZE1-000	WEIGHT, GOVERNOR	2	2		
19	16512-ZE6-000	HOLDER, GOVERNOR WEIGHT	1	1		
20	16513-ZE1-000	PIN, GOVERNOR WEIGHT	2	2		
21	16515-ZE6-000	SHAFT, GOVERNOR HOLDER	1	1		
22	16525-ZE6-000	PLATE, GOVERNOR SHAFT HOLDER	1	-		A1,D1,N1,N2
	16525-ZE6-010		-	1		
			1	-		A1L,A1LA,A1L2,A12,A14,D12,NZTA,N1B,N12,N14,N2CA,N2C1,N2F,N2SS,N2T,N22
			1	-		N24,P,PF,PFCA,PFTH,S,SF,SFFK,SFKR,SFL,SFLY,SFL1,SFS,SFSK,SFTH
23	16531-ZE1-000	SLIDER, GOVERNOR	1	1		
24	16541-ZE6-000 16541-ZE7-000	SHAFT, GOVERNOR ARM	1	-	1616912	A1,D1,N1,N2
			1	-		A1L,A1LA,A1L2,A12,A14,D12,NZTA,N1B,N12,N14,N2CA,N2C1,N2F,N2SS,N2T,N22
			1	-	1616913	N24,P,PF,PFCA,PFTH,S,SF,SFFK,SFKR,SFL,SFLY,SFL1,SFS,SFSK,SFTH
			-	1		A1,D1,N1,N2
25	17240-ZE6-000	COLLAR, EXTENSION	(1)	-	1257294	N1,N2
			1	-		A1,A1L,A1LA,A1L2,A12,A14,D1,D12,NZTA,N1B,N12,N14,N2CA,N2C1,N2F,N2SS
			1	-	1257295	N2T,N22,N24,P,PF,PFCA,PFTH,S,SF,SFFK,SFKR,SFL,SFLY,SFL1,SFS,SFSK,SFTH
			-	1		N1,N2
26	23411-ZE6-000	SHAFT, DRIVE	1	-		S,SF,SFFK,SFKR,SFL,SFLY,SFL1,SFS,SFSK,SFTH
27	23421-ZE6-000	GEAR, DRIVEN (18T)	1	-		S,SF,SFFK,SFKR,SFL,SFLY,SFL1,SFS,SFSK,SFTH
28	43143-ZE6-000	BASE COMP., HOLDER	1	1		A1,A1#,A1L,A1LA,A1L2,A12,A14,N2C1
29	90013-883-000	BOLT, FLANGE, 6X12(CT200) ...	2	-		
	90014-952-000	BOLT, FLANGE, 6X14(CT200) ...	-	2		
30	90015-883-000	BOLT, FLANGE, 6X28	7	-		
	95701-06028-00		-	7		



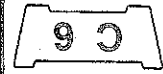

CYLINDER BARREL/OIL PAN

E-3

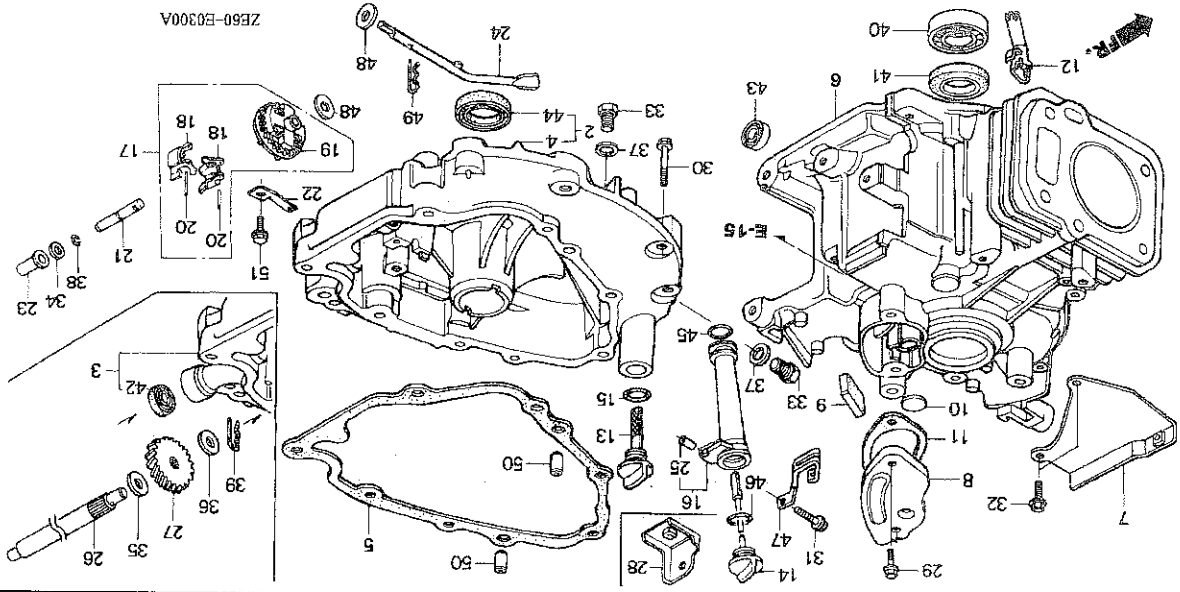

Ref. No.	Part No.	Description	Reqd. QTY	Serial No.	Parts catalogue code
			GXV		
			GXV		
			(JPN)		
			120		
			(USA)		

31	90017-883-000	BOLT, FLANGE, 6X32	(1)	1257294	N1,N2
					A1,A1L,A1LA,A1L2,A12,A14,D1,D12,NZTA,N1B,N12,N14,N2,N2CA,N2F,N2SS,N2T,N2F,N2SS
					N21,N22,N24,P,PF,PFCA,PFTH,S,SF,SFFK,SFKR,SFL,SFLY,SFL1,SFS,SFSK,SFTH
					N1,N2
32	90022-888-010	BOLT, FLANGE, 6X20(C1200)	2		D1,D12,NZTA,N1,N1B,N12,N14,N2,N2CA,N2F,N2SS,N2T,N2F,N2SS,N24,P,PF,PFCA
					D1#
					PFTH,S,SF,SFFK,SFKR,SFL,SFLY,SFL1,SFTH
95701-06020-00	BOLT, FLANGE, 6X20	2		2089575	A1,D1,N1,N2
33	90131-ZE1-000	BOLT, DRAIN PLUG	2		A1L,A1LA,A1L2,A12,A14,D12,NZTA,N1B,N12,N14,N2CA,N2C1,N2F,N2T,N22
					N24,P,PF,PFCA,PFTH,S,SF,SFFK,SFKR,SFL,SFLY,SFL1,SFS,SFSK,SFTH
					A1L,A1LA,A1L2,A12,A14,D12,NZTA,N1B,N12,N14,N2CA,N2C1,N2F,N2T,N22
34	90451-898-000	WASHER, THRUST, 6MM	1	2089576	A1,D1,N1,N2
					A1L,A1LA,A1L2,A12,A14,D12,NZTA,N1B,N12,N14,N2CA,N2C1,N2F,N2T,N22
					N24,P,PF,PFCA,PFTH,S,SF,SFFK,SFKR,SFL,SFLY,SFL1,SFS,SFSK,SFTH
35	90452-166-600	WASHER, THRUST, 12MM	1		A1,D1,N1,N2
					A1L,A1LA,A1L2,A12,A14,D12,NZTA,N1B,N12,N14,N2CA,N2C1,N2F,N2T,N22
					N24,P,PF,PFCA,PFTH,S,SF,SFFK,SFKR,SFL,SFLY,SFL1,SFS,SFSK,SFTH
36	90452-187-000	WASHER, 10X21	1		A1,D1,N1,N2
					A1L,A1LA,A1L2,A12,A14,D12,NZTA,N1B,N12,N14,N2CA,N2C1,N2F,N2T,N22
					N24,P,PF,PFCA,PFTH,S,SF,SFFK,SFKR,SFL,SFLY,SFL1,SFS,SFSK,SFTH
37	90601-ZE1-000	WASHER, DRAIN PLUG, 10.2MM	2	2089575	A1,D1,N1,N2
					A1L,A1LA,A1L2,A12,A14,D12,NZTA,N1B,N12,N14,N2CA,N2C1,N2F,N2T,N22
					N24,P,PF,PFCA,PFTH,S,SF,SFFK,SFKR,SFL,SFLY,SFL1,SFS,SFSK,SFTH
38	90602-ZE1-000	CLIP, GOVERNOR HOLDER	1	2089576	A1,D1,N1,N2
					A1L,A1LA,A1L2,A12,A14,D12,NZTA,N1B,N12,N14,N2CA,N2C1,N2F,N2T,N22
					N24,P,PF,PFCA,PFTH,S,SF,SFFK,SFKR,SFL,SFLY,SFL1,SFS,SFSK,SFTH
39	90701-ZE6-000	PIN, LOCK, 2.0	1		A1,D1,N1,N2
					A1L,A1LA,A1L2,A12,A14,D12,NZTA,N1B,N12,N14,N2CA,N2C1,N2F,N2T,N22
					N24,P,PF,PFCA,PFTH,S,SF,SFFK,SFKR,SFL,SFLY,SFL1,SFS,SFSK,SFTH
40	91001-878-003	BEARING, RADIAL BALL, 62/22	1		A1,D1,N1,N2
					A1L,A1LA,A1L2,A12,A14,D12,NZTA,N1B,N12,N14,N2CA,N2C1,N2F,N2T,N22
					N24,P,PF,PFCA,PFTH,S,SF,SFFK,SFKR,SFL,SFLY,SFL1,SFS,SFSK,SFTH

E-3

CYLINDER BARREL/OIL PAN

C 7

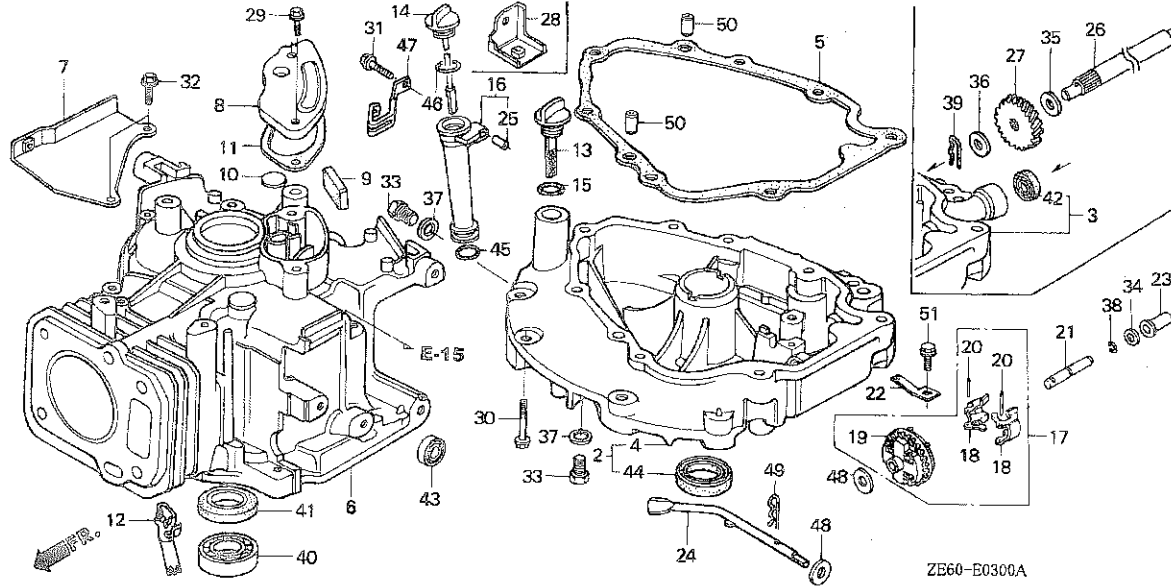

Ref. No.	Part No.	Description	Reqd. QTY		Serial No.	Parts catalogue code
			GXV 120 (JPN)	GXV 120 (USA)		
41	91202-ZE6-000	OIL SEAL, 22X35X6	1	-	-----	A1,D1,N1,N2
	91202-ZE6-003	-	1	-----	
42	91205-KFO-003	OIL SEAL, 12X20X5 (ARAI)	1	1	-----	S,SF,SFFK,SFKR,SFL,SFLY,SFL1,SFS,SFSK,SFTH
43	91231-891-003	OIL SEAL, 6X11X4	1	1	-----	
44	91252-888-003	OIL SEAL, 25X38X7 (ARAI)	1	1	-----	
45	91301-805-000	O-RING, 26X2.7	1	-	-----	N2SS,P,PF,PFTH,S,SF,SFFK,SFKR,SFLY,SFS,SFTH
			(1)	-	-----	1257294 N1,N2
			1	-	-----	A1,A1L,A1LA,A1L2,A12,A14,D1,D12,NZTA,N1B,N12,N14,N2CA,N2C1,N2F,N2T
			1	-	-----	N22,N24,PFCA,SFL,SFL1,SFSK
			-	1	-----	N1,N2
46	91305-679-003	O-RING, 22.1X2	(1)	-	-----	1257294 N1,N2
	91301-ZE9-003	O-RING, 22.5X2.2	1	-	-----	A1,A1L,A1LA,A1L2,A12,A14,D1,D12,NZTA,N1B,N12,N14,N2CA,N2C1,N2F,N2SS
			1	-	-----	N2T,N22,N24,P,PF,PFCA,PFTH,S,SF,SFFK,SFKR,SFL,SFLY,SFL1,SFS,SFSK,SFTH
			-	1	-----	N1,N2
47	91406-VA3-900	CLIP, WIRE	1	-	-----	SFS,SFSK
48	94101-06800	WASHER, PLAIN, 6MM	2	2	-----	
49	94251-08000	PIN, LOCK, 8MM	1	1	-----	
50	94301-08140	DOWEL PIN, 8X14	2	2	-----	
51	95700-06012-08	BOLT, FLANGE, 6X12	1	-	-----	A1,D1,N1,N2
			-	1	-----	
	95701-06012-08	1	-	-----	A1L,A1LA,A1L2,A12,A14,D12,NZTA,N1B,N12,N14,N2CA,N2C1,N2F,N2SS,N2T,N22
					-----	N24,P,PF,PFCA,PFTH,S,SF,SFFK,SFKR,SFL,SFLY,SFL1,SFS,SFSK,SFTH



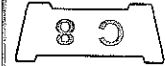
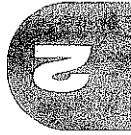

CRANKSHAFT/PISTON

E-8

Service Item F.R.T.

- 1.1 RING SET, PISTON
- 1.2 PISTON
- 1.3 CRANKSHAFT COMP.

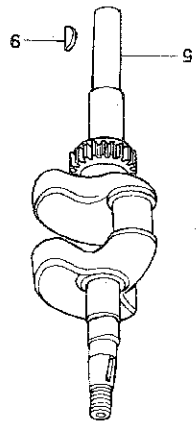

ZB60-E0800A

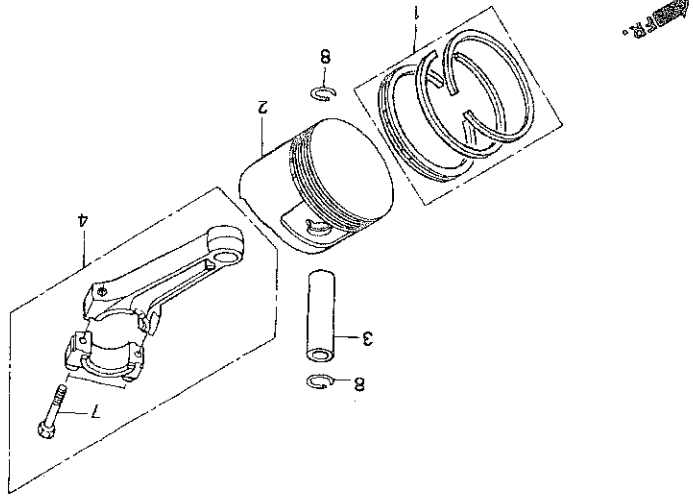

Ref. No.	Part No.	Description	Reqd. QTY	Serial No.	Parts catalogue code

1	13010-ZE6-003	RING SET, PISTON (STD.)	1	2147021 A1, D1, N1, N2	
	13010-ZE6-004	RING SET, PISTON (STD.)	1	2147021 A1, D1, N1, N2	
	13010-ZE6-013	RING SET, PISTON (STD.)	1	2147022	A1, A1A, A1L, A12, A14, D12, NZTA, N1B, N12, N14, NZCA, NZC1, NZF, NZSS, NZT, NZ2
	13010-ZE6-014	RING SET, PISTON (STD.)	1	2147022	A1, A1A, A1L, A12, A14, D12, NZTA, N1B, N12, N14, NZCA, NZC1, NZF, NZSS, NZT, NZ2
	13011-ZE6-003	RING SET, PISTON (0.25)	1	2147022	A1, D1, N1, N2
	13011-ZE6-004	RING SET, PISTON (0.25)	1	2147021 A1, D1, N1, N2	
	13011-ZE6-013	RING SET, PISTON (0.25)	1	2147022	A1, A1A, A1L, A12, A14, D12, NZTA, N1B, N12, N14, NZCA, NZC1, NZF, NZSS, NZT, NZ2
	13011-ZE6-014	RING SET, PISTON (0.25)	1	2147022	A1, A1A, A1L, A12, A14, D12, NZTA, N1B, N12, N14, NZCA, NZC1, NZF, NZSS, NZT, NZ2
	13012-ZE6-003	RING SET, PISTON (0.50)	1	2147021 A1, D1, N1, N2	
	13012-ZE6-004	RING SET, PISTON (0.50)	1	2147021 A1, D1, N1, N2	

CRANKSHAFT/PISTON

Ref. No.	Part No.	Description	Reqd. QTY		Serial No.	Parts catalogue code
			GXV 120 (JPN)	GXV 120 (USA)		
(1)	13012-ZE6-013	RING SET, PISTON (0.50) (NIPPON)	(1)	-	-----	A1L,A1LA,A1L2,A12,A14,D12,NZTA,N1B,N12,N14,N2CA,N2C1,N2F,N2SS,N2T,N22 N24,P,PF,PFCA,PFTH,S,SF,SFFK,SFKR,SFL,SFLY,SFL1,SFS,SFSK,SFTH
			(1)	-	2147022	A1,D1,N1,N2
	13012-ZE6-014	RING SET, PISTON (0.50) (TEIKOKU)	(1)	-	-----	A1L,A1LA,A1L2,A12,A14,D12,NZTA,N1B,N12,N14,N2CA,N2C1,N2F,N2SS,N2T,N22 N24,P,PF,PFCA,PFTH,S,SF,SFFK,SFKR,SFL,SFLY,SFL1,SFS,SFSK,SFTH
			(1)	-	2147022	A1,D1,N1,N2
	13013-ZE6-003	RING SET, PISTON (0.75)	(1)	-	-----	A1,D1,N1,N2
	13013-ZE6-004	(1)	-	2147021	A1,D1,N1,N2
	13013-ZE6-013	RING SET, PISTON (0.75) (NIPPON)	(1)	-	-----	A1L,A1LA,A1L2,A12,A14,D12,NZTA,N1B,N12,N14,N2CA,N2C1,N2F,N2SS,N2T,N22 N24,P,PF,PFCA,PFTH,S,SF,SFFK,SFKR,SFL,SFLY,SFL1,SFS,SFSK,SFTH
			(1)	-	2147022	A1,D1,N1,N2
	13013-ZE6-014	RING SET, PISTON (0.75) (TEIKOKU)	(1)	-	-----	A1L,A1LA,A1L2,A12,A14,D12,NZTA,N1B,N12,N14,N2CA,N2C1,N2F,N2SS,N2T,N22 N24,P,PF,PFCA,PFTH,S,SF,SFFK,SFKR,SFL,SFLY,SFL1,SFS,SFSK,SFTH
			(1)	-	2147022	A1,D1,N1,N2
2	13101-ZE6-003	PISTON (STD.)	1	-	-----	A1,D1,N1,N2
	13101-ZE6-013	1	-	1219524	2147021 A1,D1,N1,N2
	13101-ZE6-023	1	-	-----	N2SS,P,PF,PFTH,S,SF,SFFK,SFKR,SFLY,SFS,SFTH
			1	-	-----	A1L,A1LA,A1L2,A12,A14,D12,NZTA,N1B,N12,N14,N2CA,N2C1,N2F,N2T,N22,N24 PFCA,SFL,SFL1,SFSK
			1	-	2147022	A1,D1,N1,N2
	13102-ZE6-003	PISTON (0.25)	(1)	-	-----	A1,D1,N1,N2
	13102-ZE6-013	(1)	-	1219524	2147021 A1,D1,N1,N2
	13102-ZE6-023	(1)	-	-----	A1L,A1L2,A12,A14,D12,NZTA,N1B,N12,N14,N2CA,N2C1,N2F,N2SS,N2T,N22,N24 P,PF,PFCA,PFTH,S,SF,SFFK,SFKR,SFL,SFL1,SFS,SFSK,SFTH
			(1)	-	2147022	A1,D1,N1,N2
	13103-ZE6-003	PISTON (0.50)	(1)	-	-----	A1,D1,N1,N2
	13103-ZE6-013	(1)	-	1219524	2147021 A1,D1,N1,N2
	13103-ZE6-023	(1)	-	-----	A1L,A1L2,A12,A14,D12,NZTA,N1B,N12,N14,N2CA,N2C1,N2F,N2SS,N2T,N22,N24 P,PF,PFCA,PFTH,S,SF,SFFK,SFKR,SFL,SFL1,SFS,SFSK,SFTH
			(1)	-	2147022	A1,D1,N1,N2
	13104-ZE6-003	PISTON (0.75)	(1)	-	-----	A1,D1,N1,N2
	13104-ZE6-013	(1)	-	1219524	2147021 A1,D1,N1,N2
	13104-ZE6-023	(1)	-	-----	A1L,A1L2,A12,A14,D12,NZTA,N1B,N12,N14,N2CA,N2C1,N2F,N2SS,N2T,N22,N24 P,PF,PFCA,PFTH,S,SF,SFFK,SFKR,SFL,SFL1,SFS,SFSK,SFTH
			(1)	-	2147022	A1,D1,N1,N2
3	13111-ZE0-000	PIN, PISTON	1	1	-----	
4	13200-ZE6-010	ROD ASSY., CONNECTING	1	-	-----	N2SS,P,PF,PFTH,S,SF,SFFK,SFKR,SFLY,SFS,SFTH
	13200-ZE6-315	ROD ASSY., CONNECTING (0.25 UNDER SIZE)	(1)	-	-----	N2SS,P,PF,PFTH,S,SF,SFFK,SFKR,SFLY,SFS,SFTH
	13200-ZE6-000	ROD ASSY., CONNECTING	1	-	2250472	A1,D1,N1,N2
	13200-ZE6-010	1	-	-----	A1L,A1LA,A1L2,A12,A14,D12,NZTA,N1B,N12,N14,N2CA,N2C1,N2F,N2T,N22,N24 PFCA,SFL,SFL1,SFSK
			1	-	2250473	A1,D1,N1,N2
	132A0-ZE6-305	ROD ASSY., CONNECTING (0.25 UNDER SIZE)	(1)	-	-----	A1,D1,N1,N2

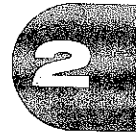

Ref. No.	Part No.	Description	Reqd. QTY 120 120 GXV GXV (JPN) (USA)	Serial No.	Parts catalogue code
(4)	13200-ZE6-315	ROD ASSY., CONNECTING (0.25 UNDER SIZE)	(1)	-----	A1L,A1LA,A1L2,A12,A14,D12,N2TA,N1B,N12,N14,N2CA,N2C1,N2F,N2T,N22,N24 PFCA,SFL,SFL1,SFSK
5	1331D-ZE6-64D	CRANKSHAFT COMP.	1	-----	NZTA,N2,N2CA,N2C1,N2F,N2SS,N2T,N22,N24,PPTH,SFTH
	1331D-ZE6-770	1	-----	P,PF,PFCA,S,SF,SFFK,SFKR,SFL,SFLY,SFL1,SFS,SFSK
	1331D-ZE6-000	1	-----	A1,A1L,A1LA,A1L2,A12,A14,D1,D12,N1,N1B,N12,N14
7	90001-ZE1-000	BOLT, CONNECTING ROD	2	2	-----
8	90551-ZE0-000	CLIP, PISTON PIN, 13MM	2	2	-----
9	94401-16150	KEY, WOODRUFF, 16X15	-	2	PPTH,SFTH

CRANKSHAFT/PISTON

G10

ZE60-E0800A

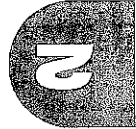
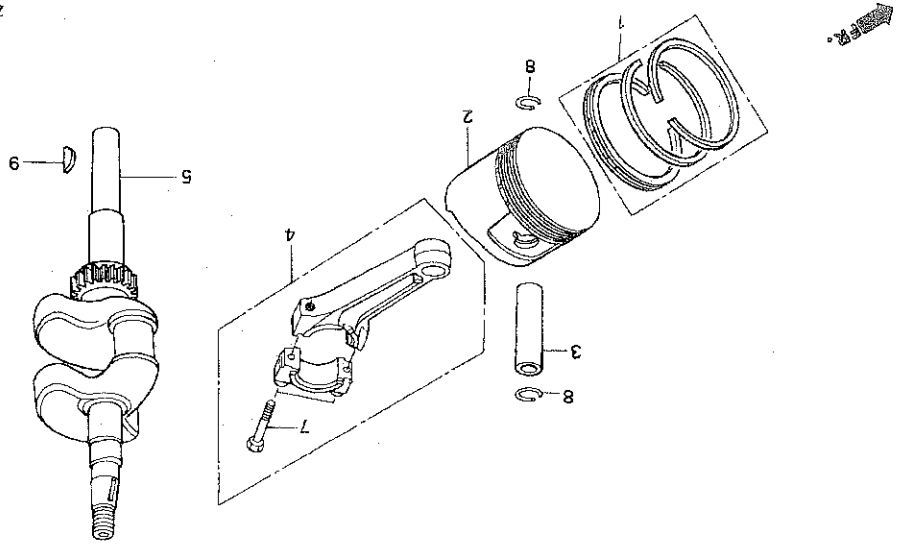

E-9

CAMSHAFT

C11

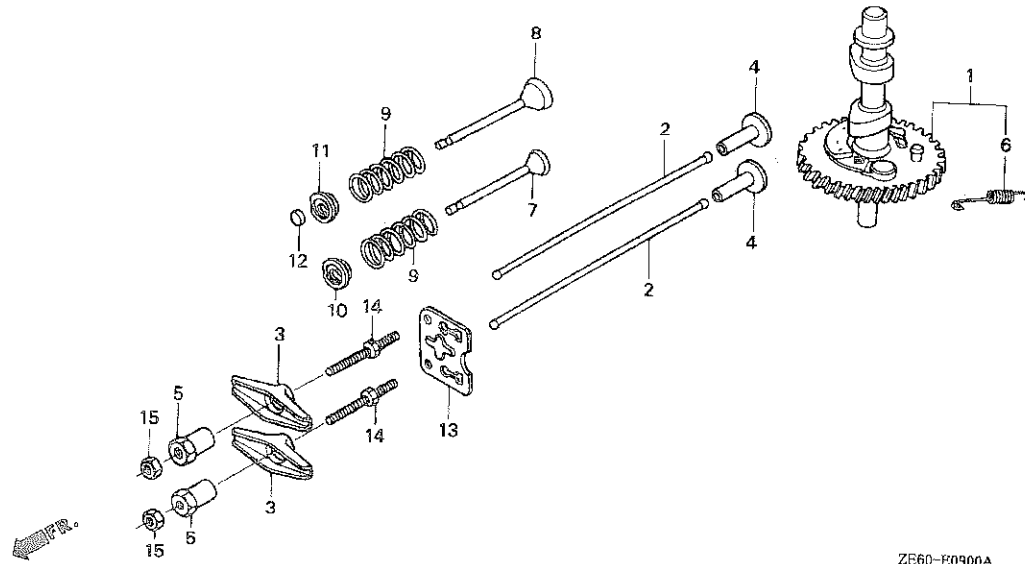

ZE60-E0900A

Service item	F.R.T.
ARM, VALVE ROCKER	0.2
PIVOT, ROCKER ARM	
ROD, PUSH	
ROTATOR, VALVE	
CAMSHAFT ASSY.	0.6
LIFTER, VALVE	
VALVE, IN.	0.7
(ADD 0.1 FOR EACH.)	

Ref. No.	Part No.	Description	Reqd. QTY		Serial No.	Parts catalogue code
			GXV 120 (JPN)	GXV 120 (USA)		
1	14100-ZE6-000	CAMSHAFT ASSY.	1	-	1199713 A1, D1, N1, N2	
	14100-ZE6-010	1	-	1199714 1219523 A1, D1, N1, N2	
	14100-ZE6-020	1	-	2465083 A1L, N1B, N2CA, N2C1, N2F, N2T	
		1	-	1219524 2465083 A1, D1, N1, N2	
	14100-ZE6-772	1	-	2465783 SFL, SFSK	
	14100-ZE6-W00	1	-	A1LA, A1L2, A12, A14, D12, NZTA, N12, N14, N2SS, N22, N24, P, PF, PFCA, PFTH	
	14100-ZE6-W10	1	-	2465084 A1, A1L, D1, N1, N1B, N2, N2CA, N2C1, N2F, N2T	
		1	-	S, SF, SFFK, SFKR, SFLY, SFL1, SFS, SFTH	
2	14410-ZE0-010	ROD, PUSH	1	-	2465784 SFL, SFSK	
3	14431-ZE1-000	ARM, VALVE ROCKER	2	2		
4	14441-ZE1-000	LIFTER, VALVE	2	2		
		2	-	P, PF, S, SF, SFS	
		2	-	2514530 A1, A1L, A1L2, A12, A14, D1, D12, N1, N1B, N12, N14, N2, N2CA, N2C1, N2F, N2T, N22, N24, PFCA, PFTH, SFKR, SFL, SFSK, SFTH	
	14441-ZE1-010	2	2		
		2	-	2514531 A1LA, NZTA, N2SS, SFFK, SFLY, SFL1	
		2	-	A1, A1L, A1L2, A12, A14, D1, D12, N1, N1B, N12, N14, N2, N2CA, N2C1, N2F, N2T, N22, N24, PFCA, PFTH, SFKR, SFL, SFSK, SFTH	
5	14451-ZE1-003	PIVOT, ROCKER ARM	2	-	N2T	
		2	-	2450338 A1, A1L, D1, N1, N1B, N2, N2CA, N2C1, N2F, SFL, SFSK	
	14451-ZE1-013	2	-		
		2	-	A1LA, A1L2, A12, A14, D12, NZTA, N12, N14, N2SS, N22, N24, P, PF, PFCA, PFTH, S, SF, SFFK, SFKR, SFLY, SFL1, SFS, SFTH	
		2	-	2450339 A1, A1L, D1, N1, N1B, N2, N2CA, N2C1, N2F, SFL, SFSK	
6	14568-ZE1-000	SPRING, WEIGHT RETURN	1	1		
7	14711-ZE0-000	VALVE, IN.	1	-	1969443 A1, D1, N1, N2	



E-9

CAMSHAFT

C13

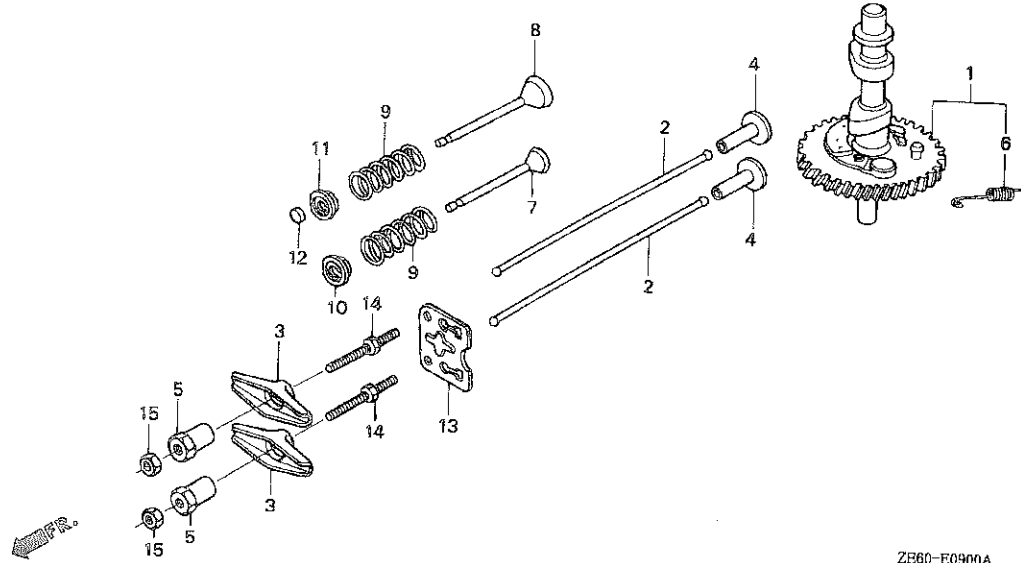

ZE60-E0900A

Ref. No.	Part No.	Description	Reqd. QTY		Serial No.	Parts catalogue code	
			GXV 120 (JPN)	GXV 120 (USA)			
12	14781-ZE1-000	ROTATOR, VALVE	1	-	-----	N2F	
13	14791-ZE0-000	PLATE, PUSH ROD GUIDE	1	-	-----	1163730 A1,D1,N1,N2	
	14791-ZE0-010	1	-	-----	A1L,A1LA,A1L2,A12,A14,D12,NZTA,N1B,N12,N14,N2CA,N2C1,N2F,N2SS,N2T,N22,N24,P,PF,PFCA,PFTH,S,SF,SFFK,SFKR,SFL,SFLY,SFL1,SFS,SFSK,SFTH	
			1	-	1163731	-----	A1,D1,N1,N2
14	90012-ZE0-000	BOLT, PIVOT (6MM)	-	1	-----		
	90012-ZE0-010	BOLT, PIVOT, 8MM	2	-	-----	1163730 A1,D1,N1,N2	
			2	-	-----	A1L,A1LA,A1L2,A12,A14,D12,NZTA,N1B,N12,N14,N2CA,N2C1,N2F,N2SS,N2T,N22,N24,P,PF,PFCA,PFTH,S,SF,SFFK,SFKR,SFL,SFLY,SFL1,SFS,SFSK,SFTH	
			2	-	1163731	-----	A1,D1,N1,N2
15	90206-ZE1-000	NUT, PIVOT ADJUSTING	2	2	-----		



RECOIL STARTER

E-11

C14

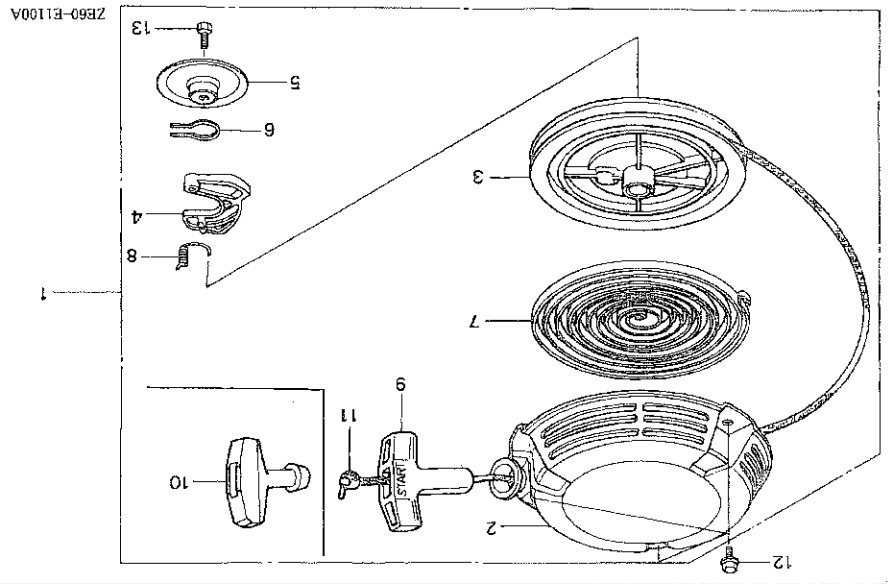

ZE60-E1100A

Service item F.R.T.

- 0.1 STARTER ASSY, RECOIL
- 0.2 RATCHET, STARTER
- 0.3 PULLLEY, RECOIL STARTER
- ROPE, RECOIL STARTER
- SPRING, RECOIL STARTER

Ref. No.	Part No	Description	Regd. QTY	Serial No.	Parts catalogue code
----------	---------	-------------	-----------	------------	----------------------

1	28400-ZE6-003ZA	STARTER ASSY., RECOIL	1	A1,A12,A14,D1,D12,NZTA,N1,N12,N14,N2,N2CA,N2SS,N2T,N22,N24,P,PF,PCAPFTH,S,SF,SFFK,SFKR,SFL,SFLY,SFL1,SFS,SFSK,SFTH	
	NH1	BLACK	1	N14,N24,SFL1	
	150	STARTER ASSY., RECOIL (BRILL)	1		
	150	BRILL RED	1	M1B	
2	28400-Z69-141ZA	STARTER ASSY., RECOIL	1		
	R8	BRIGHT RED	1	A1L,A1LA,A1L2,N2C1	
	NH1	BLACK	1	NZF	
	R8	BRIGHT RED	1	A1,A11,A1LA,A1L2,A12,A14,D1,D12,NZTA,N1,N12,N14,N2,N2CA,N2C1,N2SS,N2T,N22,N24,P,PF,PCAPFTH,S,SF,SFFK,SFKR,SFL,SFLY,SFL1,SFS,SFSK,SFTH	
	NH1	BLACK	1	N14,N2F,N24,SFL1	
	150	BRILL RED	1	M1B	
	150	PULLLEY, RECOIL STARTER	1	N2SS,P,PF,PFTH,S,SF,SFFK,SFKR,SFLY,SFS,SFTH	
3	28420-ZE6-003		1	1617086 A1,D1,N1,N2	
			1	2089575 A1,D1,N1,N2	
			1	A1L,A1LA,A1L2,A12,A14,D12,NZTA,N1B,N12,N14,N2CA,N2C1,N2F,N2T,N22,N24	
			1	PFCA,SFL,SFL1,SFSK	
			1	2089576 A1,D1,N1,N2	
4	28422-896-010	RATCHET, STARTER	1		
			1		
			1		
5	28431-896-000	PLATE, FRICTION	1		
			1		
6	28441-896-000	SPRING, FRICTION	1		
			1		
7	28442-896-700	SPRING, RECOIL STARTER	1	1257294 A1,D1,N1,N2	

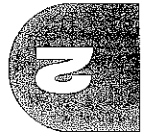

E-11

RECOIL STARTER

C15

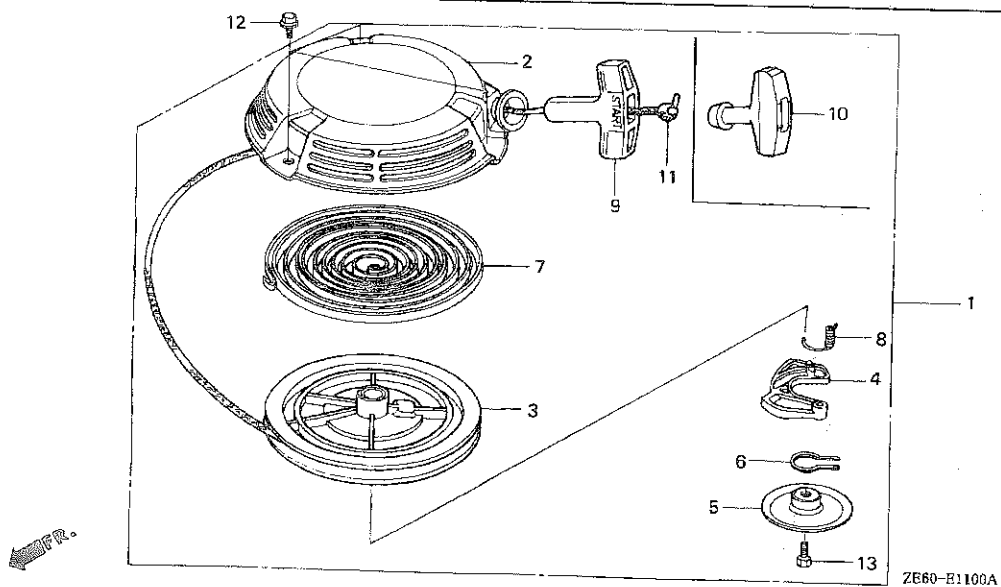

Ref. No.	Part No.	Description	Reqd. QTY		Serial No.	Parts catalogue code
			GXV 120 (JPN)	GXV 120 (USA)		
(7)	28442-ZE6-003	SPRING, RECOIL STARTER	1	-	-	A1L,A1LA,A1L2,A12,A14,D12,NZTA,N1B,N12,N14,N2CA,N2C1,N2F,N2SS,N2T,N22,N24,P,PF,PFCA,PFTH,S,SF,SFFK,SFKR,SFL,SFLY,SFL1,SFS,SFSK,SFTH
8	28443-896-000	SPRING, RETURN	-	1	1257295	A1,D1,N1,N2
9	28461-ZE1-003	KNOB, RECOIL STARTER	1	1	-	-
10	28461-878-810	GRIP, STARTER	1	-	2089576	A1L,A1LA,A1L2,A12,A14,D12,NZTA,N1B,N12,N14,N2CA,N2C1,N2F,N2SS,N2T,N22,N24,P,PF,PFCA,PFTH,S,SF,SFFK,SFKR,SFL,SFLY,SFL1,SFS,SFSK,SFTH
11	28462-ZA7-003	ROPE, RECOIL STARTER	1	-	2089575	A1,D1,N1,N2
	28462-ZE6-U50		-	1	-	A1,A12,A14,D1,D12,NZTA,N1,N12,N14,N2,N2CA,N2SS,N2T,N22,N24,P,PF,PFCA,PFTH,S,SF,SFFK,SFKR,SFL,SFLY,SFL1,SFS,SFSK,SFTH
	28462-ZG9-T40		1	-	-	N1B
12	90012-ZE6-000	BOLT, FLANGE, 6X8	1	-	-	A1L,A1LA,A1L2,N2C1,N2F
	95701-06008-00		3	-	2460953	A1,A1L,D1,N1,N1B,N2,N2CA,N2C1,N2F,N2T,SFL,SFSK
			3	-	-	N2SS,P,PF,PFTH,S,SF,SFFK,SFKR,SFLY,SFS,SFTH
			3	-	-	A1LA,A1L2,A12,A14,D12,NZTA,N12,N14,N22,N24,PFCA,SFL1
13	92000-06012-0H	BOLT, HEX., 6X12	3	-	2460954	A1,A1L,D1,N1,N1B,N2,N2CA,N2C1,N2F,N2T,SFL,SFSK
			1	-	2460953	A1,A1L,D1,N1,N2,N2CA,N2C1,N2F,N2T,SFL,SFSK
	92101-06012-0H		1	-	-	A1LA,A1L2,A12,A14,D12,NZTA,N1B,N12,N14,N2SS,N22,N24,P,PF,PFCA,PFTH,S,SF,SFFK,SFKR,SFLY,SFL1,SFS,SFTH
			1	-	2460954	A1,A1L,D1,N1,N2,N2CA,N2C1,N2F,N2T,SFL,SFSK

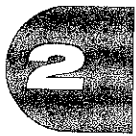

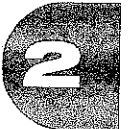
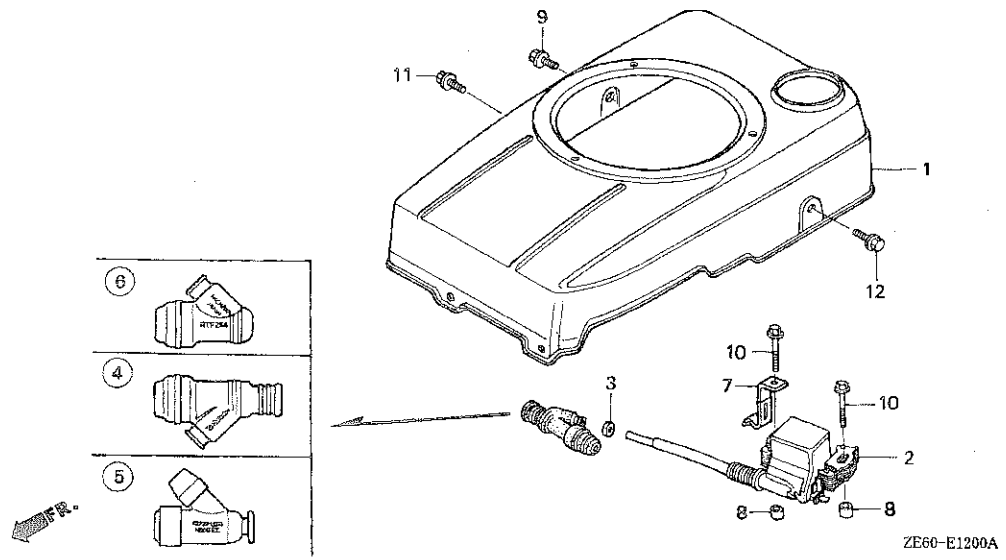

Ref. No.	Part No.	Description	Reqd. QTY		Serial No.	Parts catalogue code
			GXV 120 (JPN)	GXV 120 (USA)		
(5)	30700-ZE6-023	CAP ASSY., NOISE SUPPRESSOR	1	-	-	A1L,A1LA,A1L2,A12,A14,D12,NZTA,N1B,N12,N14,N2CA,N2C1,N2F,N2SS,N22,N24,SFLY,SFL1
			1	-	2195322	A1,D1,N1,N2
			1	-	2530282	PFTH,SFL,SFTH
			1	-	2530322	SFFK,SFKR
6	30700-898-003 30700-898-013	CAP ASSY., NOISE SUPPRESSOR	1	-	1007897	N1,N2
			1	-	1257294	A1,D1
7	36125-ZE6-000 36125-ZE6-010	CLAMPER, CORD	1	-	1007898	1257294 N1,N2
			1	-	2480802	SFSK
			1	-	2480803	SFS
8	75133-960-000	COLLAR, ROTO-STOP	2	2	-	SFSK
9	90013-883-000	BOLT, FLANGE, 6X12(CT200)	1	-	-	A1,A1#,A1L,A1LA,A1L2,A12,A14,N1B,N2C1,SFS,SFSK
10	90121-952-000	BOLT, FLANGE, 6X25	2	2	-	A14,NZTA,N1,N1B,N12,N14,N2,N2CA,N2C1,N2F,N2SS,N2T,N22,N24,P,PF,PFCA
	90014-ZE6-000	BOLT, FLANGE, 6X35	2	2	-	PFTH,S,SF,SFFK,SFKR,SFL,SFLY,SFL1,SFS,SFSK,SFTH
11	95700-06010-00 95701-06010-00	BOLT, FLANGE, 6X10	1	-	-	D1,D1#,D12,NZTA,N1,N12,N14,N2,N2CA,N2F,N2SS,N2T,N22,N24,P,PF,PFCA
			1	-	-	PFTH,S,SF,SFFK,SFKR,SFL,SFLY,SFL1,SFTH
12	90013-883-000	BOLT, FLANGE, 6X12(CT200)	1	-	-	A1,A1#,A1L,A1LA,A1L2,A12,A14,N1B,N2C1,SFS,SFSK
	95700-06012-08 95701-06012-08	BOLT, FLANGE, 6X12	1	-	-	A1,D1,N1,N2
	90013-883-000	BOLT, FLANGE, 6X12(CT200)	1	-	-	A1L,A1LA,A1L2,A12,A14,D12,NZTA,N1B,N12,N14,N2CA,N2C1,N2F,N2SS,N2T,N22,N24,P,PF,PFCA,PFTH,S,SF,SFFK,SFKR,SFL,SFLY,SFL1,SFS,SFSK,SFTH
			-	1	-	A1,A1L,A1LA,A1L2,A12,D1,D12,N12,N22
			1	-	-	N1,N2,N2F
			1	-	-	SFS
			1	-	-	NZTA,N14,N2CA,N2C1,N2SS,N24,P,PF,PFCA,PFTH,S,SF,SFFK,SFKR,SFL,SFLY,SFL1,SFTH



E-14

CARBURETOR



Service item F.R.T.

CARBURETOR ASSY. 0.2

INSULATOR, CARBURETOR

PACKING, FUEL COCK

PACKING, INSULATOR

SCREW SET, PILOT

FLOAT SET

..... 0.3

GASKET SET

JET, MAIN

VALVE SET, FLOAT

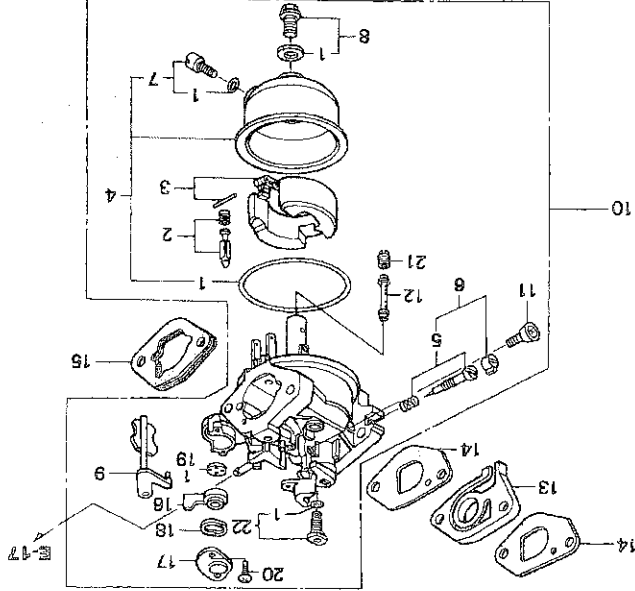

ZB60-E1400A

Ref. No.	Part No.	Description	Reqd. QTY	Serial No.	Parts catalogue code
----------	----------	-------------	-----------	------------	----------------------

1 16010-ZE0-005 GASKET SET (CARBURETOR NO.)

16010-ZE0-015 (CARBURETOR NO.)

16010-ZE0-025 (CARBURETOR NO.)

16010-ZE0-600 (CARBURETOR NO.)

2 16011-ZE0-005 VALVE SET, FLOAT

3 16013-ZE0-005 FLOAT SET

4 16015-ZE1-811 CHAMBER SET, FLOAT

16015-ZE0-831 (CARBURETOR NO.)

16015-ZE1-811 (CARBURETOR NO.)

16015-ZE0-831 (CARBURETOR NO.)

16015-ZE1-811 (CARBURETOR NO.)

16015-ZE0-831 (CARBURETOR NO.)

16015-ZE1-811 (CARBURETOR NO.)

16015-ZE0-831 (CARBURETOR NO.)

16015-ZE0-831 (CARBURETOR NO.)

16015-ZE0-831 (CARBURETOR NO.)

16015-ZE0-831 (CARBURETOR NO.)

16015-ZE0-831 (CARBURETOR NO.)

16015-ZE0-831 (CARBURETOR NO.)

16015-ZE0-831 (CARBURETOR NO.)

16015-ZE0-831 (CARBURETOR NO.)

16015-ZE0-831 (CARBURETOR NO.)

16015-ZE0-831 (CARBURETOR NO.)

16015-ZE0-831 (CARBURETOR NO.)

Ref. No.	Part No.	Description	Reqd. QTY		Serial No.	Parts catalogue code
			GXV 120 (JPN)	GXV 120 (USA)		
(4)	16015-ZH7-A21	CHAMBER SET, FLOAT (CARBURETOR NO.)	1	-	BE55B A	N2SS,SFFK,SFKR
5	16016-ZE0-005	SCREW SET, PILOT (CARBURETOR NO.)	1	-		A1,N1B,N2CA,N2F,N2T,P,PF,PFCA,S,SF,SFS,SFSK
	"	"	1	-	BB55A B	N2SS,SFFK,SFKR
	"	"	1	-	BE03A J	A1L,A14,D1,NZTA,N1,N14,N2,N2C1,N24,PFTH,SFL,SFLY,SFL1,SFTH
			-	1		
6	16016-ZH7-W01	SCREW SET (CARBURETOR NO.)	1	-		A1LA,A1L2,A12,D12,N12,N22
			1	-	BB55B A	N2SS,SFFK,SFKR
			1	-	BE56A B	A1L,A14,D1,NZTA,N1,N14,N2,N2C1,N24,PFTH,SFL,SFLY,SFL1,SFTH
7	16024-ZE1-811	SCREW SET, DRAIN (CARBURETOR NO.)	1	-		A1,A1L,A1LA,A1L2,A12,A14,D1,D12,NZTA,N1B,N12,N14,N2CA,N2C1,N2F,N2T,N22,N24,P,PF,PFCA,PFTH,S,SF,SFL,SFLY,SFL1,SFS,SFSK,SFTH
	"	"	1	-	BE03A C	N1,N2
	"	"	1	-	BE03A J	SFKR
			-	1		
	16024-ZH7-A20	(CARBURETOR NO.)	1	-		N2SS,SFFK
			1	-	BE55A B	SFKR
8	16028-ZE0-005	SCREW SET	1	1		
9	16045-ZE6-005	CHOKE SET	1	1		
10	16100-ZE6-005	CARBURETOR ASSY. (BE03A A/B)	1	-		N1,N2
			1	-	1108978	A1,D1
			1	-	2127564	A1,D1
	16100-ZE6-015	CARBURETOR ASSY. (BE03A C)	1	-		N1,N2
			1	-		N1,N2
	16100-ZE6-025	CARBURETOR ASSY. (BE03A D)	1	-		N1,N2
	16100-ZE6-035	CARBURETOR ASSY. (BE03A D/F)	1	-		N1,N2
	16100-ZE6-045	CARBURETOR ASSY. (BE03A G)	1	-	2127565	A1,D1
			1	-		N1,N1B,N2,N2CA,N2C1,N2F,N2T,PFCA,SFL,SFSK
			-	1		
	16100-ZE6-055	CARBURETOR ASSY. (BE03A H/J)	1	-		N1B,N2CA,N2F,N2T,P,PF,PFCA,S,SF,SFS,SFSK
			1	-	2485478	A1
			1	-		2509296 SFKR
			1	-	2530281	A14,NZTA,N1,N14,N2,N2C1,N24,PFTH,SFL,SFLY,SFL1,SFTH
			1	-	2485478	2530281 A1L,D1
	16100-ZE6-W00	CARBURETOR ASSY. (BE56A A)	1	-		2485477 A1L2,A12,D12,N12,N22
	16100-ZE6-W01	CARBURETOR ASSY. (BE56A B)	1	-		A1LA
			1	-	2485478	A1L2,A12,D12,N12,N22
			1	-	2530282	A1L,A14,D1,NZTA,N1,N14,N2,N2C1,N24,PFTH,SFL,SFLY,SFL1,SFTH
	16100-ZE6-V31	CARBURETOR ASSY. (BE55A B)	1	-		2530321 N2SS,SFFK
			1	-	2509297	2530321 SFKR
	16100-ZE6-V71	CARBURETOR ASSY. (BE55B A)	1	-	2530322	N2SS,SFFK,SFKR
11	16124-ZE0-005	SCREW, THROTTLE STOP	1	1		
12	16166-ZE6-015	NOZZLE, MAIN (CARBURETOR NO.)	1	-	BE03A G	A1,A1L,D1
			-	1		
	16166-ZE6-W00	(CARBURETOR NO.)	1	-		A1LA,A1L2,A12,D12,N12,N2SS,N22,P,PF,PFTH,S,SF,SFFK,SFKR,SFLY,SFS,SFTH
			1	-	BE03A H	A1,A1L,D1
	16166-ZE6-005	(CARBURETOR NO.)	1	-		BE03A A N1,N2
	16166-ZE6-015	(CARBURETOR NO.)	1	-		BE03A G N1B,N2CA,N2C1,N2F,N2T,PFCA,SFL,SFSK
			1	-	BE03A B	BE03A G N1,N2
	16166-ZE6-W00	"	1	-		A14,NZTA,N14,N24,SFL1
		(CARBURETOR NO.)	1	-	BE03A H	N1,N1B,N2,N2CA,N2C1,N2F,N2T,PFCA,SFL,SFSK
13	16211-ZE6-000	INSULATOR, CARBURETOR	1	1		
14	16212-ZE6-000	PACKING, INSULATOR	2	-		2453088 A1,A1L,D1,N1,N1B,N2,N2CA,N2C1,N2F,N2T,SFL,SFSK
			-	2		



Ref. No.	Part No.	Description	Reqd. QTY		Serial No.	Parts catalogue code
			GXV 120 (JPN)	GXV 120 (USA)		
19)	16957-ZE1-812	PACKING, FUEL COCK (CARBURETOR NO.)	1	-		A1L,A1LA,A1L2,A12,A14,D12,NZTA,N1B,N12,N14,N2CA,N2C1,N2F,N2SS,N2T,N22 N24,P,PF,PFCA,PFTH,S,SF,SFFK,SFKR,SFL,SFLY,SFL1,SFS,SFSK,SFTH
			1	-	BE03A G	A1,D1,N1,N2
20	93500-03008-0H	SCREW, PAN, 3X8 (CARBURETOR NO.)	2	-	BE03A C	BE03A F A1,D1,N1,N2
	93500-03008-1G	(CARBURETOR NO.)	2	-		BE03A H P,PF,PFTH,S,SF,SFKR,SFS,SFTH
	///	///	2	-		BE03A H A1L,A14,N1B,N14,N2CA,N2C1,N2F,N2T,N24,PFCA,SFL,SFSK
	///	///	2	-	BE03A G	BE56A A A1L2,A12,D12,N12,N22
	///	///	-	-		BE03A H A1,D1,N1,N2
	93500-03006-1H	SCREW, PAN, 3X6 (CARBURETOR NO.)	2	-		BE03A H
	///	///	2	-	BE03A J	A1LA,NZTA,N2SS,SFFK,SFLY,SFL1
	///	///	2	-		A1,A1L,A14,D1,N1,N1B,N14,N2,N2CA,N2C1,N2F,N2T,N24,P,PF,PFCA,PFTH,S,SF
	///	///	2	-	BE56A B	SFKR,SFL,SFS,SFSK,SFTH
	///	///	2	-		A1L2,A12,D12,N12,N22
21	99101-124-0600	JET, MAIN, #60 (CARBURETOR NO.)	(1)	-	BE03A G	A1,A1L,D1,N1,N1B,N2,N2CA,N2C1,N2F,N2T,PFCA,SFL,SFSK
	99101-124-0620	JET, MAIN, #62 (CARBURETOR NO.)	(1)	-	BE03A G	A1,A1L,D1,N1,N1B,N2,N2CA,N2C1,N2F,N2T,PFCA,SFL,SFSK
	99101-124-0650	JET, MAIN, #65 (CARBURETOR NO.)	1	-	BE03A G	A1,A1L,D1,N1,N1B,N2,N2CA,N2C1,N2F,N2T,PFCA,SFL,SFSK
	99101-ZH8-0520	JET, MAIN, #52 (CARBURETOR NO.)	(1)	-	BE03A J	N2SS
	///	///	(1)	-		N1,N2
	///	///	(1)	-	BE03A J	BE03A J A14,NZTA,N14,N2C1,N24,PFTH,SFL,SFLY,SFL1,SFTH
	///	///	(1)	-	BE03A H	BE03A J A1L,D1
	99101-ZH8-0550	JET, MAIN, #55 (CARBURETOR NO.)	(1)	-	BE03A J	N2SS
	///	///	(1)	-		N1,N2
	///	///	(1)	-	BE03A J	BE03A J A14,NZTA,N14,N2C1,N24,SFL,SFL1
	///	///	(1)	-	BE06A J	PFTH,SFLY,SFTH
	///	///	(1)	-	BE03A H	BE03A J A1L,D1
	99101-ZH8-0580	JET, MAIN, #58 (CARBURETOR NO.)	1	-	BE03A J	N1,N2
	///	///	1	-	BE03A J	BE03A J A14,NZTA,N14,N2C1,N24,PFTH,SFL,SFLY,SFL1,SFTH
	///	///	1	-	BE03A H	BE03A J A1L,D1
	99101-ZH7-0520	JET, MAIN, #52 (CARBURETOR NO.)	(1)	-	BE03A H	A1LA,A1L2,A12,D12,N12,N22,P,PF,S,SF,SFFK,SFKR,SFS
	///	///	(1)	-	BE03A H	A1,N1B,N2CA,N2F,N2T,PFCA,SFSK
	///	///	(1)	-	BE56A B	A1L,A14,D1,NZTA,N14,N2C1,N24,PFTH,SFL,SFLY,SFL1,SFTH
	///	///	(1)	-	BE03A H	BE03A H N1,N2
	99101-ZH7-0550	JET, MAIN, #55 (CARBURETOR NO.)	(1)	-	BE03A H	A1LA,A1L2,A12,D12,N12,N22,P,PF,S,SF,SFFK,SFKR,SFS
	///	///	(1)	-	BE03A H	A1,N1B,N2CA,N2F,N2T,PFCA,SFSK
	///	///	(1)	-	BE56A B	A1L,A14,D1,NZTA,N14,N2C1,N24,PFTH,SFL,SFLY,SFL1,SFTH
	///	///	(1)	-	BE03A H	BE03A H N1,N2
	99101-ZH7-0580	JET, MAIN, #58 (CARBURETOR NO.)	1	-	BE03A H	A1LA,A1L2,A12,D12,N12,N2SS,N22,P,PF,S,SF,SFFK,SFKR,SFS
	///	///	1	-	BE03A H	A1,N1B,N2CA,N2F,N2T,PFCA,SFSK
	///	///	1	-	BE56A B	A1L,A14,D1,NZTA,N14,N2C1,N24,SFL,SFL1
	///	///	1	-	BF56A B	PFTH,SFLY,SFTH
	///	///	1	-	BE03A H	BE03A H N1,N2
22	99204-ZE0-0350	JET SET, PILOT, #35 (CARBURETOR NO.)	1	-	BE03A G	A1,A1L,D1,N1,N1B,N2,N2CA,N2C1,N2F,N2T,PFCA,SFL,SFSK
	99204-ZE2-0380	JET SET, PILOT, #38 (CARBURETOR NO.)	1	-		N2SS,P,PF,PFTH,S,SF,SFFK,SFKR,SFLY,SFS,SFTH
	///	///	1	-		A1LA,A1L2,A12,A14,D12,NZTA,N12,N14,N22,N24,SFL1
	///	///	1	-	BE03A H	A1,A1L,D1,N1,N1B,N2,N2CA,N2C1,N2F,N2T,PFCA,SFL,SFSK





E-15 AIR CLEANER

Service Item F.R.T.

0.1 ELEMENT, AIR CLEANER
 0.2 CASE COMP., AIR CLEANER
 .TUBE, BREATHER
 .TUBE, 8X180
 .JOINT, TUBE

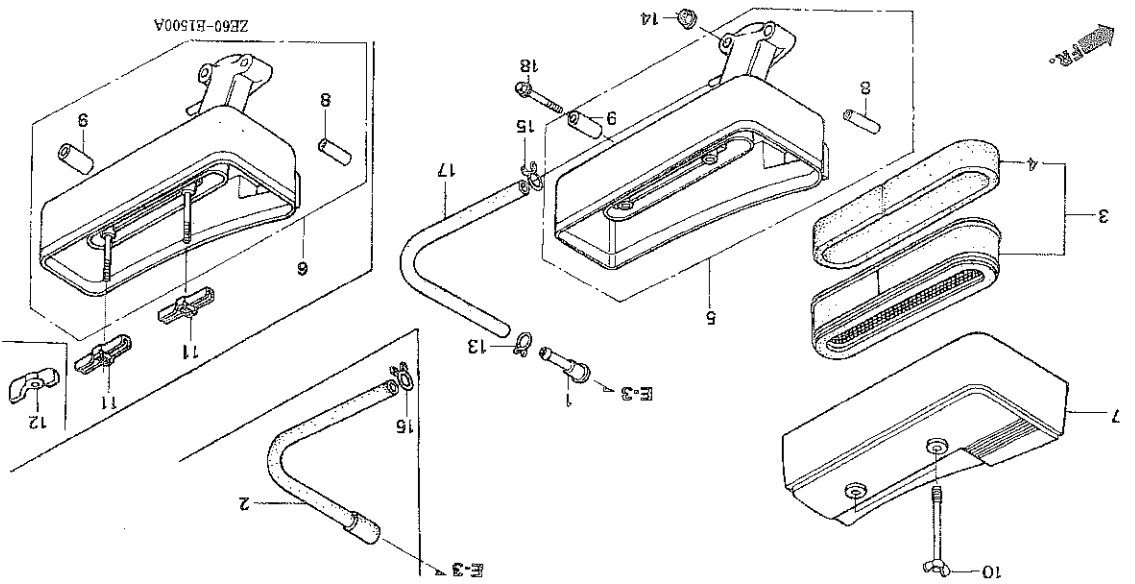

Ref. No.	Part No.	Description	Reqd. QTY	Serial No.	Parts catalogue code
1	12150-ZE6-000	JOINT, TUBE	1	2010135 N1B	
2	15721-ZE6-000	TUBE, BREATHER	1	1680981 A1,D1,N1,N2	
3	17210-ZE6-003	ELEMENT, AIR CLEANER	1	2010136	
4	17218-888-003	FILTER, OUTER	1		
5	17220-ZE6-000	CASE COMP., AIR CLEANER	1	1620114 A1,D1,N1,N2	
6	17220-ZE6-020	CASE COMP., AIR CLEANER	1	1620115	
7	17231-ZE6-000	COVER, AIR CLEANER	1	2195322	
8	17238-ZE1-000	COLLAR, AIR CLEANER	1		
9	17239-ZE6-300	COLLAR B, AIR CLEANER	1	1620115	
10	17291-6F8-000	BOLT, ELEMENT SETTING	2	2195321 A1,D1,N1,N2	

1	12150-ZE6-000	JOINT, TUBE	1	2010135 N1B	
2	15721-ZE6-000	TUBE, BREATHER (180MM)	1	1680981 A1,D1,N1,N2	
3	17210-ZE6-003	TUBE, 8X180(95005-80001-30M)	1	2010135 A1,D1	
4	17218-888-003	FILTER, OUTER	1	A1LA,A14,N2TA,N1,N1B,N14,N2,N2CA,N2C1,N2F,N2SS,N2T,N24,P,PF,PFCA,PPTH,S,SF,SFFK,SFKR,SFL,SFLY,SFL1,SFS,SFSK,SFTH	
5	17220-ZE6-000	CASE COMP., AIR CLEANER	1	1620114 A1,D1,N1,N2	
6	17220-ZE6-020	CASE COMP., AIR CLEANER	1	1620115	
7	17231-ZE6-000	COVER, AIR CLEANER	1	2195322	
8	17238-ZE1-000	COLLAR, AIR CLEANER	1		
9	17239-ZE6-300	COLLAR B, AIR CLEANER	1	1620115	
10	17291-6F8-000	BOLT, ELEMENT SETTING	2	2195321 A1,D1,N1,N2	

E-15

AIR CLEANER

D 7

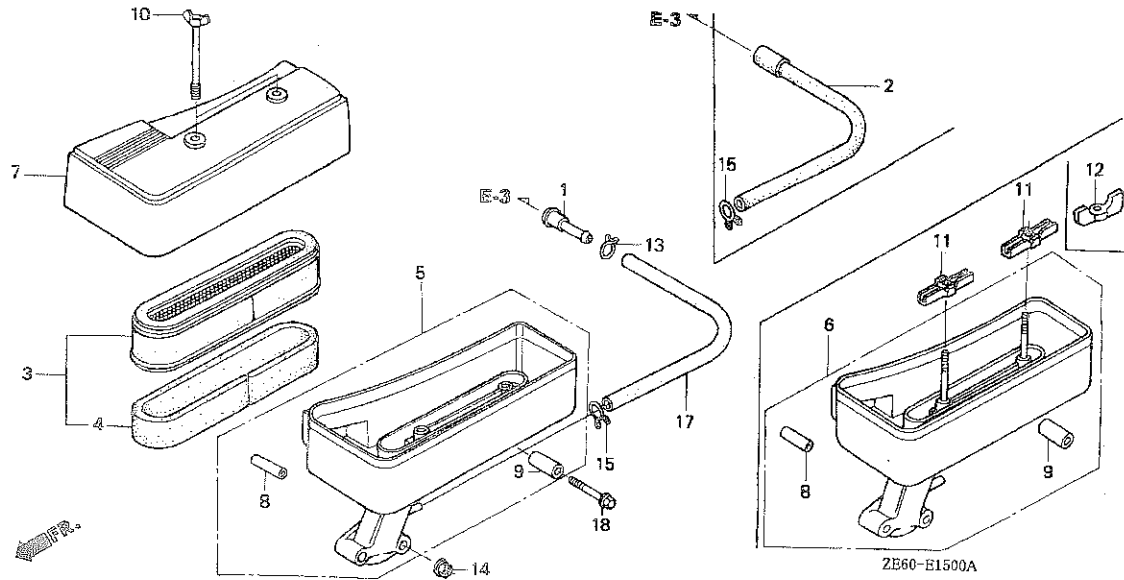

Ref. No.	Part No.	Description	Reqd. QTY		Serial No.	Parts catalogue code
			GXV 120 (JPN)	GXV 120 (USA)		
11	90203-ZA0-800	NUT, WING, 6MM(BLACK)	2	-	2398026 A1L,N2T	
	90203-PB2-000	NUT, AIR CLEANER COVER (DACRO COATING)	2	-	2195322 2398026 A1,D1,N1,N2	
	90203-ZA0-800	NUT, WING, 6MM(BLACK)	2	-	2398027 2429892 N1B,N2CA,N2C1,SFL,SFSK	
			2	-	2429892 A1,A1L,D1,N1,N2,N2T	
			2	-	2429893 N2F	
12	90325-044-000	NUT, TOOL BOX SETTING	2	-	A1,A1L,D1,N1,N1B,N2,N2CA,N2C1,N2T,SFL,SFSK	
13	90652-MB1-000	CLIP, TUBE	1	-	A1LA,A1L2,A12,A14,D12,NZTA,N12,N14,N2SS,N22,N24,P,PF,PFCA,PFTH,S,SF	
			1	-	SFFK,SFKR,SFLY,SFL1,SFS,SFTH	
			1	-	N2CA,N2C1,N2F,N2T,PFCA,SFL,SFSK	
			1	-	2010136 A1,D1,N1,N2	
			1	-	2010136 2010135 N1B	
	95002-70000	CLIP, TUBE (C11)	1	-	A1L2,N12,N22	
14	94050-06000	NUT, FLANGE, 6MM	2	2	1680982 2010135 A1,D1,N1,N2	
15	95002-02120	CLIP, TUBE (B12)	1	-	A1,A1L,D1,N1,N1B,N2,N2CA,N2C1,N2F,N2T,SFL,SFSK	
			-	1		
17	95005-80180-30	TUBE, 8X180(95005-80001-30M)	1	-	2010135 N1B	
			1	-	1680982 2010135 N1,N2	
18	95700-06035-00	BOLT, FLANGE, 6X35	1	-	A1,D1,N1,N2	
			-	1		
	95701-06035-00		1	-	A1L,A1LA,A1L2,A12,A14,D12,NZTA,N1B,N12,N14,N2CA,N2C1,N2F,N2SS,N2T,N22	
					N24,P,PF,PFCA,PFTH,S,SF,SFFK,SFKR,SFL,SFLY,SFL1,SFS,SFSK,SFTH	

MUFFLER

D 9

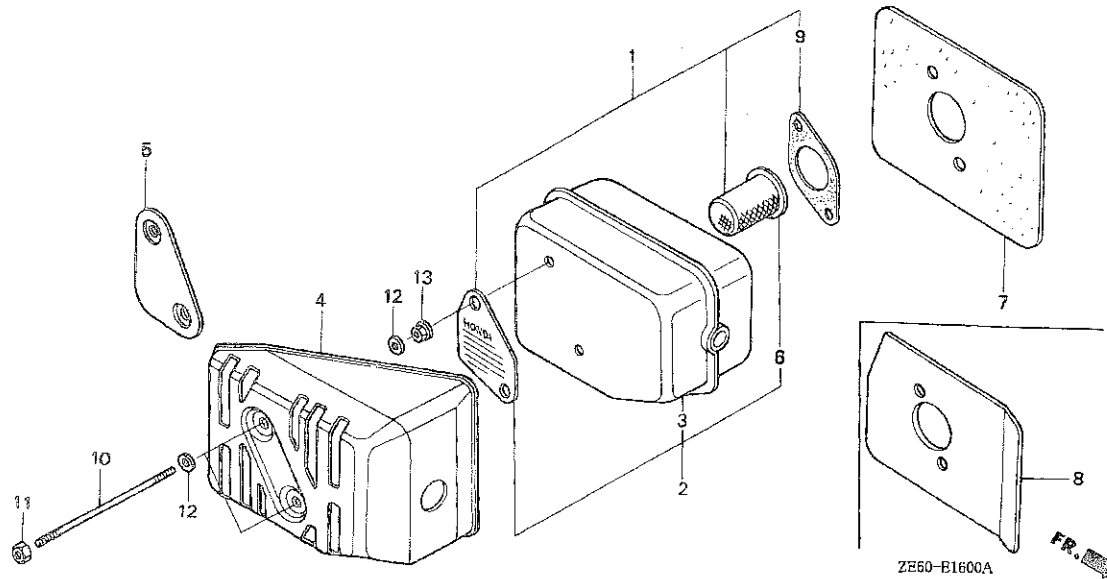

Ref. No.	Part No.	Description	Reqd. QTY		Serial No.	Parts catalogue code
			GXV 120 (JPN)	GXV 120 (USA)		
7	18381-ZE6-000	GASKET, MUFFLER	1	1	2195321	A1,D1,N1,N2
8	18381-ZE6-010	GASKET, MUFFLER	1	1	2416570	A1L,N1B,N2CA,N2C1,N2F,N2T,SFL,SFSK
	18381-ZE6-800		1	1	2195322	2416570 A1,D1,N1,N2
			1	1		N2SS,P,PF,PFTH,S,SF,SFFK,SFKR,SFLY,SFS,SFTH
			1	1		A1LA,A1L2,A12,A14,D12,NZTA,N12,N14,N22,N24,PFCA,SFL1
9	18381-ZE6-820	GASKET, MUFFLER	1	1	2416571	A1,A1L,D1,N1,N1B,N2,N2CA,N2C1,N2F,N2T,SFL,SFSK
	18381-ZE6-810		(1)	1		A14,NZTA,N1,N1B,N14,N2,N2CA,N2C1,N2F,N2SS,N2T,N24,PFCA,PFTH,SFFK,SFKR
	18381-ZE6-820		(1)	1		SFL,SFLY,SFL1,SFSK,SFTH
			1	1		P,PF,S,SF,SFS
			1	1	2519465	A1LA
			1	1		A1L2,D12
	18381-ZE6-810		(1)	1		A1,A1L,A12,D1,N12,N22
			(1)	1	2519464	A1L2,D12
10	90013-ZE6-000	BOLT, STUD, 6X93	2	(1)		N1,N2
	90013-ZE7-000	BOLT, STUD, 6X82	2	2		A1,A1L,A12,A14,D1,NZTA,N1,N12,N14,N2,N2SS,N2T,N22,N24,P,PF,PFCA,PFTH
	90013-ZE6-710	BOLT, STUD, 6X90	2	2		S,SF,SFFK,SFKR,SFL,SFLY,SFL1,SFS,SFSK,SFTH
	90048-ZC3-000	BOLT, STUD, 6X85	2	2		N1B,N2CA,N2C1,N2F
	90013-ZE6-700	BOLT, STUD, 6X81	-	2		A1LA,A1L2,D12
11	90343-ZE6-000	NUT, SELF-LOCK, 6MM	2	2		
12	91602-ZE6-710	PACKING, PROTECTOR	4	4	2444797	N1B,N2CA,N2C1,N2F
	91602-ZE6-711		4	4	2444798	N1B,N2CA,N2C1,N2F
13	94050-06000	NUT, FLANGE, 6MM	2	2		N1B,N2CA,N2C1,N2F



11	90014-952-000	BOLT, FLANGE, 6X14(C1200)	2	2	
12	90455-896-700	WASHER, TANK MOUNTING	1	1	
13	90682-959-661	CLIP B, CABLE	1	1	
14	95002-02080	CLIP, TUBE (B8)	1	1	
15	95002-70000	CLIP, TUBE (C11)	1	1	
16	95900-08050-00	BOLT, FLANGE, 8X50	1	1	A1,D1,N1,N2
9	17622-888-010	SPONGE, FUEL CAP BREATHER	1	1	
10	17624-ZE6-000	PACKING, FUEL CAP	1	1	
6	17517-ZE6-000	STAY COMP., TANK	1	1	
7	17518-ZE6-000	COLLAR, TANK SETTING	1	1	
8	17620-ZE6-000	CAP ASSY., FUEL TANK	1	1	
3	17512-ZE6-000	TUBE, FUEL	1	1	
4	17515-ZE6-000	RUBBER, TANK MOUNTING	1	1	
5	17516-896-700	RUBBER B, TANK MOUNTING	2	2	
1	16952-ZE6-000	STRAINER, FUEL	1	1	
2	17510-ZE6-000	TANK, FUEL	1	1	
17510-ZE6-100			1	1	
1617086 A1,D1,N1,N2			1	1	
A1L,A1LA,A1L2,A12,A14,D12,N2TA,N1B,N12,N14,N2CA,N2C1,N2F,N2SS,N2T,N22					
N24,P,PF,PFCA,PFTH,S,SF,SFFK,SFKR,SFL,SFLY,SFL1,SFS,SFSK,SFTH					
1617087			1	1	
A1,D1,N1,N2					
1617086 A1,D1,N1,N2			1	1	
A1L,A1LA,A1L2,A12,A14,D12,N2TA,N1B,N12,N14,N2CA,N2C1,N2F,N2SS,N2T,N22					
N24,P,PF,PFCA,PFTH,S,SF,SFFK,SFKR,SFL,SFLY,SFL1,SFS,SFSK,SFTH					
1617087			1	1	
A1,D1,N1,N2					

Ref. No.	Part No.	Description	Reqd QTY	Serial No.	Parts catalogue code
----------	----------	-------------	----------	------------	----------------------

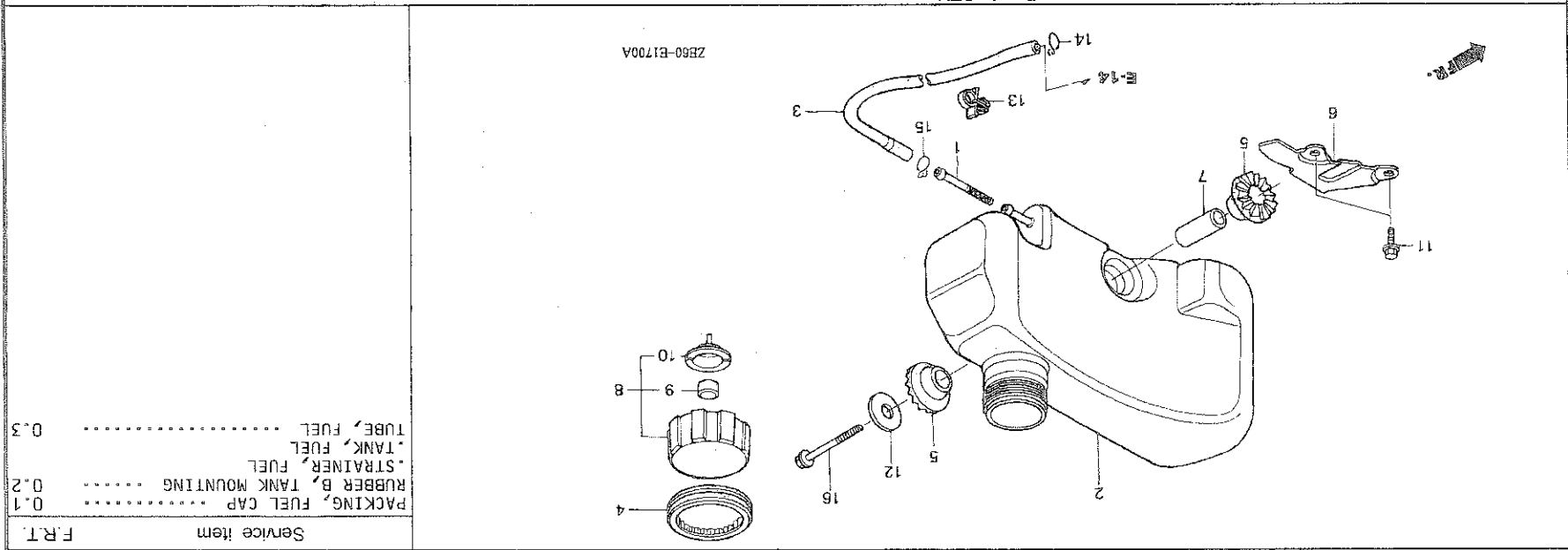

F.R.T. Service item

0.1 PACKING, FUEL CAP

0.2 RUBBER B, TANK MOUNTING

0.3 TUBE, FUEL

0.3 TANK, FUEL

0.3 STRAINER, FUEL



FUEL TANK



E-17

FUEL TANK

D11

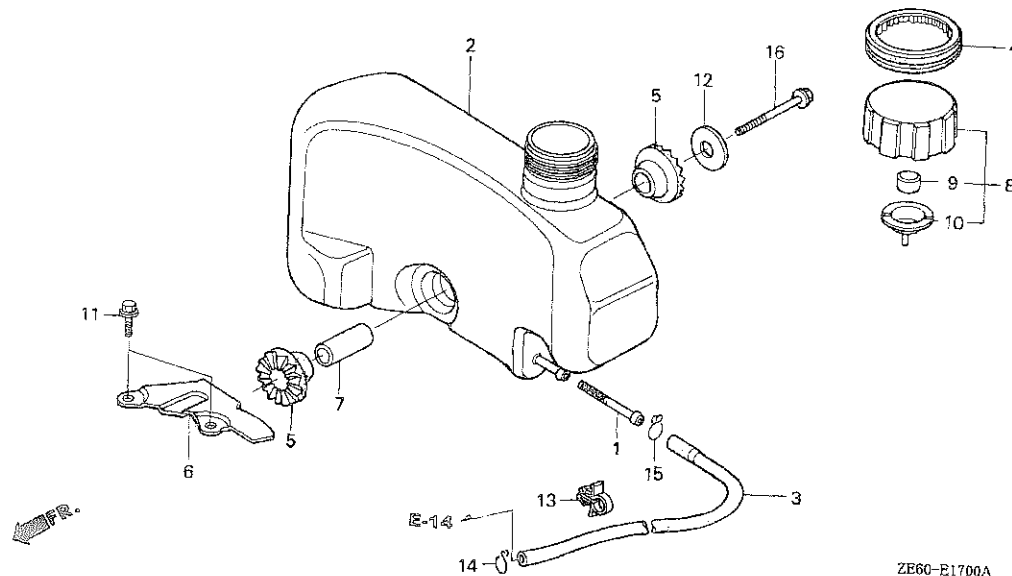

Ref. No.	Part No.	Description	Reqd. QTY		Serial No.	Parts catalogue code
			GXV 120 (JPN)	GXV 120 (USA)		
16)	95701-08050-00	BOLT, FLANGE, 8X50	1	-		A1L,A1LA,A1L2,A12,A14,D12,NZTA,N1B,N12,N14,N2CA,N2C1,N2F,N2SS,N2T,N22,N24,P,PF,PFCA,PFTH,S,SF,SFFK,SFKR,SFL,SFLY,SFL1,SFS,SFSK,SFTH

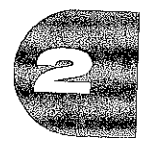

FLYWHEEL

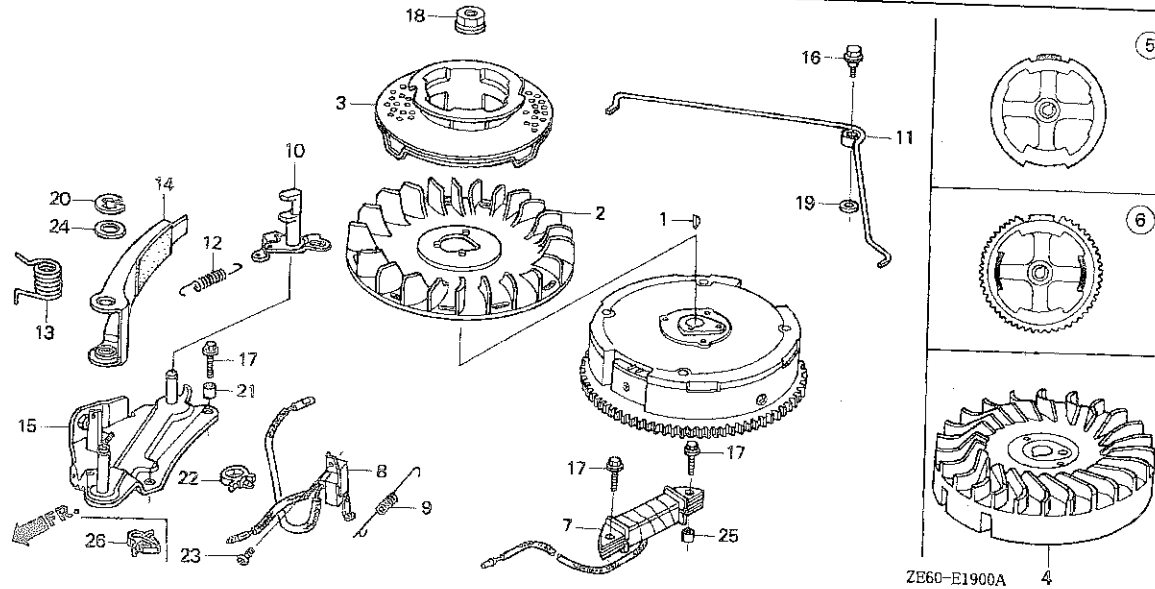

Ref. No.	Part No.	Description	Reqd. QTY		Serial No.	Parts catalogue code
			GxV 120 (JPN)	GxV 120 (USA)		
11)	43145-ZE6-020	ROD, THROTTLE RETURN	1	-	-	A1LA,A1L2,A12,A14
12	75112-ZE6-000	SPRING, BRAKE	1	-	2467479	A1,A1L
13	75113-ZE6-000	SPRING, BRAKE RETURN	1	1	-	A1,A1#,A1L,A1LA,A1L2,A12,A14,N2C1
14	75120-ZE6-003	BRAKE COMP.	1	1	-	A1,A1#,A1L,A1LA,A1L2,A12,A14,N2C1
	75120-ZE6-013	-	1	2314887	A1
15	75130-ZE6-000	BASE COMP., BRAKE	1	-	2314888	A1#
			1	-		A1L,A1LA,A1L2,A12,A14,N2C1
			1	1		A1
16	90015-ZE6-000	BOLT, FLANGE, 6MM	1	1	-	A1,A1#,A1L,A1LA,A1L2,A12,A14,N2C1
17	90018-ZE1-000	BOLT, FLANGE, 6X23 (CT200)	2	-	-	A1,A1#,A1L,A1LA,A1L2,A12,A14,N2C1
	95701-06022-00	BOLT, FLANGE, 6X22	-	2	-	A1,A1L,A1LA,A1L2,A12,A14,N2C1,SFS,SFSK
18	90201-878-003	NUT, SPECIAL, 14MM	1	1	-	A1#
19	90417-360-000	WASHER, DRUM STOPPER	1	-	-	A1LA,A1L2,A12,A14,N2C1
20	90653-723-000	E-RING, 10MM	1	-	2361880	A1
			1	1		A1,A1#,A1L,A1LA,A1L2,A12,A14,N2C1
21	90702-ZE6-000	DOWEL PIN, 8X9	2	2	-	A1,A1#,A1L,A1LA,A1L2,A12,A14,N2C1
22	91504-750-003	CLIP, WIRE HARNESS	1	-	-	A1LA,A1L2,A12,A14,N2C1
23	93500-04008-0A	SCREW, PAN, 4X8	1	-	2359985	A1
24	94102-12800	WASHER, PLAIN, 12MM	1	1	-	A1,A1#,A1L,A1LA,A1L2,A12,A14,N2C1
25	94301-08140	DOWEL PIN, 8X14	1	1	-	A1,A1#,A1L,A1LA,A1L2,A12,A14,N2C1
			2	-	-	SFS,SFSK
26	90649-Z69-T41	CLIP, WIRE HARNESS	1	-	2330203	2359984 A1



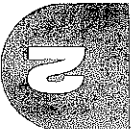

E-21 STARTER MOTOR D14

Service item	F.R.T.
MOTOR UNIT, STARTER	0.4
BRACKET, FR.	0.5
BRUSH SET	
COVER COMP., GEAR	
GEAR, PINION	
HOLDER, BRUSH	
PACKING	0.6
ROTOR ASSY.	
SHAFT SET, GEAR	
YOKE ASSY.	
BEARING, RADIAL BALL, 6292	0.7

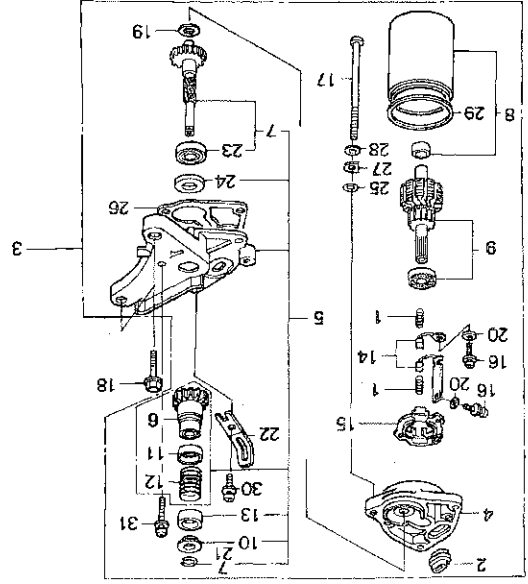

Ref. No.	Part No.	Description	Reqd. QTY	Serial No.	Parts catalogue code
			GXX		
			GXX		
			120		
			120		
			(JPN)		
			(USA)		

1	31204-187-701	SPRING, BRUSH	2	SFS,SFSK	
2	31207-187-701	GROMMET	1	SFS,SFSK	
3	31210-ZE6-043	MOTOR UNIT, STARTER	1	SFS,SFSK	
4	31211-ZE6-003	BRACKET, FR.	1	SFS,SFSK	
5	31212-ZE6-023	COVER COMP., GEAR	1	SFS,SFSK	
6	31214-ZE6-013	GEAR, PINION (16T)	1	SFS,SFSK	
7	31215-ZE6-023	SHAFT SET, GEAR	1	SFS,SFSK	
8	31216-ZE6-003	YOKE ASSY.	1	SFS,SFSK	
9	31217-ZE6-013	ROTOR ASSY.	1	SFS,SFSK	
10	31221-ZE6-003	PIECE A, STOPPER	1	SFS,SFSK	
11	31222-ZE6-003	PIECE B, STOPPER	1	SFS,SFSK	
12	31223-ZE6-013	SPRING, RETURN	1	SFS,SFSK	
13	31224-ZE6-003	COVER, SPRING	1	SFS,SFSK	
14	31226-ZE6-003	BRUSH SET	1	SFS,SFSK	
15	31227-ZE6-003	HOLDER, BRUSH	1	SFS,SFSK	
16	90010-187-701	SCREW-WASHER, 3X8	2	SFS,SFSK	
17	90012-ZE6-003	BOLT, SETTING	2	SFS,SFSK	
18	90017-883-000	BOLT, FLANGE, 6X32	2	SFS,SFSK	
19	90401-ZE6-003	WASHER, PINION	1	SFS,SFSK	
20	90501-187-701	WASHER, SPECIAL	2	SFS,SFSK	
21	90601-ZE6-003	CIRCLIP, 7.1MM	1	SFS,SFSK	
22	90631-ZE6-003	CLAMPER, CORD	1	SFS,SFSK	
23	91001-ZE6-003	BEARING, RADIAL BALL, 6292	1	SFS,SFSK	
24	91201-ZE6-003	OIL SEAL	1	SFS,SFSK	
25	91301-ZE6-003	O-RING	2	SFS,SFSK	

E-21

STARTER MOTOR

D15

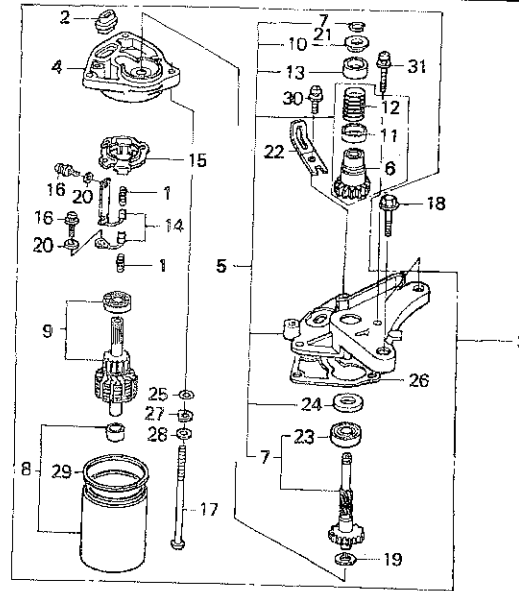

ZE60-E2100A

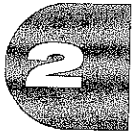

Ref. No.	Part No.	Description	Reqd. QTY		Serial No.	Parts catalogue code
			GXV 120 (JPN)	GXV 120 (USA)		
26	91401-ZE6-013	GASKET	1	-	-----	SFS,SFSK
27	91402-ZE6-003	WASHER, SPECIAL	2	-	-----	SFS,SFSK
28	91403-ZE6-003	WASHER, SPRING	2	-	-----	SFS,SFSK
29	91601-ZE6-003	PACKING	1	-	-----	SFS,SFSK
30	93892-05016-08	SCREW-WASHER, 5X16	2	-	-----	SFS,SFSK
31	93892-05032-08	SCREW-WASHER, 5X32	1	-	-----	SFS,SFSK



E-22 CONTROL D16

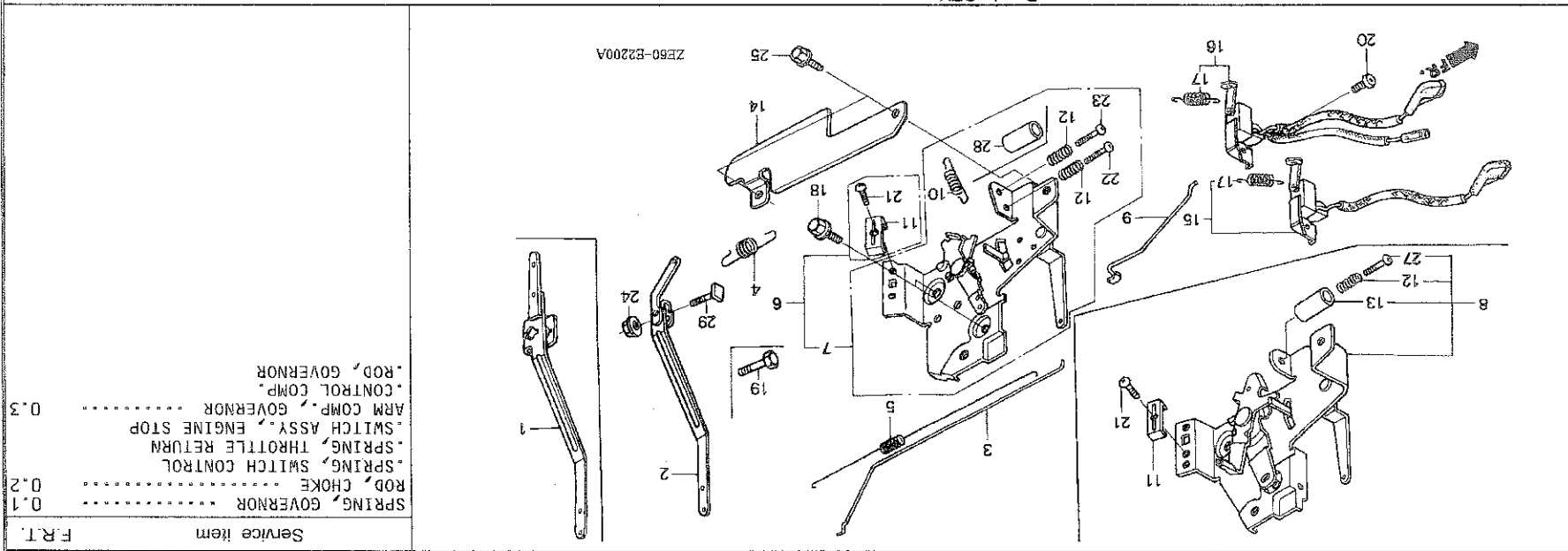

Ref. No.	Part No.	Description	Reqd. QTY	Serial No.	Parts catalogue code
----------	----------	-------------	-----------	------------	----------------------

1	16551-ZE6-U40	ARM COMP., GOVERNOR (C,G)	1	N2CA,N2C1	
2	16551-ZE6-000	ARM COMP., GOVERNOR	1	A1,A1L,A1LA,A1L2,A12,A14,D1,D12,N2A,N1,N1B,M12,N14,N2,N2F,N2SS,N2T,N2Z,N24,P,PF,PFA,PFTH,S,SF,SFFK,SFKR,SFL,SFL1,SFL2,SFL3,SFTH	
3	16555-ZE6-000	ROD, GOVERNOR	1	A1,A1L,A1LA,A1L2,A12,A14,D1,D12,N1,N12,N14,N2,N22,N24	
4	16561-ZE6-640	SPRING, GOVERNOR	1	2478683 N2CA 2530601 N2TA	
5	16562-ZE6-000	SPRING, THROTTLE RETURN	1	2478684 N2CA 2530602 N2TA	
6	16570-ZE6-U50	CONTROL COMP.	1	N1B,N2C1,N2F	
7	16570-ZE6-020	CONTROL COMP.	1	2478684 N2CA 2380736 N2T	
8	16570-ZE6-640	CONTROL COMP.	1	2478683 N2CA A1,A1L,A1LA,A1L2,A12,A14,D1,D12,N1,N12,N2,N22	
			1	2494014 PFCB,SFL	
			1	SFL1,SFL2	
			1	2494013 PFCB,SFL	
			1	N2TA	
			1	2380737 N2T	
			1	N2SS,P,PF,PFA,PFTH,S,SF,SFFK,SFKR,SFL,SFL1,SFL2,SFL3,SFTH	
			1	2530602 N2TA	
			1	16570-ZE6-810	
			1	BASE COMP., CONTROL (EN)	
			1	2494014 PFCB,SFL	
			1	SFL1,SFL2	
			1	2494013 PFCB,SFL	
			1	N2TA	
			1	2530602 N2TA	
			1	16570-ZE6-820	
			1	A14,N14,N24	

CONTROL

Ref. No.	Part No.	Description	Reqd. QTY		Serial No.	Parts catalogue code
			GxV 120 (JPN)	GxV 120 (USA)		
9	16573-ZE6-000 16573-ZE6-010	ROD, CHOKE	1	-	1039556	N1,N2
			1	-		A1,A1L,A1LA,A1L2,A12,A14,D1,D12,NZTA,N1B,N12,N14,N2CA,N2C1,N2F,N2SS,N2T,N22,N24,P,PF,PFCA,PFTH,S,SF,SFFK,SFKR,SFL,SFLY,SFL1,SFS,SFSK,SFTH
10	16574-ZG9-M00	SPRING, LEVER	1	-	1039557	N1,N2
			1	-	2380737	N2SS,P,PF,PFCA,PFTH,S,SF,SFFK,SFKR,SFL,SFLY,SFL1,SFS,SFSK,SFTH
			1	-	2530602	N2T
			1	-		NZTA
11	16576-891-000	HOLDER, CABLE	1	1		
12	16584-883-300	SPRING, CONTROL ADJUSTING	1	-		A1,A1L,A1LA,A1L2,A12,A14,D1,D12,N1,N12,N14,N2,N22,N24
			1	-	2380736	N2T
			1	-	2478683	N2CA
			1	-	2530601	NZTA
			-	1		
			2	-		N1B,N2C1,N2F,N2SS,P,PF,PFCA,PFTH,S,SF,SFFK,SFKR,SFL,SFLY,SFL1,SFS,SFSK,SFTH
			2	-	2380737	N2T
			2	-	2478684	N2CA
			2	-	2530602	NZTA
13	16599-ZG1-M10	COLLAR, STOPPER	1	-		A14,N14,N24
14	17100-ZE6-000	PROTECTOR, CONTROL	1	-		A1L,A1LA,A1L2,A12,D1,D12,NZTA,N1,N1B,N12,N14,N2,N2F,N2SS,N2T,N22,N24
			1	-	2455958	P,PF,PFCA,PFTH,S,SF,SFFK,SFKR,SFL,SFLY,SFL1,SFS,SFSK,SFTH
			-	1		A1
15	36100-ZE6-003	SWITCH ASSY., ENGINE STOP	1	-		N1B,N2C1,N2F,N2T,P,PF,PFCA,PFTH,S,SF,SFFK,SFKR,SFL,SFLY,SFL1,SFTH
16	36100-ZE6-641	SWITCH ASSY., ENGINE STOP	1	-		A1,A1L,A1LA,A1L2,A12,A14,D1,D12,NZTA,N1,N12,N14,N2,N2CA,N2SS,N22,N24
	36100-ZE6-801		1	-		SFS,SFSK
17	36120-ZE6-010	SPRING, SWITCH CONTROL	1	-		A14,N2TA,N1,N1B,N14,N2,N2CA,N2C1,N2F,N2SS,N2T,N24,P,PF,PFCA,PFTH,S,SF,SFFK,SFKR,SFL,SFLY,SFL1,SFS,SFSK,SFTH
			1	-		A1,A1L,A1LA,A1L2,A12,D1,D12,N12,N22
18	90014-952-000	BOLT, FLANGE, 6X14(CT200)	-	1		
			2	-		A1,A1L,A1LA,A1L2,A12,A14,D1,D12,N1,N12,N14,N2,N22,N24
			2	-	2478683	N2CA
			2	-	2530601	NZTA
	90013-883-000	BOLT, FLANGE, 6X12(CT200)	-	2		
			2	-		N1B,N2C1,N2F,N2SS,N2T,P,PF,PFCA,PFTH,S,SF,SFFK,SFKR,SFL,SFLY,SFL1,SFS,SFSK,SFTH
			2	-	2478684	N2CA
			2	-	2530602	NZTA
19	92000-06020-0A	BOLT, HEX., 6X20	1	-		A1,D1,N1,N2
20	93500-04008-0A	SCREW, PAN, 4X8	1	1	1677159	
21	93500-05010-0A	SCREW, PAN, 5X10	1	-		N2F
	93500-05016-0A	SCREW, PAN, 5X16	1	-		A1,A1L,A1LA,A1L2,A12,A14,D1,D12,NZTA,N1,N1B,N12,N14,N2,N2CA,N2C1,N2SS,N2T,N22,N24,P,PF,PFCA,PFTH,S,SF,SFFK,SFKR,SFL,SFLY,SFL1,SFS,SFSK,SFTH
22	93500-05020-0A	SCREW, PAN, 5X20	-	1		
			1	-		N1B,N2C1,N2F,N2SS,N2T,P,PF,PFCA,PFTH,S,SF,SFFK,SFKR,SFL,SFLY,SFL1,SFS,SFSK,SFTH
			1	-	2478684	N2CA
			1	-	2530602	NZTA
			1	-		N1B,N2C1,N2F,N2SS,P,PF,PFTH,S,SF,SFFK,SFKR,SFS,SFSK,SFTH
			1	-	2380737	N2T
			1	-	2478684	N2CA
			1	-	2530602	NZTA
23	93500-05025-0A	SCREW, PAN, 5X25	1	-		2494013 PFCA,SFL

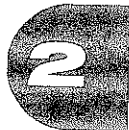

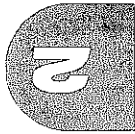

E-22 CONTROL E 2

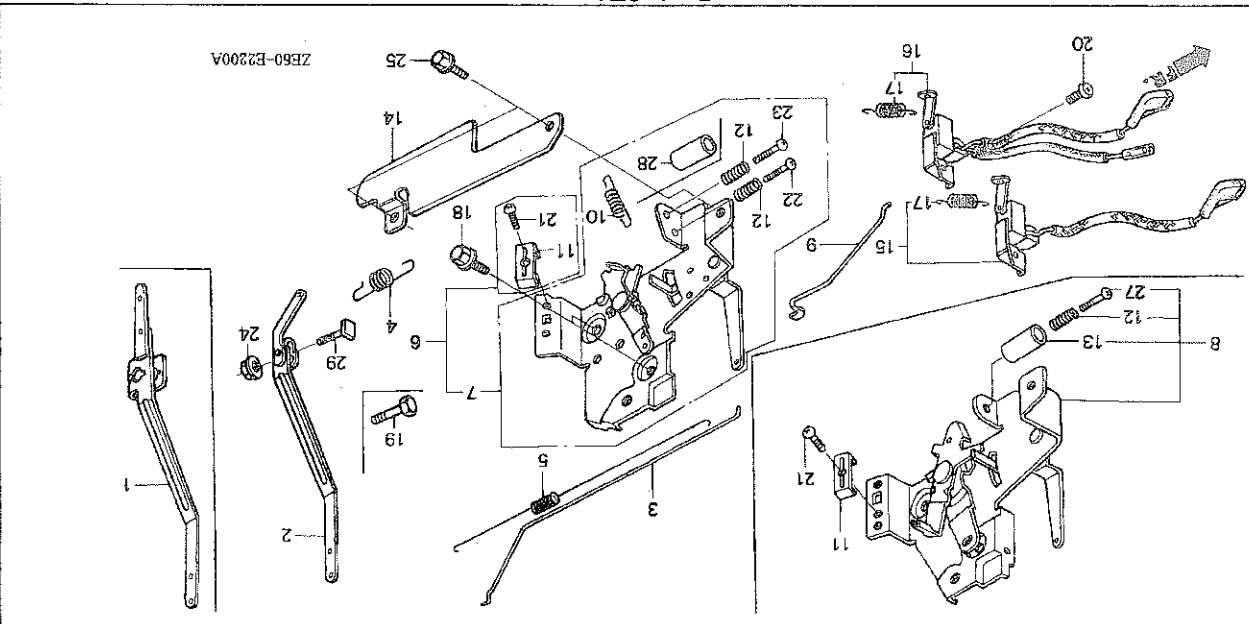

Ref. No.	Part No.	Description	Reqd. QTY	Serial No.	Parts catalogue code
23)	90016-Z69-N30	SCREW, RECESSED, 5X25	1	SFLY,SFL1	
24	94050-06000	NUT, FLANGE, 6MM	1	2494014	PFCA,SFL
25	95700-06010-00	BOLT, FLANGE, 6X10	2	D1,N1,N2	
			2	2455958 A1	
	95701-06010-00		2		A1L,A1LA,A1L2,A12,D12,N2TA,N1B,N12,N14,N2F,N2SS,N2T,M22,N24,P,PF,PFCA
27	93500-05020-0A	SCREW, PAN, 5X20	1		A1,A1L,A1LA,A1L2,A12,D1,D12,M12,N22
	93500-05025-0A	SCREW, PAN, 5X25	1		N1,N2
			1	2478683 N2CA	
			1	2530601 N2TA	
	90016-ZF5-W40	SCREW, RECESSED, 5X20	1	A14,N14,N24	
			1	SFLY	
28	16599-Z61-M10	COLLAR, STOPPER	1		A1L,A1LA,A1L2,A12,A14,D12,N2TA,N1B,N12,N14,N2CA,N2C1,N2F,N2SS,N2T,N22
29	90015-ZE5-010	BOLT, GOVERNOR ARM	1		N24,P,PF,PFCA,PFTH,S,SF,SFFK,SFKR,SFL,SFLY,SFL1,SFS,SFSK,SFTH
			1	1677160	A1,D1,N1,N2

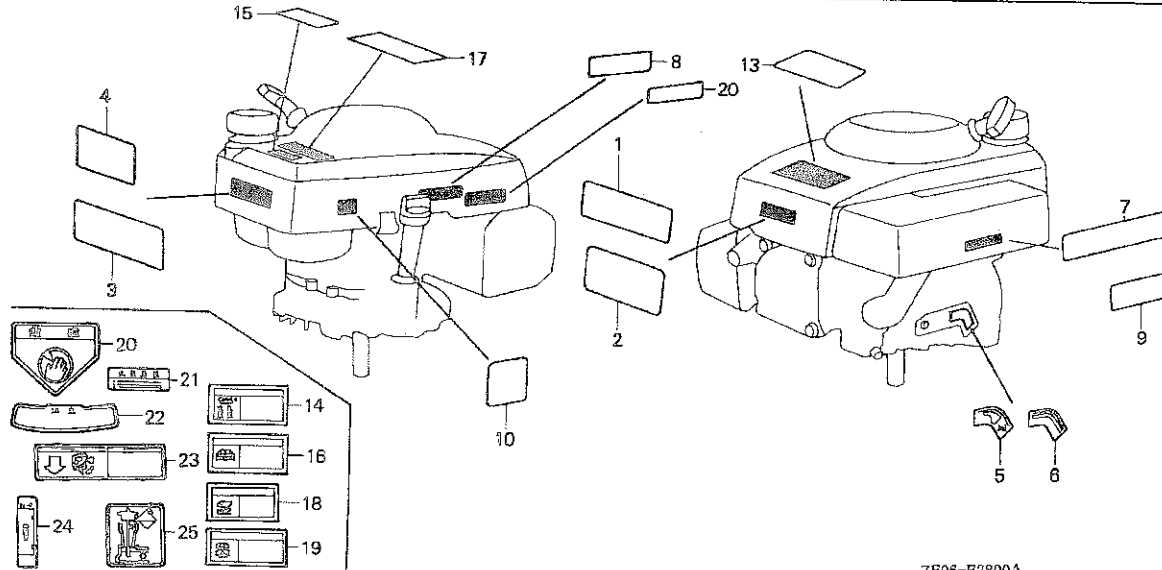

ZB06-EZ800A

Service item F.R.T.
NOT INFORMATION

Ref. No.	Part No.	Description	Reqd. QTY		Serial No.	Parts catalogue code
			GXV 120 (JPN)	GXV 120 (USA)		
1	87101-ZE6-U50	MARK, TOP COVER	1	-	-----	N1B
2	87101-ZE6-000	MARK, TOP COVER	1	-	-----	A1,A1L,A1LA,A1L2,A12,A14,D1,D12,NZTA,N1,N12,N14,N2,N2F,N2T,N22,N24 PFCA,SFL,SFL1,SFSK
3	87105-ZE6-000	MARK, CAUTION	1	1	-----	A1,A1L,A1LA,A1L2,A12,D1,D12,NZTA,N1,N1B,N12,N2,N2F,N2T,N22,SFSK
	87105-ZE6-T50	MARK, CAUTION (U.S.A.)	1	-	2494013	PFCA,SFL
4	87522-ZH8-W40	MARK, CAUTION	1	1	-----	A14,N14,N24,SFLY,SFL1
5	87523-ZE6-W40	MARK, CONTROL	1	-	2494014	PFCA,SFL
6	87523-ZE6-000	MARK, CONTROL	1	-	-----	N14,N24
7	87524-ZE6-000	MARK, AIR CLEANER CAUTION ...	1	1	-----	A1,A1L,A1LA,A1L2,A12,D1,D12,NZTA,N1,N1B,N12,N2,N2F,N22
			1	-	-----	SFSK
			1	-	2494013	PFCA,SFL
	87592-ZE6-W40	MARK, FUEL COCK	1	-	-----	SFL1
	87524-VA4-A90	MARK, AIR CLEANER CAUTION ...	1	-	2494014	PFCA,SFL
8	87525-ZE6-000	MARK, BRAKE CAUTION	1	1	-----	N2SS,SFFK,SFKR
	87526-ZH8-000	MARK B, COMBINATION	1	-	-----	A1,A1#,A1L,A1LA,A1L2,A12,N2C1
			1	-	-----	N2SS,SFFK
9	87592-ZE6-W40	MARK, FUEL COCK	1	-	2506690	SFKR
10	87594-VA4-010	MARK, OIL CAUTION	1	-	-----	A14,N14,N24,SFLY
			1	-	-----	N2SS
			1	-	2460953	A1,A1L,D1,N1,N1B,N2,N2F,N2T,SFL,SFSK
			-	1		

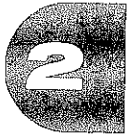

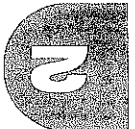

E-28

LABELS

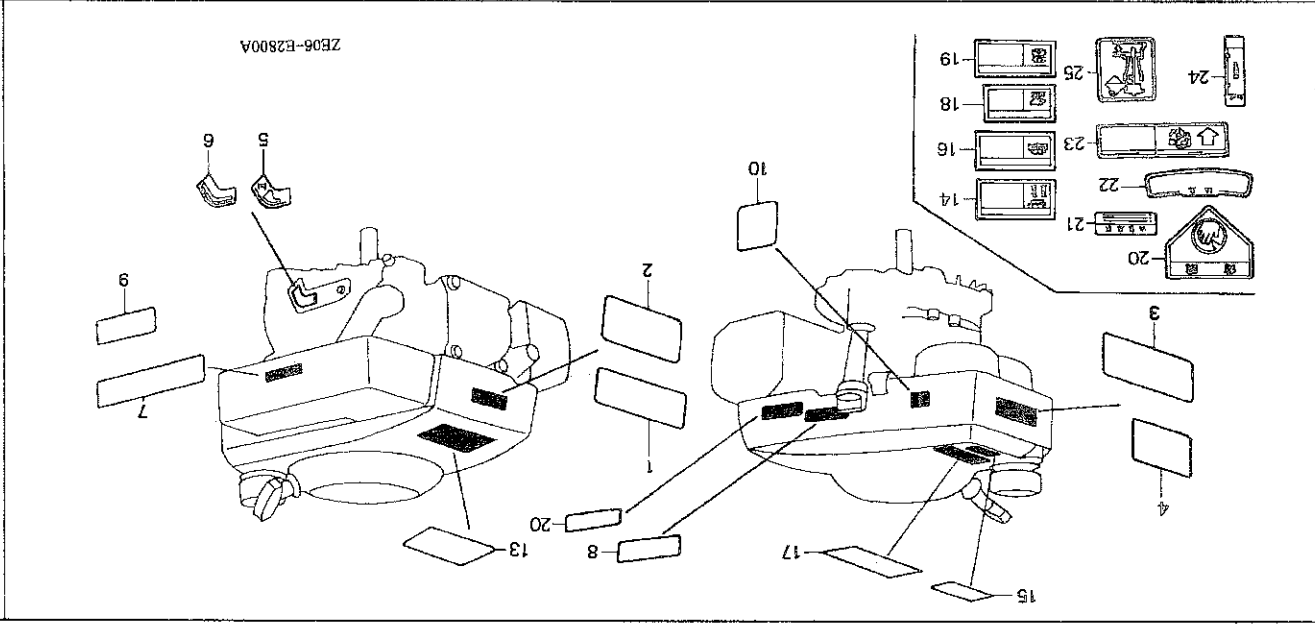

Ref. No.	Part No.	Description	Reqd. QTY	Serial No.	Parts catalogue code
13	87101-ZE6-000	MARK, TOP COVER	1		NZSS,PFTH,SFLY
14	87106-737-J00	MARK, FUEL WARNING	1		PFTH
15	87593-737-J00	MARK, USE FUEL	1	2506235	SFTH
			1		NZSS
			1		SFTH
			1		PFTH
			1		NZSS,SFFK
17	87520-ZH8-000	MARK A, COMBINATION	1	2506235	SFTH
			1		PFTH
18	87539-737-J00	MARK, HEAT CAUTION	1	2506690	SFKR
			1		PFTH
19	87561-733-J00	MARK, EX. GAS WARNING	1	2506235	PFTH
			1		SFTH
20	87103-952-661	LABEL B, HOUSING CAUTION	1	2506235	SFTH
			3		PFTH,SFTH
			1	2551343	A1L,A14,D1,NZTA,M1,N2,N2C1,NZSS,PFTH,SFL,SFLY,SFL1
21	87106-960-660	MARK, FUEL CAUTION	1		PFTH,SFTH
22	87509-952-660	LABEL, PLUG CAUTION	1		PFTH,SFTH
23	87524-VA4-900	MARK, AIR CLEANER CAUTION	1		PFTH,SFTH
24	87532-VA8-000	MARK, THROTTLE	1		SFKR,SFKR
25	87594-VA4-010	MARK, OIL CAUTION	1		PFTH,SFTH

Parts catalogue code

Reqd. QTY
GXV
GXV
120
(JPN)
120
(USA)

NZSS,PFTH,SFLY

PFTH

SFTH

NZSS,SFFK

SFKR

PFTH

SFTH

PFTH

NZSS,SFFK

SFKR

PFTH

SFTH

PFTH

SFTH

PFTH,SFTH

PFTH,SFTH

PFTH,SFTH

PFTH,SFTH

PFTH,SFTH

PFTH,SFTH

PFTH,SFTH

PFTH,SFTH

PFTH,SFTH

PFTH,SFTH

PFTH,SFTH

E-40

DRIVE SPROCKET

E 5

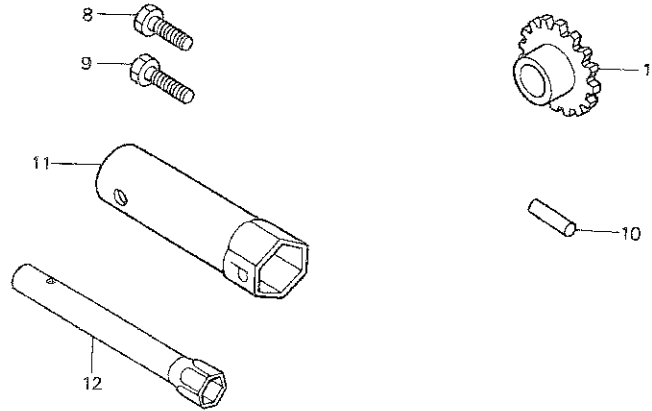

ZE60-B4000A

Service item F.R.T.
NOT INFORMATION

Ref. No.	Part No.	Description	Reqd. QTY		Serial No.	Parts catalogue code
			GXV 120 (JPN)	GXV 120 (USA)		
1	23711-VA6-003	SPROCKET, DRIVE	1	-	----- SFFK,SFKR	
8	90003-ZE1-000	BOLT, HEX., 5/16"	4	-	----- PFTH,SFTH	
9	90003-ZE3-600	BOLT, HEX., 3/8-24UNF (25MM)	1	-	----- PFTH,SFTH	
10	96220-40178	ROLLER, 4x17.8	1	-	----- SFFK,SFKR	
11	99004-21001	WRENCH, BOX (P21)	1	-	----- PFTH,SFTH	
12	99004-21002	WRENCH, BOX (P21)	1	-	----- A1,A1L,A1LA,A1L2,A12,A14,D1,D12,SFLY,SFL1	
			-	1		



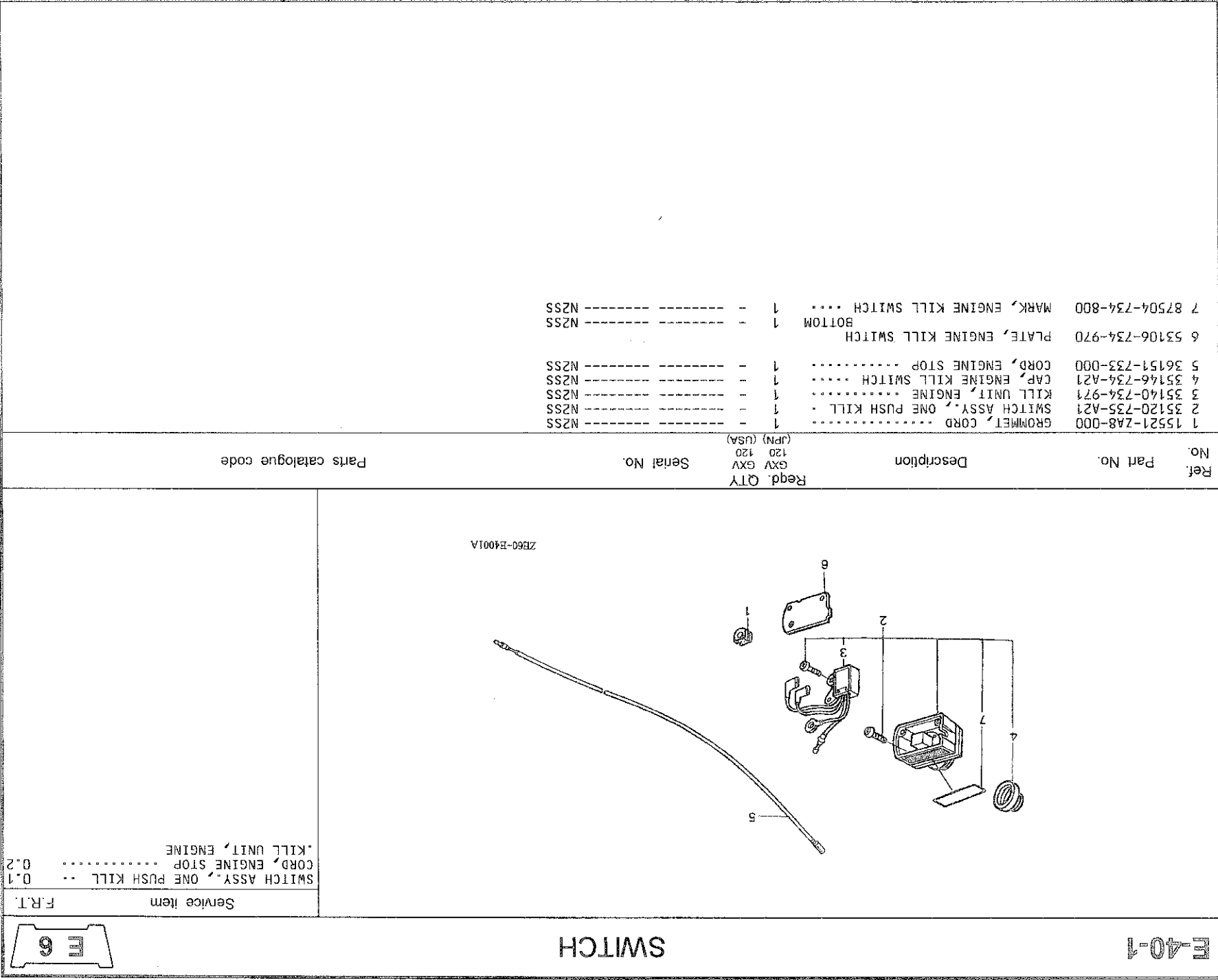

Ref. No.	Part No.	Description	Reqd. QTY	Serial No.	Parts catalogue code
	1	GROMMET, CORD	1		NZSS
	2	SWITCH ASSY, ONE PUSH KILL	1		NZSS
	3	KILL UNIT, ENGINE	1		NZSS
	4	CAP, ENGINE KILL SWITCH	1		NZSS
	5	CORD, ENGINE STOP	1		NZSS
	6	PLATE, ENGINE KILL SWITCH	1		NZSS
	7	MARK, ENGINE KILL SWITCH	1		NZSS
	8	BOTTOM	1		NZSS

Service Item F.R.T.
SWITCH ASSY, ONE PUSH KILL .. 0.1
CORD, ENGINE STOP 0.2
. KILL UNIT, ENGINE



SWITCH

E-40-1

E-40-2

BRAKE

E7

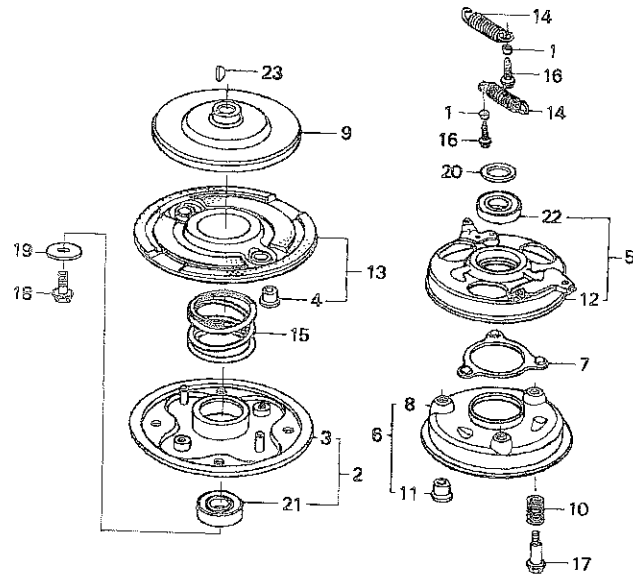

ZE60-E4002

Service item	F.R.T.
BEARING, RADIAL BALL, 6204 ...	0.4
.DISK COMP., DRIVEN	
.DISK, BRAKE	
.DISK, DRIVE	
.HOLDER COMP., BLADE	
PLATE ASSY., BALL CONTROL	0.5
.RETAINER COMP., BALL	
BEARING, RADIAL BALL, 60/22 ..	0.6
.PLATE COMP., BALL CONTROL	

Ref. No.	Part No.	Description	Reqd. QTY		Serial No.	Parts catalogue code
			GXV 120 (JPN)	GXV 120 (USA)		
1	19512-883-000	COLLAR, FAN	2	-	-----	SFLY,SFL1
2	72600-VA4-010	HOLDER ASSY., BLADE	1	-	-----	SFLY,SFL1
3	72610-VA4-000	HOLDER COMP., BLADE	1	-	-----	SFLY,SFL1
4	72613-VA4-000	BUSH, BLADE HOLDER	2	-	-----	SFLY,SFL1
5	75090-VA4-030	PLATE ASSY., BALL CONTROL ...	1	-	-----	SFLY,SFL1
6	75100-VA4-010	BRAKE COMP.	1	-	-----	SFLY,SFL1
7	75110-VA4-000	RETAINER COMP., BALL	1	-	-----	SFLY,SFL1
8	75120-VA4-010	DISK, BRAKE	1	-	-----	SFLY,SFL1
			1	-	-----	SFL1
9	75130-VA4-000	DISK, DRIVE	1	-	-----	SFLY
10	75132-VA4-000	SPRING, BRAKE HOLDER	3	-	-----	SFLY,SFL1
			3	-	-----	SFLY,SFL1
11	75133-VA4-000	BUSH, BRAKE HOLDER	3	-	-----	SFLY,SFL1
12	75140-VA4-020	PLATE COMP., BALL CONTROL ...	1	-	-----	SFLY,SFL1
13	75150-VA3-J01	DISK COMP., DRIVEN	1	-	-----	SFLY,SFL1
14	75182-VA3-J00	SPRING, CLUTCH RETURN (53.0MM)	2	-	-----	SFLY,SFL1
			2	-	-----	SFL1
15	75183-VA3-J00	SPRING, CLUTCH (36.6MM)	2	-	-----	SFLY
			1	-	-----	SFLY,SFL1
16	90014-952-000	BOLT, FLANGE, 6X14(CT200) ...	4	-	-----	SFLY,SFL1
17	90021-VA4-000	BOLT, SPECIAL, 6MM	3	-	-----	SFLY,SFL1
18	90105-960-003	BOLT, HEX., 10X25	1	-	-----	SFLY,SFL1
19	90409-952-000	WASHER, 10MM	1	-	-----	SFLY,SFL1
20	90501-952-010	WASHER, THRUST	1	-	-----	SFLY,SFL1
21	91102-VA4-013	BEARING, RADIAL BALL, 6204 ..	1	-	-----	SFLY,SFL1
22	91103-VA4-003	BEARING, RADIAL BALL, 60/22 ..	1	-	-----	SFLY,SFL1
23	94401-16150	KEY, WOODRUFF, 16X15	1	-	-----	SFLY,SFL1





E-40-3

THROTTLE LEVER

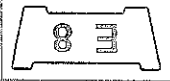

Service item F.R.T.

LEVER, THROTTLE 0.1
(INC. RELATIVE PART)

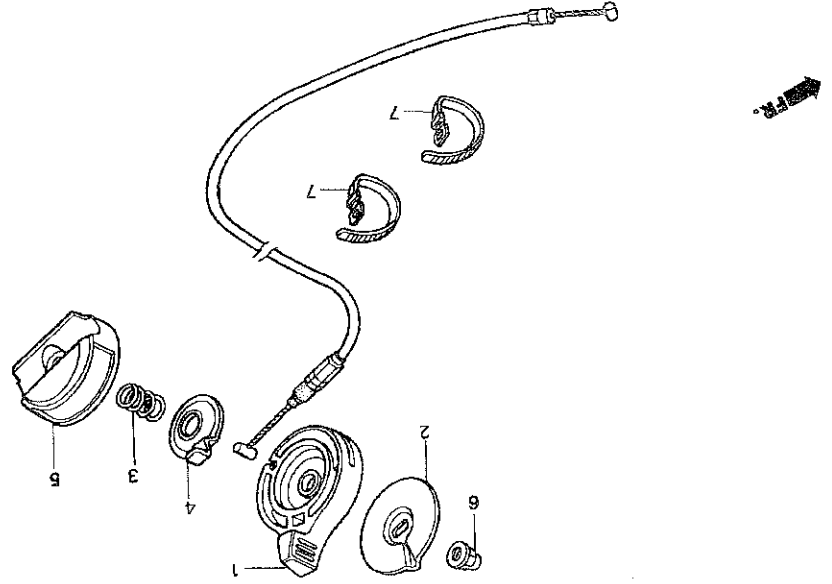

ZB60-E4003

Ref. No.	Part No.	Description	Reqd. QTY	Serial No.	Parts catalogue code
					(JPN) (USA)

1	17851-VA4-000	LEVER, THROTTLE	1		NZTA,SFFK,SFKR
2	17857-VA4-000	PLATE, THROTTLE LEVER	1		NZTA,SFFK,SFKR
3	17858-VA4-000	SPRING, THROTTLE LEVER	1		NZTA,SFFK,SFKR
4	17859-VA4-000	SEAT, SPRING	1		NZTA,SFFK,SFKR
5	54231-VA4-000	COVER, CONTROL	1		NZTA
	54231-VB5-800	1		SFFK,SFKR
6	90201-415-000	NUT, CAP, 6MM	1		NZTA
	94050-06000	NUT, FLANGE, 6MM	1		SFFK,SFKR
7	32161-404-000	BAND B1, WIRE	2		NZTA

E-40-4

TRANSMISSION CASE

E 9

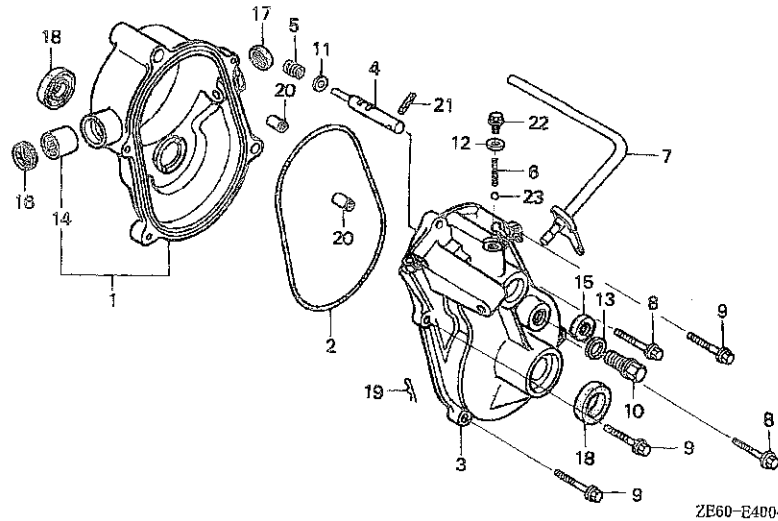

Service item	F.R.T.
SLIDER, SHIFT	0.5
O-RING, MISSION CASE	0.7
CASE COMP., R. MISSION	0.8
CASE, L. MISSION	
OIL SEAL, 15X24X5	

Ref. No.	Part No.	Description	Reqd. QTY		Serial No.	Parts catalogue code
			Gxv 120 (JPN)	Gxv 120 (USA)		
1	21510-VB3-800	CASE COMP., R. MISSION	1	-	-	-
2	21592-VA3-801	O-RING, MISSION CASE	1	-	-	SFKR
3	21611-VB3-800	CASE, L. MISSION	1	-	-	SFKR
4	24122-VB3-800	SLIDER, SHIFT	1	-	-	SFKR
5	24124-VA4-800	SPRING, HIGH GEAR SHIFT	1	-	-	SFKR
6	24271-VB3-800	SPRING, BALL SETTING	1	-	-	SFKR
7	54311-VA8-000	LEVER COMP., CHANGE	1	-	-	SFKR
8	90123-VA4-800	BOLT, FLANGE, 6X28	2	-	-	SFKR
9	90125-VA4-800	BOLT, FLANGE, 6X25	3	-	-	SFKR
10	90131-ZE1-000	BOLT, DRAIN PLUG	1	-	-	SFKR
11	90451-KA3-740	WASHER, 5.2X10	1	-	-	SFKR
12	90461-357-000	WASHER, SEALING, 6.5X12	1	-	-	SFKR
13	90601-ZE1-000	WASHER, DRAIN PLUG, 10.2MM	1	-	-	SFKR
14	91012-VB5-801	BEARING, NEEDLE, 10X17X20	1	-	-	SFKR
15	91201-VA4-801	OIL SEAL, 10X20X5	1	-	-	SFKR
16	91202-KA3-711	OIL SEAL, 10X17X4(ARA1)	1	-	-	SFKR
17	91203-952-771	OIL SEAL, 8X14X5	1	-	-	SFKR
18	91205-VA4-801	OIL SEAL, 15X24X5	2	-	-	SFKR
19	94251-08000	PIN, LOCK, 8MM	1	-	-	SFKR
20	94301-08140	DOWEL PIN, 8X14	2	-	-	SFKR
21	94305-40202	PIN, SPRING, 4X20	1	-	-	SFKR
22	95701-06010-00	BOLT, FLANGE, 6X10	1	-	-	SFKR
23	96211-06000	BALL, STEEL, #6 (3/16)	1	-	-	SFKR



PART NO. INDEX

F 3

Part Number	Address	Page	Ref.	Part Number	Address	Page	Ref.	Part Number	Address	Page	Ref.	Part Number	Address	Page	Ref.	
91205-VA4-801	E9	55	18	95000				99101-ZH7-0520	D5	35	21					
91231-891-003	C7	21	43					99101-ZH7-0550	D5	35	21					
91252-888-003	C7	21	44		95002-02080	D10	40	14	99101-ZH7-0580	D5	35	21				
91301-805-000	C7	21	45		95002-02120	D7	37	15	99101-ZH8-0520	D5	35	21				
91301-ZE6-003	D14	44	25		95002-70000	D7	37	13	99101-ZH8-0550	D5	35	21				
91301-ZE9-003	C7	21	46			D10	40	15	99101-ZH8-0580	D5	35	21				
91305-679-003	C7	21	46		95005-80180-30	D6	36	2	99101-ZH8-0580	D5	35	21				
91401-ZE6-013	D15	45	26			D7	37	17	99204-ZE0-0350	D5	35	22				
91402-ZE6-003	D15	45	27		95700-06010-00	D1	31	11	99204-ZE2-0380	D5	35	22				
91403-ZE6-003	D15	45	28			E2	48	25								
91406-VA3-900	C7	21	47		95700-06012-08	C7	21	51								
91504-750-003	D13	43	22			D1	31	12								
91601-ZE6-003	D15	45	29		95700-06035-00	D7	37	18								
91602-ZE6-710	D9	39	12		95700-08045-00	C3	17	14								
91602-ZE6-711	D9	39	12		95700-08050-00	C3	17	14								
					95701-06008-00	C15	29	12								
92000					95701-06010-00	D1	31	11								
92000-06012-0H	C15	29	13			E2	48	25								
92000-06020-0A	E1	47	19		95701-06012-08	C7	21	51								
92101-05020-0A	E11	57	25			D1	31	12								
92101-06012-0H	C15	29	13		95701-06014-00	C2	16	10								
93000					95701-06020-00	C6	20	32								
93500-03006-1H	D5	35	20		95701-06022-00	D13	43	17								
93500-03008-0H	D5	35	20		95701-06028-00	C5	19	30								
93500-03008-1G	D5	35	20		95701-06035-00	D7	37	18								
93500-04008-0A	D13	43	23		95701-08045-00	C3	17	14								
	E1	47	20		95701-08050-00	D11	41	16								
93500-05010-0A	E1	47	21		95900-08050-00	D10	40	16								
93500-05016-0A	E1	47	21		96000											
93500-05020-0A	E1	47	22		96211-06000	E9	55	23								
	E2	48	27		96220-40178	E5	51	10								
93500-05025-0A	E1	47	23			E11	57	27								
	E2	48	27		96220-60224	E11	57	28								
93892-05016-08	D15	45	30		98000											
93892-05032-08	D15	45	31		98079-54841	C3	17	15								
94000				98079-54846	C3	17	15									
94001-05000-0S	E11	57	26	98079-54854	C3	17	15									
94050-06000	D7	37	14	98079-54855	C3	17	15									
	D9	39	13	98079-55841	C3	17	15									
	E2	48	24	98079-55846	C3	17	15									
	E8	54	6	98079-55854	C3	17	15									
94101-06800	C7	21	48	98079-55855	C3	17	15									
94102-12800	D13	43	24	98079-56841	C3	17	15									
94251-08000	C7	21	49	98079-56846	C3	17	15									
	E9	55	19	98079-56854	C3	17	15									
94301-08140	C7	21	50	98079-56855	C3	17	15									
	D13	43	25													
	E9	55	20	99000												
94301-10160	C3	17	13	99004-21001	E5	51	11									
94305-40202	E9	55	21	99004-21002	E5	51	12									
94401-16150	C10	24	9	99101-124-0600	D5	35	21									
	E7	53	23	99101-124-0620	D5	35	21									
				99101-124-0650	D5	35	21									

3

PART NAME INDEX

Part name	Address	Page Ref.	Part name	Address	Page Ref.	Part name	Address	Page Ref.
ARM COMP., GOVERNOR	D16	46	BOLT, FLANGE, 8X50	D11	41	ARM COMP., GOVERNOR	D16	46
ARM, CLUTCH	E10	56	BOLT, GOVERNOR ARM	E2	48	ARM, VALVE ROCKER	C11	25
ARM, VALVE ROCKER	C11	25	BOLT, HEX., 5/16"	E5	8	ARRESTER KIT, SPARK	D8	38
BAND B1, WIRE	E8	54	BOLT, HEX., 5/8-24UNF	E7	18	ARRESTER, SPARK	D8	38
BAL, STEEL	E9	55	BOLT, HEX., 10X25	E2	29			
			BOLT, GOVERNOR ARM	E2	29			
			BOLT, 8MM	C13	14			
			BOLT, PIVOT	C13	27			
			BOLT, SETTING	D14	44			
			BOLT, SPECIAL, 6MM	E7	53			
			BOLT, STUD, 6X109	C2	16			
			BOLT, STUD, 6X112	C2	11			
			BOLT, STUD, 6X81	D9	39			
			BOLT, STUD, 6X82	D9	39			
			BOLT, STUD, 6X85	D9	39			
			BOLT, STUD, 6X90	D9	39			
			BOLT, STUD, 6X93	D9	39			
			BOLT, STUD, 6X97	C2	16			
			BOOT, JOINT	E10	56			
			BRACKET, FR.	D14	44			
			BRAKE COMP.	D13	43			
			BRUSH SET	D14	44			
			BUSH, BLADE HOLDER	E7	53			
			BUSH, BRAKE HOLDER	E7	53			
			CAM SHAFT ASSY.	C11	25			
			CAM COMP., BRAKE	D12	42			
			CAM COMP., FUEL TANK	D10	40			
			CAP ASSY., NOISE SUPPRESSOR	C16	30			
			CAP ASSY., FUEL TANK	D10	40			
			CAP, ENGINE KILL SWITCH	C4	18			
			CAP COMP., BREATHER CHAMBER	C4	18			
			CAP, OIL FILLER	C5	19			
			CARBURETOR ASSY.	D3	33			
			CASE COMP., AIR CLEANER	D6	36			
			CASE COMP., RECIL STARTER	C14	28			
			CASE COMP., R. MISSION	E9	55			
			CASE L. MISSION	E9	55			
			CHAMBER SET, FLOAT	D2	32			
			CHOKE SET	D3	33			
			CIRCLIP, 7.1MM	D14	44			
			CLAMP, CORD	D1	31			
			CLIP B, CABLE	D10	40			
			CLIP, CLUTCH SHAFT	E10	56			
			CLIP, GOVERNOR HOLDER	C6	20			
			CLIP, PISTON PIN, 13MM	C10	24			
			CLIP, TUBE	D7	37			
			COIL ASSY., CHARGE	D12	42			
			COIL ASSY., IGNITION	C16	47			
			COLLAR B, AIR CLEANER	D6	36			
			COLLAR, EXTENSION	C5	19			
			COLLAR, FAN	E7	53			
			COLLAR, FINAL GEAR	E10	56			
			COLLAR, ROTO-STOP	D1	31			
			COLLAR, STOPPER	E1	47			
			CONTROL COMP.	D10	40			
			CORD, ENGINE STOP	E6	52			
			COUNTERSHAFT	E10	56			
			COVER COMP., FAN	D16	44			
			COVER COMP., GEAR	C16	44			
			COVER, AIR CLEANER	D6	36			
			COVER, CONTROL	E8	54			
			COVER, HEAD	C1	15			
			COVER, MUFFLER PROTECTOR	D8	38			
			COVER, SPRING	D14	44			
			CRANKSHAFT COMP.	C10	24			
			DISK COMP., DRIVEN	E7	53			
			DISK, BRAKE	E7	53			
			DISK, DRIVE	E7	53			
			DISK, DRIVE, 10X16	C3	17			
			DOMEL PIN, 8X14	C7	21			
			DOMEL PIN, 10X14	D13	43			
			DOMEL PIN, 8X9	D13	43			
			ELEMENT, AIR CLEANER	D6	36			
			E-RING, 10MM	D13	43			
			EXTENSION, OIL FILLER	C5	19			
			FAN, COOLING	D12	42			
			FILTER, BREATHER	C5	19			
			FILTER, OUTER	D6	36			
			FLOAT SET	D2	32			
			FLYWHEEL COMP.	D12	42			

2001.12.01 E

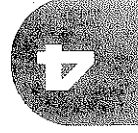

PART NAME INDEX

G 2

Part name	Address	Page	Ref.	Part name	Address	Page	Ref.	Part name	Address	Page	Ref.
[G]											
GASKET	D15	45	26	LABEL, FUEL CAUTION	E4	50	15	OIL SEAL, 15X24X5	E9	55	18
GASKET KIT	E12	58	1	LABEL, PLUG CAUTION	E4	50	22	OIL SEAL, 22X35X6	C7	21	41
GASKET SET	D2	32	1	LEVER COMP., CHANGE	E9	55	7	OIL SEAL, 25X38X7	C7	21	44
GASKET, CYLINDER HEAD	C1	15	6	LEVER, COCK	D4	34	16	OIL SEAL, 6X11X4	C7	21	43
GASKET, MUFFLER	D9	39	7	LEVER, THROTTLE	E8	54	1	OIL SEAL, 8X14X5	E9	55	17
			8	LIFTER, VALVE	C11	25	4	O-RING	D14	44	25
			9	[M]				O-RING, 22.1X2	C7	21	46
GAUGE COMP., OIL LEVEL	C5	19	14	MARK A, COMBINATION	E4	50	17	O-RING, 22.5X2.2	C7	21	46
GEAR COMP., FINAL	E10	56	10	MARK B, COMBINATION	E3	49	8	O-RING, 26X2.7	C7	21	45
GEAR, BEVEL	E10	56	13	MARK, AIR CLEANER CAUTION	E3	49	7	O-RING, MISSION CASE	E9	55	2
GEAR, DRIVEN	C5	19	27					[P]			
GEAR, HIGH DRIVE	E10	56	6	MARK, BRAKE CAUTION	E4	50	23	PACKING	D15	45	29
GEAR, LOW DRIVE	E10	56	7	MARK, CAUTION	E3	49	8	PACKING, BREATHER CHAMBER	C5	19	11
GEAR, PINION	D14	44	6					PACKING, FUEL CAP	D10	40	10
GOVERNOR ASSY.	C5	19	17	MARK, CONTROL	E4	50	16	PACKING, FUEL COCK	D4	34	19
GRIP, STARTER	C15	29	10					PACKING, HEAD COVER	D5	35	19
GROMMET	D14	44	2	MARK, ENGINE KILL SWITCH	E6	52	7	PACKING, INSULATOR	C2	16	8
GROMMET, CORD	E6	52	1	MARK, EX. GAS WARNING	E4	50	19	PACKING, OIL FILLER CAP	D4	34	14
GROMMET, HIGH TENSION CORD	C16	30	3	MARK, FUEL CAUTION	E4	50	21	PACKING, OIL PAN	C5	19	15
GUIDE, EX. VALVE	C1	15	3	MARK, FUEL COCK	E3	49	7	PACKING, PROTECTOR	D9	39	12
			4	MARK, FUEL WARNING	E4	50	14	PAN ASSY., OIL	C4	18	2
GUIDE, IN. VALVE	C1	15	2	MARK, HEAT CAUTION	E4	50	18				
				MARK, OIL CAUTION	E3	49	10	PAN COMP., OIL	C4	18	4
[H]				MARK, THROTTLE	E4	50	24	PIECE A, STOPPER	D14	44	10
HEAD COMP., CYLINDER	C1	15	1	MARK, TOP COVER	E3	49	1	PIECE B, STOPPER	D14	44	11
HOLDER ASSY., BLADE	E7	53	2					PINION, BEVEL	E10	56	12
HOLDER COMP., BLADE	E7	53	3	MARK, USE FUEL	E4	50	13	PIN, GOVERNOR WEIGHT	C5	19	20
HOLDER, BRUSH	D14	44	15	MOTOR UNIT, STARTER	D14	44	3	PIN, LOCK, 2.0	C6	20	39
HOLDER, CABLE	E1	47	11	MUFFLER COMP.	D8	38	2	PIN, LOCK, 8MM	C7	21	49
HOLDER, GOVERNOR WEIGHT	C5	19	19						E9	55	19
				[N]				PIN, PISTON	C9	23	3
[I]				NOZZLE, MAIN	D3	33	12	PIN, SPRING, 4X20	E9	55	21
INSULATOR, CARBURETOR	D3	33	13	NUT, AIR CLEANER COVER	D7	37	11	PIPE, OIL DEFENSE	C5	19	12
				NUT, CAP, 6MM	E8	54	6	PISTON	C9	23	2
[J]				NUT, FLANGE, 6MM	D7	37	14	PIVOT, ROCKER ARM	C11	25	5
JET SET, PILOT,	D5	35	22					PLATE ASSY., BALL CONTROL	E7	53	5
JET, MAIN,	D5	35	21	NUT, HEX., 5MM	E11	57	26	PLATE COMP., BALL CONTROL	E7	53	12
JOINT ASSY.	E10	56	1	NUT, PIVOT ADJUSTING	C13	27	15	PLATE, ENGINE KILL SWITCH			
JOINT SUB ASSY.	E10	56	4	NUT, SELF-LOCK, 6MM	D9	39	13	PLATE, FRICTION	E6	52	6
			5	NUT, SPECIAL, 14MM	D13	43	18	PLATE, GOVERNOR SHAFT HOLDER	C14	28	5
JOINT, TUBE	D6	36	1	NUT, TOOL BOX SETTING	D7	37	12	PLATE, GUIDE	C5	19	22
				NUT, WING, 6MM	D7	37	11	PLATE, LEVER SETTING	D4	34	17
[K]				[O]				PLATE, PUSH ROD GUIDE	C13	27	13
KEY, SPECIAL WOODRUFF, 25X18	D12	42	1	OIL SEAL	D14	44	24	PLATE, THROTTLE LEVER	E8	54	2
KEY, WOODRUFF, 16X15	C10	24	9	OIL SEAL, 10X17X4	E9	55	16	PLUG, SPARK	C3	17	15
				OIL SEAL, 10X20X5	E9	55	15	PROTECTOR, CONTROL	E1	47	14
KILL UNIT, ENGINE	E7	53	23	OIL SEAL, 12X20X5	C7	21	42	PROTECTOR, MUFFLER	D8	38	4
KNOB, RECOIL STARTER	C15	29	9					PULLEY COMP., STARTER	D12	42	3
				[R]				PULLEY, RECOIL STARTER	C14	28	3
[L]								RATCHET, STARTER	C14	28	4
LABEL	E4	50	20								
LABEL B, HOUSING CAUTION	E4	50	20								

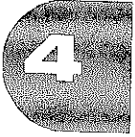

FOREWORD INDEX

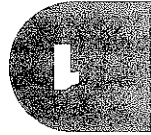

ENGINE GROUP

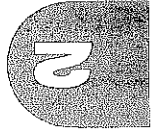

PART NUMBER INDEX

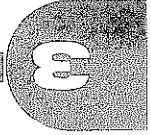

PART NAME INDEX

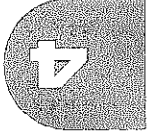

HONDA
The Power of Dreams